

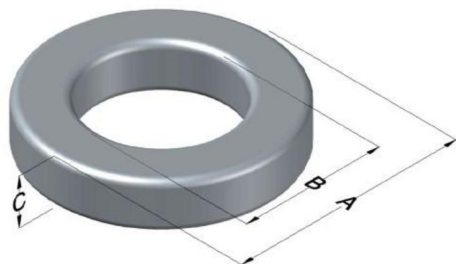

0059586A2

110 Delta Drive
 Pittsburgh, PA 15238
 NAFTA Sales: (1)800-245-3984
 HK Sales : (852)3102-9337
 magnetics@spang.com
 www.mag-inc.com



Edge Permeability (μ)	A_L (nH/T ²)	Core Marking			Coating Color
		Lot Number	Part Number	Inductance Grade	
60	38 \pm 8%	XXXXXX	59586A2	N/A	Green

Dimensions					Packaging	
	Uncoated		Coated Limits			Cardboard cut-outs Box Qty = 300 Pcs
	(mm)	(in)	(mm)	(in)		
OD (A)	34.29	1.350	35.18	1.385	max	
ID (B)	23.37	0.920	22.56	0.888	min	
HT (C)	8.89	0.350	9.78	0.385	max	

Electrical Characteristics			Physical Characteristics						
Watt Loss @ 100kHz, 100mT (max, mW/cm ³)	DC Bias min (Oersteds)		Voltage Breakdown wire-to-wire min (V _{AC})	Break Strength (min, kg)	Window Area, W _A (mm ²)	Cross Section, A _e (mm ²)	Path Length, L _e (mm)	Volume V _e (mm ³)	Weight (g)
	80%	50%							
525	100	180	3000	53.5	399	46.4	89.5	4150	33.4

Winding Information					Temperature Rating	
Winding Length per Turn			Wound Coil Dimensions (mm)		Curie Temp (°C):	500 °C
Winding Factor	(mm)	Winding Factor	(mm)	40% Winding Factor	OD	40.5
					0%	32.2
20%	38.1	45%	45.6	Completely Full Window	Max OD	50.1
25%	39.6	50%	47.3		Max HT	29.0
30%	40.6	60%	50.8	Surface Area (mm ²)		Notes:
35%	42.5	70%	54.9	Unwound Core:	2900	
				40% Wound:	5500	

