

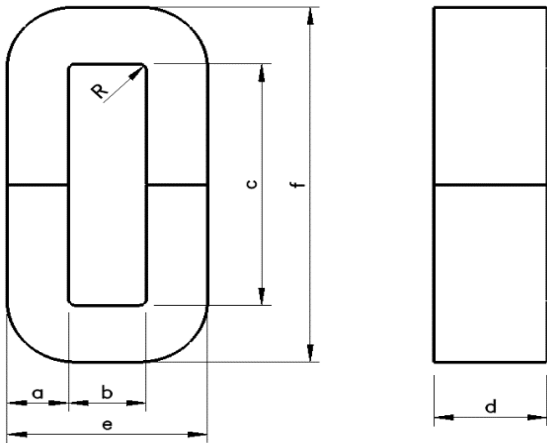

**MACC0063**

110 Delta Drive  
 Pittsburgh, PA 15238  
 NAFTA Sales: (1) 800-245-3984  
 HK Sales: (852) 3102-9337  
 magnetics@spang.com  
 www.mag-inc.com



	Dim (mm)	tol +/-
a	16.0	1.0
b	20.0	min
c	70.0	min
d	30.0	0.5
e	53.5	1.5
f	105.0	2.0
R	2.0	Ref

A <sub>e</sub> (cm <sup>2</sup> )	L <sub>e</sub> (cm)	Weight (g)	Wa(cm <sup>2</sup> )
4.4	23.2	710 Ref	16.2 ref

Material	Amorphous
Core Loss (@16kHz/37mT, 25° C +/- 3° C, Humidity 65% +/- 5%)	≤1.0 W/kg
Working Temperature	-40°C + 130°C
Storage Temperature	-40°C + 80°C