

# RI 4195

## 110/230 VAC

### FEEDTHRU FILTER

Panel mountable  
AC power  
feedthru filter



#### OVERVIEW

The RI 4195 is a feedthru filter for all types of applications where AC power needs to be fed through a shielded wall.

#### APPLICATION

Primarily designed to fit in Ranatec's RI 187 Shield Boxes but can be used separately.

#### ELECTRICAL INTERFACES

The physical connectors are located at each end.

#### MECHANICAL INTERFACES

The RI 4195 is prepared for panel mounting with two threaded M4 screw holes. It is delivered with an EMI/RFI shielding gasket for simple and reliable mounting.

#### FEATURES

- 110/230 VAC compatible
- 6 A max
- 70 dB filter suppression at 1.0-10 GHz
- Panel mountable

#### SPECIFICATION

Connector input:	C14 male
Connector output:	C13 female
Material:	Aluminium
Dimensions:	65x90x48 mm
Weight:	375 g
Operating voltage	110/230 VAC
Rated current	6 A
CE compliant	RoHS / safety

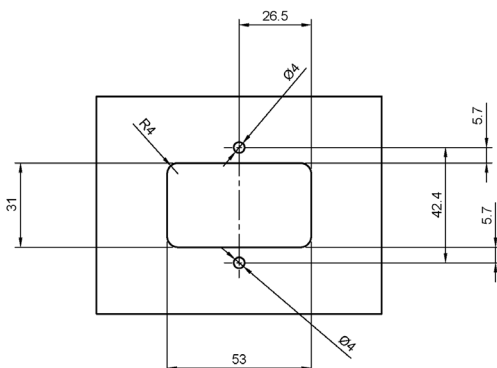

Panel cut-out recommendation (mm)

#### ORDERING

RI 4195 110/230 VAC Feedthru Filter