

PART NUMBER	REV	FIRST USED
567405-4	B	354500-1

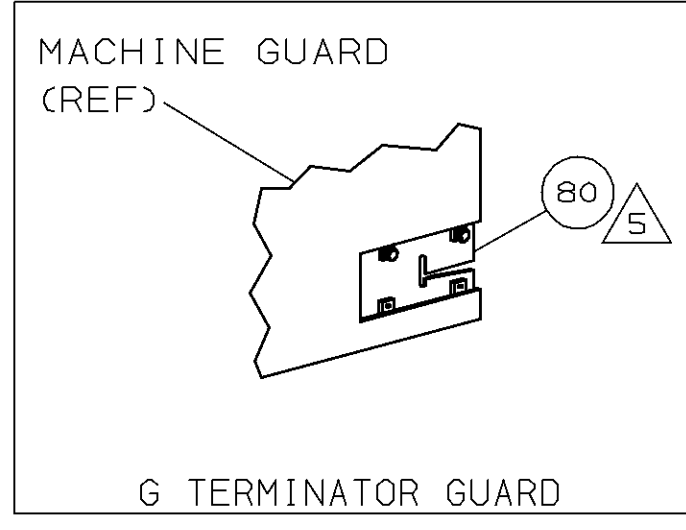
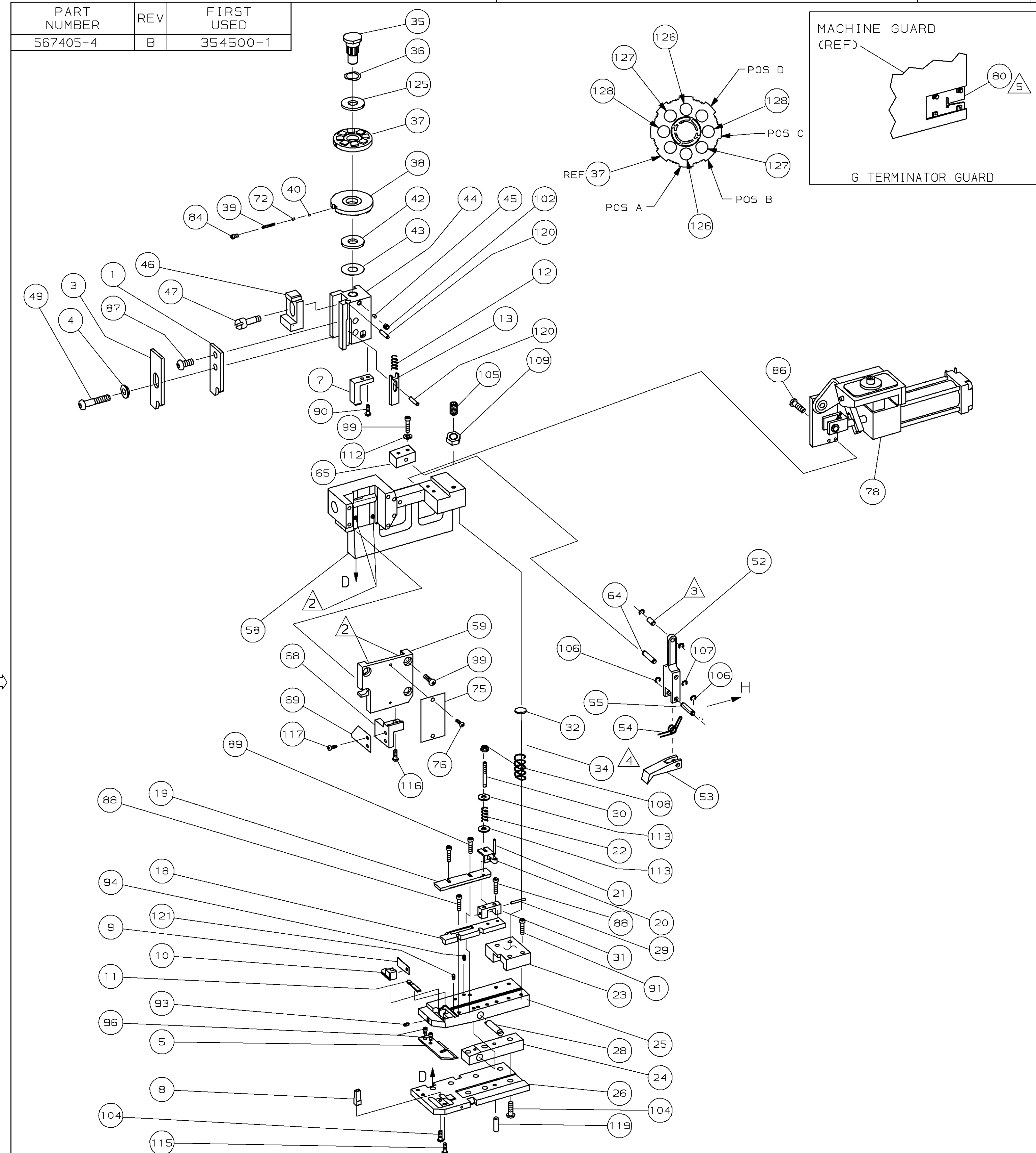

- 1 RECOMMENDED SPARE PARTS.
- 2 GREASE LIGHTLY.
- 3 LUBRICATE DAILY USING NO. 20 MACHINE OIL.
- 4 AFTER ASSEMBLY OF APPLICATOR, PROPER SPRING PRESSURE (ITEM 34) CAN BE OBTAINED BY TIGHTENING SET SCREW (ITEM 105) UNTIL CONTACT IS MADE WITH SPACER (ITEM 32) THEN TIGHTEN AN ADDITIONAL 5 1/2 - 6 REVOLUTIONS.
- 5 GUARD MUST BE IN PLACE WHEN OPERATING APPLICATOR IN A BENCH MACHINE.

TERMINAL NAME: .187 SERIES FLAG POS LOK-EX RECPT		CRIMPING DATA			
PAD LTR	CRIMP HEIGHT	WIRE SIZE			
A	.038 ±.002 [0.96 ±0.05mm]	16			
B	.035 ±.002 [0.89 ±0.05mm]	18			
C	.033 ±.002 [0.84 ±0.05mm]	20 OR 22			
D	NOT	USED			
CRIMP	SIZE	TYPE	RANGE		
WIRE	.140 [3.56mm]	TAB-LOCK	22-16		
INSUL	.140 [3.56mm]	0	.059-.170		
WIRE STRIP LENGTH	TERM APPL SPEC	FEED	APPL INSTRUCTION	SET UP GAGE	LAYOUT
-	-	.567	408-8031	-	L1809

QTY	REV	DESCRIPTION	ITEM NO
2	-	8-354779-0 PIN, WIRE DISC (.3390)C	129
2	-	7-354779-8 PIN, WIRE DISC (.3380)B	127
2	-	7-354779-4 PIN, WIRE DISC (.3360)A	126
1	-	986950-1 WASHER, FLAT PRECISION	125
1	-	1-21030-2 PIN, DOWEL (Ø.187X.62)	124
			123
			122
2	-	3-21028-2 PIN, SLOTTED SPRING (Ø.094X.25)	121
2	-	4-21028-9 PIN, SLOTTED SPRING (Ø.125X.38)	120
1	-	21029-5 PIN, SLOTTED SPRING (Ø.188X.75)	119
			118
2	-	1-21002-6 SCREW, SBHC (6-32 x .25) STOP	117
1	-	2-21000-6 SCREW, SHC (8-32 x .38) MTG	116
1	-	1-21000-4 SCREW, SHC (4-40 x .38) INSERT	115
			114
4	-	1-21899-3 WASHER, FLAT (8)	113
2	-	21024-5 WASHER, LOCK (#10)	112
			111
			110
1	-	1-22202-7 NUT, HEX (5/16-24)	109
2	-	21022-2 NUT, HEX (LOCKING) (8-32)	108
1	-	1-21986-2 RING, RET "E" Ø3/16	107
2	-	21045-3 RING, RET "C" Ø3/16	106
1	-	8-21007-5 SCREW, SKT SET (5/16-24x.75)	105
7	-	2-22733-8 SCREW, BHC (1/4-20X.63)	104
			103
1	-	21009-2 SCREW, SKT SET (1/4-20x.25)	102
			101
			100
6	-	3-21000-8 SCREW, SHC (10-32X.88)	99
			98
			97
2	-	7-21000-6 SCREW, SHC (10-32X.38)	96
			95
2	-	4-21006-0 SCREW, SKT SET (8-32X.25)	94
1	-	21061-9 SCREW, SKT SET (8-32X.25)	93
			92
4	-	2-21000-9 SCREW, SHC (8-32X.75)	91
2	-	1-23030-1 SCREW, SHC (NYLON) (8-32X.62)	90
2	-	2-21002-3 SCREW, BHC (8-32X.62)	89
2	-	2-21002-2 SCREW, BHC (8-32X.50)	88
1	-	2-21002-1 SCREW, BHC (8-32X.38)	87
2	-	21001-3 SCREW, SHC (1/4-20X.62)	86
			85
1	-	23030-1 SCREW, SHC (NYLON) (6-32X.25)	84
2	-	3-21012-1 SCREW, SKT SET 6-38X.38	83
			82
			81
REF	-	A 679532-1 INSERT, GUARD	80
			79
1	-	D 462622-2 AIR FEED ASSEMBLY	78
			77
2	-	A 21017-2 SCR, DRIVE (#2X.19) ID	76
1	-	B 461264-1 PLATE, IDENTIFICATION	75
			74
			73
1	-	A 690603-1 SPRING, ASSIST	72
			71

QTY	REV	DESCRIPTION	ITEM NO
-4		BENCH MODEL G	AIR FEED
1	-	B 318530-3 STOP, WIRE	70
1	-	B 318529-1 BLOCK, MOUNTING	69
			68
			67
			66
1	-	B 456987-1 BLOCK, PIVOT	65
1	-	A 457058-1 PIN, PIVOT	64
			63
			62
			61
			60
1	-	C 318528-1 CAP, RAM	59
1	-	D 457079-1 HOUSING	58
			57
			56
1	-	B 240624-1 PIN, FEED FINGER	55
1	-	B 691499-1 SPRING, FEED FINGER	54
1	-	B 454568-3 FINGER, FEED	53
1	-	B 457057-3 ARM, PIVOT	52
			51
			50
1	-	A 3-21002-5 BOLT, CRIMPER	49
			48
1	-	A 22353-8 SCREW, SHOULDER	47
1	-	A 690578-1 BLOCK, INSULATION ADJUST	46
1	-	A 690191-1 PLUG, NYLON	45
1	-	C 454574-1 RAM	44
1	-	A 690125-1 WASHER, LAMINATED	43
1	-	A 690124-4 WASHER, RAM	42
			41
1	-	A 23241-6 BALL, STEEL	40
1	-	A 690170-1 SPRING, COMPRESSION	39
1	-	C 690142-1 DISC, INSULATION	38
1	-	D 354777-1 WIRE DISC, PLASTIC	37
1	-	B 22480-5 WASHER, SPRING	36
1	-	B 690212-1 POST, RAM	35
1	-	A 3-23846-5 SPRING, HINGE BAR	34
			33
1	-	A 690573-1 SPACER, SPRING	32
2	-	A 454569-1 MOUNT, DRAG	31
2	-	A 1-22354-8 STUD, DRAG	30
1	-	A 21030-2 PIN, MOUNT DRAG	29
1	-	B 690582-1 PIN, HINGE	28
			27
			26
1	-	C 684905-1 PLATE, BASE	25
1	-	B 454579-2 HINGE BAR	24
1	-	B 690571-1 BLOCK, STABILIZER	23
1	-	C 690585-1 BLOCK, PRESSURE	22
1	-	A 8-22282-9 SPRING, DRAG	21
1	-	A 21030-6 LEVER, DRAG	20
1	-	A 454570-1 DRAG, STOCK	19
1	-	C 454573-1 GUIDE, STRIP (REAR)	18
1	-	C 318739-3 GUIDE, STRIP (FRONT)	17
			16
			15
			14
1	-	B 1-692134-6 POSITIONER, TERMINAL	13
1	-	A 5-22280-5 SPRING, TERM. POSITIONER	12
1	-	B 454712-1 PLATE, REAR SHEAR	11
1	-	B 454578-1 ANVIL INSERT	10
1	-	C 690569-3 PLATE, FRONT SHEAR	9
1	-	A 690718-1 ANVIL	8
1	-	B 454575-2 BLADE, SLUG	7
			6
1	-	B 684906-1 PLATE, ANVIL RETAINING	5
1	-	B 690574-1 SPACER, TUBULAR INSUL CRIMPER	4
1	-	C 690715-1 CRIMPER, INSULATION	3
			2
1	-	C 690716-3 CRIMPER, WIRE	1

QTY REQD PER ASSY	U/M	DWG SIZE	PART NO	DESCRIPTION	ITEM NO

QTY REQD PER ASSY	U/M	DWG SIZE	PART NO	DESCRIPTION	ITEM NO

LOC A  
DIST 66

DIMENSIONS IN INCHES. DO NOT SCALE PRINT. TOLERANCES UNLESS OTHERWISE SPECIFIED.		MATERIAL		FINISH	
DR	8-21-96	APP	8-21-96		
P. MATHIAS		J. DODDS			
2 PLC DEC ±					
3 PLC DEC ±					
4 PLC DEC ±					
ANGLES ±					
SURF TEXTURE: ✓					
REMOVE BURRS, BREAK SHARP EDGES R.015 MAX					
NAME: END FEED HINGE BAR APPLICATOR		MACHINE REF: MINI APPL		SHEET: 1 OF 1	
SCALE: -		DWG NO: 567405-4		REV: B	