

Grounding Board Locks not shown in side views

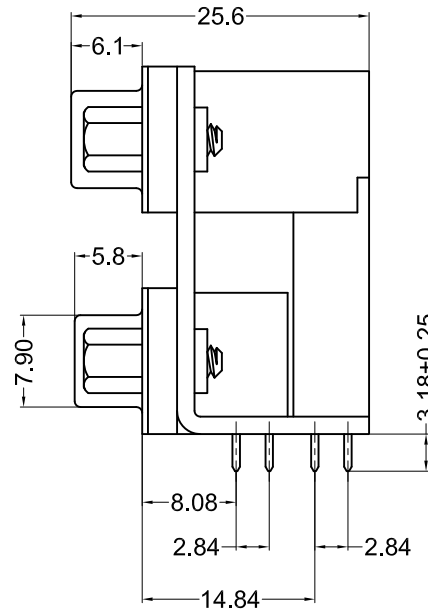

Material and Finish

Shell: Steel, Nickel plated

Insulator: PBT thermoplastic with glass-fiber reinforcement, UL94V-0 rated
Color: Black

Contact Material:
Plug - Brass

Socket - Phosphor Bronze

Contact Plating Options:

Standard: gold flash on mating end, tin on termination end, nickel underplate on entire contact

15 Option: 15u" gold on mating end, tin on termination end, nickel underplate on entire contact

30 Option: 30u" gold on mating end, tin on termination end, nickel underplate on entire contact

Jackscrews Installed

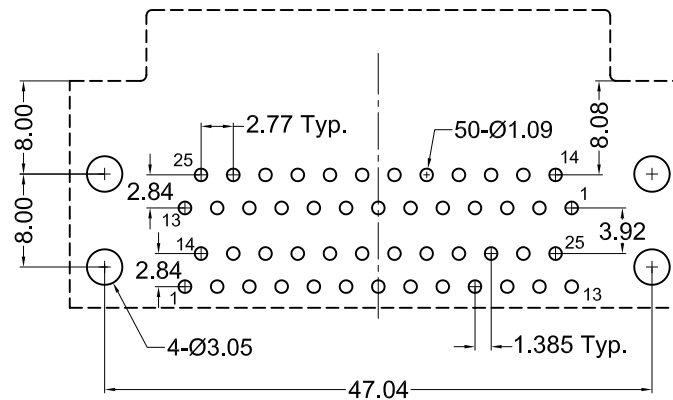
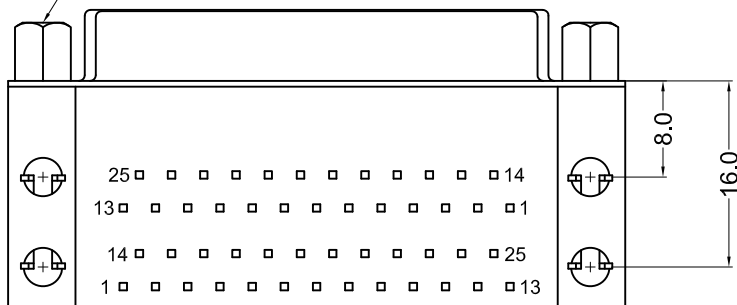

Recommended PCB Layout (Bottom View)

Electrical Specifications

Rated Current: 1.2A

Rated Voltage: 30V RMS

Insulation Resistance: more than 1000 megohms at 500V DC

Contact Resistance: 13 milliohms max.

Dielectric Withstanding Voltage: 1000V for 1 minute

Operating Temperature: -55°C to +105°C

Part Number	Contact Area Plating Finish
K42X-B25P/S-A4NJ	Gold Flash (standard)
K42X-B25P/S-A4NJ15	15u" Gold (15 option)
K42X-B25P/S-A4NJ30	30u" Gold (30 option)

Tolerances

X.X ± 0.25
X.XX ± 0.15
Unless Stated Otherwise



REV.	DATE	DESCRIPTION	REV. BY	CHK. BY	DRAWN BY	DATE
A1	11/24/09	New Drawing	S. Vien	H. MA	S. Vien	10/15/09
A2	12/31/17	ECO #17-037	G. Serrato	C. Furumasu		
A3	03/14/19	ECO #19-020	H. MA	D. Shehan		

K42X-B25P/S-A4NJ

D-Sub, Right Angle, Dual Port, RoHS Compliant

25 Pin Male/Female, 0.750" Spacing, JS

