

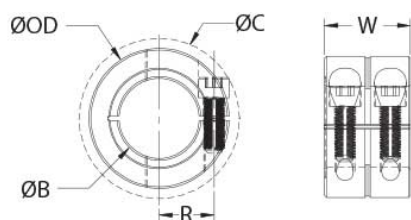

## WCL-10-SS

Ruland WCL-10-SS, 5/8" Double Wide Shaft Collar, 303 Stainless Steel, One-Piece Clamp Style, 1 5/16" OD, 15/16" Width



### Description

Ruland WCL-10-SS is a one-piece double wide shaft collar with a 0.6250" bore, 1 5/16" OD, and 15/16" width. The clamp style design does not mar the shaft, is easy to remove, and is indefinitely adjustable. It is commonly used for guiding, spacing, stopping, mounting, and component alignment. Equipment manufacturers benefit from the tightly controlled face to bore perpendicularity (TIR of ? .002"). Perpendicularity is critical for alignment when the shaft collar is used as a load bearing face, mechanical stop, or for mounting components such as gears or bearings. Proprietary processes have been developed by Ruland to maintain superior fit, finish, and holding power. WCL-10-SS is stamped with the Ruland name and bore size for ease of identification. This double wide shaft collar has 25% higher axial holding power than a round bore of equivalent size. It can also be used as a short rigid coupling for applications where a traditional rigid coupling is too long. Forged screws test beyond DIN 912 12.9 standards to ensure maximum holding power. WCL-10-SS is manufactured from solid bar stock sourced from select North American mills and machined to a fine burr free finish. Ruland uses 303 stainless steel with hardware of like material for consistent corrosion resistance. Stainless steel hardware undergoes a proprietary surface treatment process to prevent galling. WCL-10-SS is RoHS3 and REACH compliant and manufactured in our Marlborough, MA factory under strict controls using proprietary processes.

### Product Specifications

<b>Bore (B)</b>	0.6250 in	<b>Bore Tolerance</b>	+0.0020 in / +0.0005 in
<b>Outer Diameter (OD)</b>	1 5/16 in	<b>Clearance Diameter (C) MAX</b>	1.500 in
<b>Width (W)</b>	15/16 in	<b>Width Tolerance</b>	+0.003 in / -0.010 in
<b>Recommended Shaft Tolerance</b>	+0.0000 in / -0.0005 in	<b>Forged Clamp Screw</b>	#10-32
<b>Screw Material</b>	18-8 300 Series Stainless Steel	<b>Hex Wrench Size</b>	5/32 in
<b>Screw Finish</b>	Bright	<b>Seating Torque</b>	45 lb-in
<b>Screw Location (R)</b>	0.479 in	<b>Number of Screws</b>	4 ea
<b>Moment of Inertia</b>	0.0675 lb-in <sup>2</sup>	<b>Material Specification</b>	Type 303 Austenitic, Non-Magnetic Bar
<b>Finish Specification</b>	Bright, No Plating	<b>Manufacturer</b>	Ruland Manufacturing
<b>Country of Origin</b>	USA	<b>Temperature</b>	-40°F to 350°F (-40°C to 176°C)
<b>Weight (lbs)</b>	0.255400	<b>UPC</b>	634529075906
<b>Tariff Code</b>	8483.60.8000	<b>UNSPC</b>	31162811

**Note 1** Performance ratings are for guidance only. The user must determine suitability for a particular application.

**Prop 65**  **WARNING** This product can expose you to the chemical Nickel (metallic), known to the State of California to cause cancer. For more information go to [www.P65Warnings.ca.gov](http://www.P65Warnings.ca.gov).

### Installation Instructions

1. Use the WCL-10-SS double wide shaft collar as it is received.
2. Wipe the bore clean.
3. Apply a thin coat of light oil to the shaft.
4. Tighten the screws in two stages, starting with the inside screws. Using a torque wrench with 5/32" bit, tighten the inside screws to 22.5 lb-in which is half the recommended seating torque. Repeat for the outside screws, again tightening to half of the recommended seating torque.
5. Tighten the screws to the full recommended seating torque of 45 lb-in following the same pattern, starting with the inside screws first.