

LOOSE PIECE		TAPE MOUNTED		SPECIFICATIONS					
MATERIAL NUMBER	ENGINEERING NUMBER	MATERIAL NUMBER	ENGINEERING NUMBER	STUD SIZE	"S" ±.005 [0.13]	"W" ±.010 [0.25]	"C" MIN.	"L" MAX.	"H"
191980044	C-841-06	---	---	6	.146 [3.71]	.375 [9.53]	.301 [7.65]	1.118 [28.40]	.980 [24.89]
191980047	C-841-08	191980048	C-841-08T	8	.173 [4.39]				
191980050	C-841-10	191980051	C-841-10T	10	.198 [5.03]				

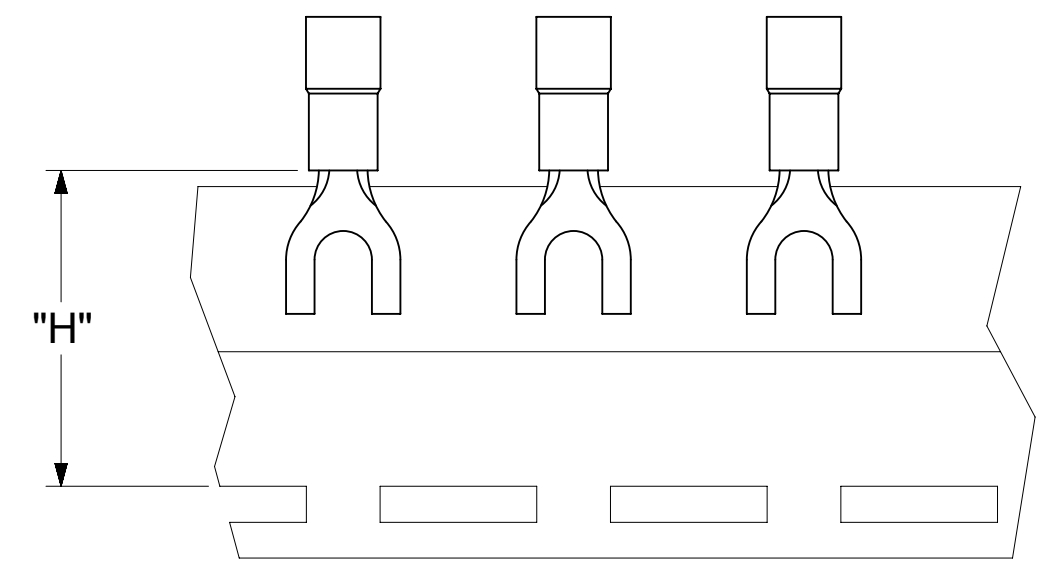
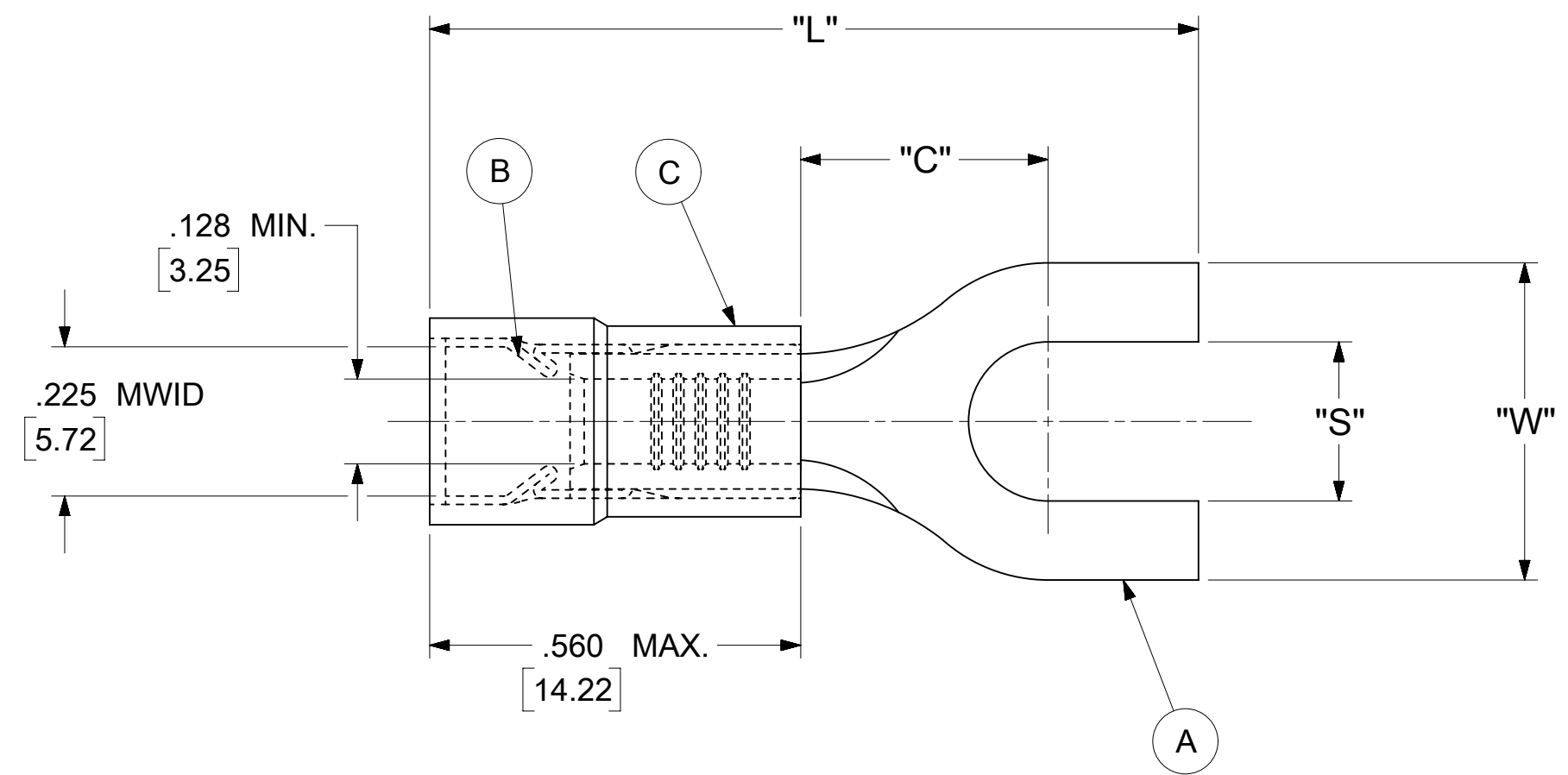

PARTS ON TAPE

- NOTES:
- MATERIAL:
 - (A). TERMINAL: COPPER (STOCK THICKNESS .040±.001 [1.02])
PLATING: ELECTRO-TIN (.0003 MIN.)
 - (B). TIN-PLATED BRASS FUNNEL FERRULE
 - (C). INSULATION: NYLON (COLOR CODED YELLOW)
 - MWID: MAXIMUM WIRE INSULATION DIAMETER
 - WIRE SIZE: 12 - 10 AWG
4.0 - 6.0 MM²
 - "UL" LISTING #E32244
"CSA" LISTING #18689
 - ALL DIMENSIONS IN INCHES/[MM].
 - PARTS ARE ROHS COMPLIANT.
 - DIMS. SHOWN ARE FOR REFERENCE ONLY.

SYMBOLS DIMENSION UNITS: INCH/MM SCALE: NTS GENERAL TOLERANCES (UNLESS SPECIFIED): 4 PLACES ± --- ± --- 3 PLACES ± --- ± .005 2 PLACES ± 0.13 ± .01 1 PLACE ± 0.25 ± --- 0 PLACES ± --- ± --- ANGULAR TOL ± 0.5 ° DRAFT WHERE APPLICABLE MUST REMAIN WITHIN DIMENSIONS THIRD ANGLE PROJECTION DRAWING SERIES: C-SIZE 19198	THIS DRAWING CONTAINS INFORMATION THAT IS PROPRIETARY TO MOLEX ELECTRONIC TECHNOLOGIES, LLC AND SHOULD NOT BE USED WITHOUT WRITTEN PERMISSION			CURRENT REV DESC: MIGRATION TO ECTR/NX			
	EC NO: 621540			DRWN: ABENJAMINLW 2019/07/25			
	CHK'D: GROJAS01 2019/07/29			APPR: JMACNEIL 2019/08/05			
	INITIAL REVISION:			DRWN: JJ 1984/11/12			
APPR: JMACNEIL 2019/08/05			SERIES: 19198				
DOCUMENT NUMBER: 191980044		DOC TYPE: PSD		DOC PART: 000		REVISION: A	
MATERIAL NUMBER: SEE TABLE		CUSTOMER: GENERAL MARKET		SHEET NUMBER: 1 OF 1			

NOTES:

- ① MAT'L: COPPER (STOCK TKN. $\frac{.040}{1.02}$)
 - ② PLATING: ELECTRO TIN (.0003 MIN)
 - ③ TIN-PLATED BRASS FUNNEL FERRULE
 - ④ NYLON INSULATION (COLOR CODED YELLOW)
- STUD SIZES: ($\pm .005$)
- 02 = .094
 04 = .119
 06 = .146
 08 = .173
 10 = .198
 14 = .265
 56 = .328
 38 = .390
- "UL" LISTING #E32244
 "CSA" LISTING #18689
- WIRE SIZE: 12 - 10 AWG
 4.0 - 6.0 MM²

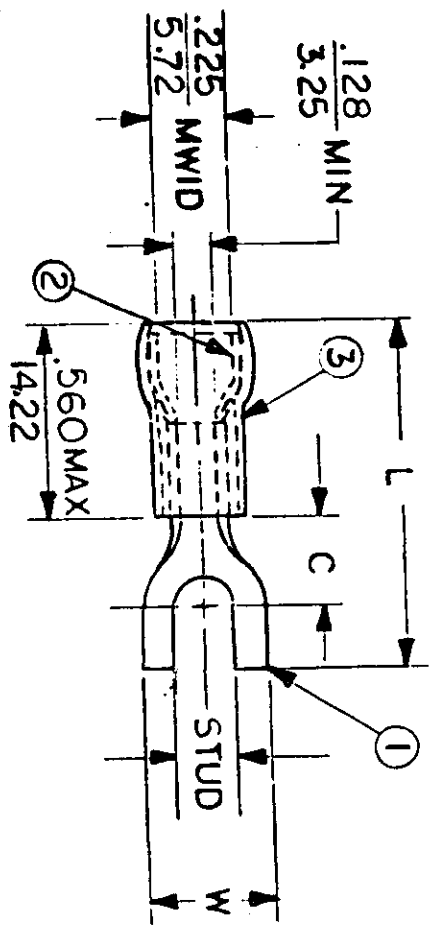

ALL DIMENSIONS = $\frac{\text{INCHES}}{\text{MM}}$ (MWID) = DENOTES MAXIMUM WIRE INSULATION DIAMETER

PART NUMBER	"W" ±.010	"C" MIN.	"L" MAX.	REFERENCE		DATE	TITLE:	DWG. NO.
				SCALE:	NTS			
C-841-	$\frac{.375}{9.53}$	$\frac{.301}{7.65}$	$\frac{1.118}{28.40}$	DRWN. BY: JJ	11.12.84	SPADE TONGUE TERMINAL AVIKRIMP 800-SERIES	A	CUSTOMER DWG
C-868-	$\frac{.533}{13.54}$	$\frac{.393}{9.98}$	$\frac{1.271}{32.28}$	CHKD. BY: GZ	11.26.84			
				APPRD. BY:				
DIMENSIONAL TOLERANCES UNLESS OTHERWISE SPECIFIED				SCALE: NTS		EIC Incorporated		
FRAC. DEC. ANG.				DATE		INCORPORATED		
± ± ±				11.26.84		CUSTOMER DWG		