

10 9 8 7 6 5 4 3 2 1

MATERIALS AND FINISHES

BODY: BERYLLIUM COPPER  
 PLATED: GOLD 30 MICROINCH MIN

CENTER CONTACT: BERYLLIUM COPPER  
 PLATED: GOLD 30 MICROINCH MIN

INSULATOR: TEFLON

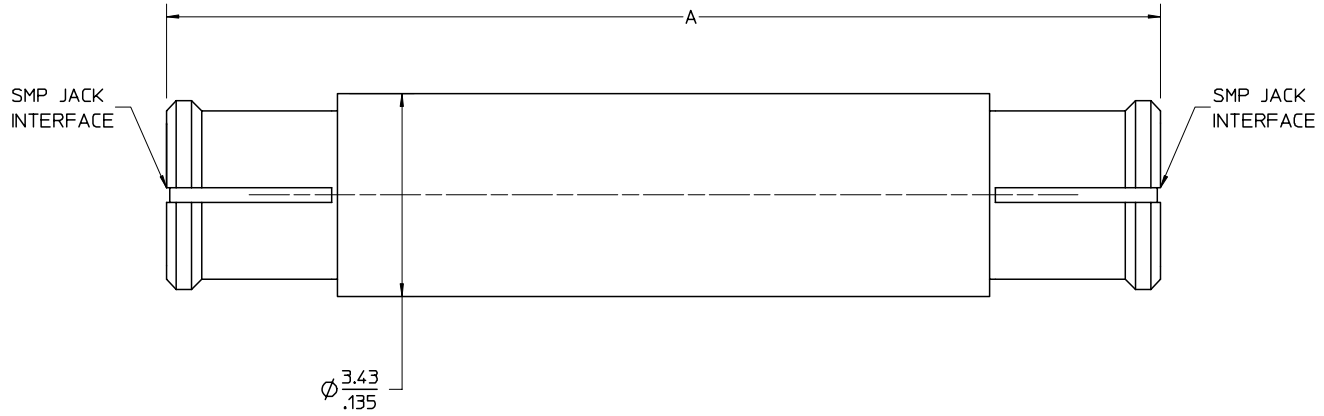

73415-4790	.760 REF	19.31 REF
PART #	DIM A	

PS-89675-3320	PRODUCT SPECIFICATION
MIL-STD-348A, FIG 326.1	INTERFACE
SPECIFICATION	DESCRIPTION

DIM 19.31 WAS 17.08 EC NO: URF2005-0542 DRWN:CLLI 2005/06/20 CHKD: 2005/06/20 APPR:MHUANG 2005/06/20	QUALITY SYMBOLS
	$\nabla = 0$ $\triangle = 0$
	DESCRIPTION
	REV

GENERAL TOLERANCES (UNLESS SPECIFIED)	mm	INCH
	4 PLACES $\pm$ ---	$\pm$ ---
	3 PLACES $\pm$ ---	$\pm$ ---
	2 PLACES $\pm 0.13$	$\pm$ ---
1 PLACE $\pm 0.25$	$\pm$ ---	
ANGULAR $\pm 2^\circ$		
DRAFT WHERE APPLICABLE MUST REMAIN WITHIN DIMENSIONS		

DIMENSION STYLE	
MM/IN	
DRAWN BY	DATE
DARRY	2004/03/16
CHECKED BY	DATE
KERRIE	2004/03/16
APPROVED BY	DATE
MISEN	2004/03/16
MATERIAL NO.	
SEE TABLE	
SIZE	
A3	

SCALE	DESIGN UNITS	THIRD ANGLE PROJECTION
---	METRIC	
SMP JACK ADAPTER SMP-J/J/ADP		
MOLEX INCORPORATED		
MATERIAL NO.	DOCUMENT NO.	SHEET NO.
	SD-73415-479	1 OF 1
THIS DRAWING CONTAINS INFORMATION THAT IS PROPRIETARY TO MOLEX INCORPORATED AND SHOULD NOT BE USED WITHOUT WRITTEN PERMISSION		

9 8 7 6 5 4 3 2 1