

P	LTR	DESCRIPTION	DATE	DWN	APVD
	C3	REVISED PER ECO-14-003457	11MAR2014	NK	DR
	C4	REVISED PER ECO-17-007400	24NOV2017	RS	DR

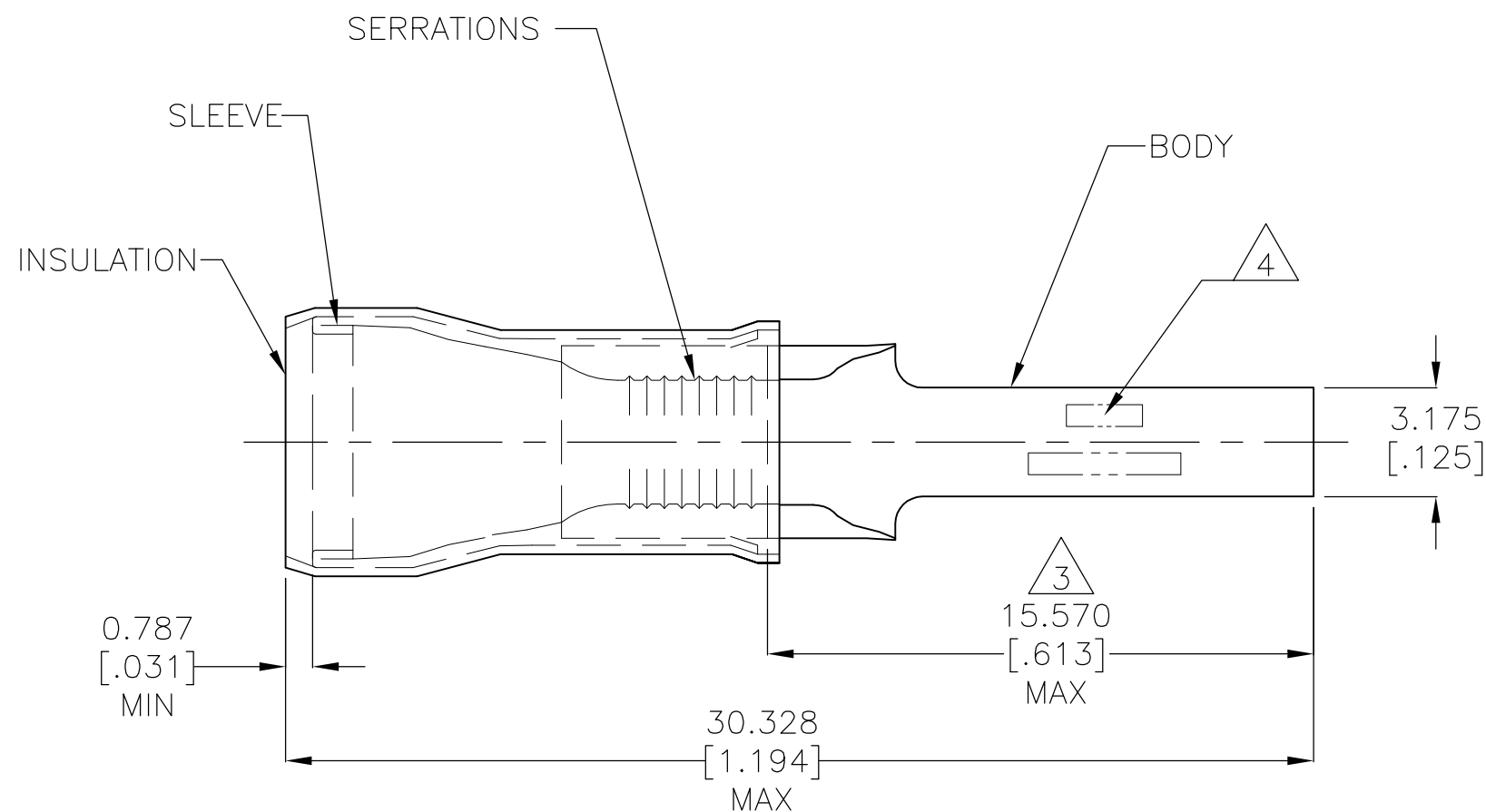

- 1 BODY MATERIAL THK IS 1.016±0.051[.040±.002]
- 2 WIRE INSULATION DIA RANGE IS FOR  $\phi 3.810[\phi.150]$  TO  $\phi 5.842[\phi.230]$
- 3 APPLIES FROM EDGE OF METAL WIRE BARREL TO END OF TAB
- 4 STAMP AMP 12-10\* APPROX AS SHOWN
- 5 MATERIAL:  
BODY & SLEEVE: COPPER PER ASTM B-152  
INSULATION: NYLON
- 6 FINISH:  
BODY & SLEEVE: TIN PLATED PER ASTM B-545  
INSULATION: COLOR-YELLOW

TAPE & REEL	2500	2-324543-1
LOOSE PIECE	500	324543
PACKAGE TYPE	QTY	PART NO

THIS DRAWING IS A CONTROLLED DOCUMENT.		DWN JR RUTH 22MAR07	TE Connectivity			
DIMENSIONS: mm [INCHES]		CHK T MICHELUTTI 22MAR07				
TOLERANCES UNLESS OTHERWISE SPECIFIED:		APVD T MICHELUTTI 22MAR07	NAME			
0 PLC ± - 1 PLC ± - 2 PLC ± - 3 PLC ± 0.127[.005] 4 PLC ± - ANGLES ± 1°		PRODUCT SPEC	WIRE TERMINAL TAB, PIDG, WIRE SIZE: 12-10			
MATERIAL		APPLICATION SPEC	SIZE	CAGE CODE	DRAWING NO	RESTRICTED TO
FINISH		114-2157	A3	00779	C-324543	-
5 6		WEIGHT	CUSTOMER DRAWING		SCALE	SHEET
		-			5:1	1 OF 1
					REV	C4