

CABLE 243 RF: RF CABLE ASSEMBLY, SMA S/T MALE TO SMA STRAIGHT BULKHEAD JACK WITH O-RING RATED TO IP67/68 + MULTIPLE CABLE OPTIONS

SPECIFICATIONS :

1. SMA STRAIGHT MALE, P/N:
 FOR RG178 CABLE: RFCT-SMA022-M78.
 FOR ϕ 1.13MM & ϕ 1.13MM LL CABLE: RFCT-SMA011-M13.
 FOR ϕ 1.32MM DS CABLE: RFCT-SMA038-M32.
 FOR ϕ 1.37MM CABLE: RFCT-SMA026-M37.
 FOR RG174 CABLE: RFCT-SMA096-M74.
2. COAXIAL CABLE, SEE P/N FOR DETAIL.
3. SMA STRAIGHT BULKHEAD JACK WITH O-RING RATED TO IP6768, P/N:
 FOR ϕ 1.13MM~RG178 CABLE: RFCT-SMA002-F78.
 FOR RG174 CABLE: RFCT-SMA002-F74.

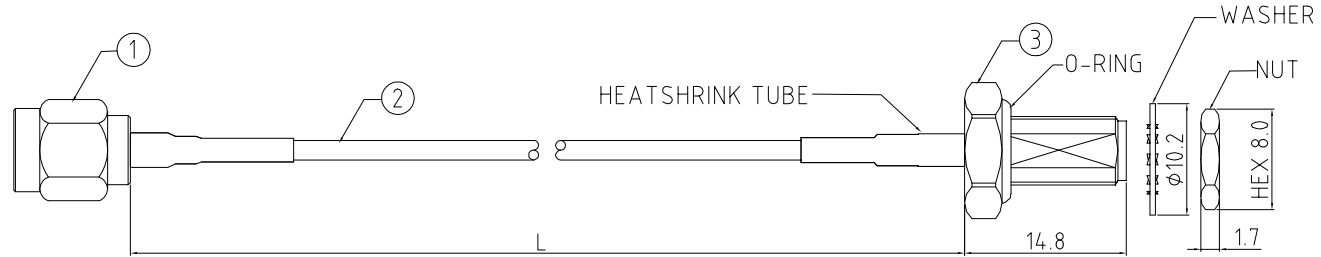

ENVIRONMENTAL:

- A. BULKHEAD MOUNTED CONNECTOR (RFCT-SMA002-Fxx)
 TESTED TO THE FOLLOWING SPECIFICATION:
- i. IP6X - DUST TIGHT - NO PARTICLE INGRESS.
 - ii. IPX7 WATERPROOF FOR 30 MINUTES UP TO 1 METER UNDERWATER.
 - iii. IPX8 WATERPROOF FOR 48 HOURS AT 1 METER UNDERWATER.
 - iv. IPX8 WATERPROOF FOR 12 HOURS AT 5 METERS UNDERWATER.
 - v. PRESSURE TEST - 1 BAR FOR 10 SECONDS.

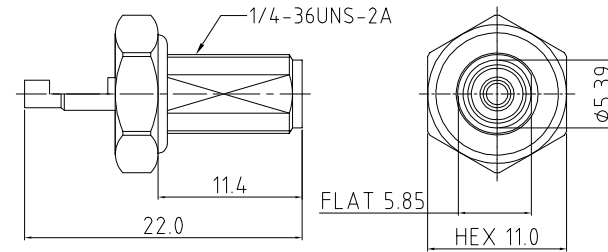

SMA JACK DETAIL DRAWING

NOTES:

1. WORKING FREQUENCY RANGE: DC-3GHz.
2. OPERATING TEMPERATURE: -40°C~+125°C (1.13MM~RG178 CABLE)
 -20°C~+80°C (RG174 CABLE)
3. IMPEDANCE: 50 OHM.

HOW TO ORDER
 CABLE 243 RF - X X X X - X - X

"L" LENGTH IN MM:
 eg: 100MM = 0100
 (MIN. 0050, MAX. 2000,
 STANDARD = 0100, 0150, 0200)
 Tolerance: 50mm: \pm 2mm.
 51-200mm: \pm 5mm.
 201-500mm: \pm 7mm.
 >500mm: \pm 10mm.

CABLE SIZE OPTIONS:
 1 = RG178 CABLE, COLOR: BROWN
 2 = ϕ 1.13MM CABLE, COLOR: GRAY
 3 = ϕ 1.13MM LOW LOSS CABLE, COLOR: GRAY
 4 = ϕ 1.32MM DS CABLE, COLOR: GRAY
 5 = ϕ 1.37MM CABLE, COLOR: BLACK
 6 = RG174 CABLE, COLOR: BLACK

WASHER AND NUT OPTIONS:
 BLANK = SEPARATELY PACKED (STANDARD)
 A = ALL ASSEMBLED WITH CONNECTOR

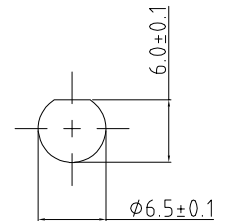

RECOMMENDED SMA MOUNTING HOLE

REV. DATE & DRN	10 07/08/16 - RH RELEASE
11 30/09/17 - NYW	ADD 1.13MM CABLE OPTIONS
12 01/11/18 - NYW	ADD 1.32DS CABLE OPTIONS
13 27/05/19 - NYW	ADD OPERATING TEMP.
14 20/09/19 - NYW	ADD 1.37 CABLE OPTION
15 06/11/20 - NYW	ADD NOTE 3
16 19/10/22 - NYW	UPDATE SMA P/N FOR 1.37 CABLE
17 19/10/22 - NYW	ADD CABLE SIZE OPTION 6

Scale: NTS	THIRD ANGLE	Unstated X XX XXX ANGLES	Tolerances: N/A N/A N/A N/A
Drawn: RJH			
App'd: XXX	Title CABLE ASSEMBLY		
Date: 19 JAN '22	Revision: 16	Unit: mm	

NAUTILUS
 IP67/68 Rated Cables

GRADCONN
 www.gradconn.com

Type: Cable 243 RF
CABLE 243 RF
Drawing Number:
Sheet 1 of 1
Drawing © E and O E