

Mechanical Dimensions: Inches [mm]

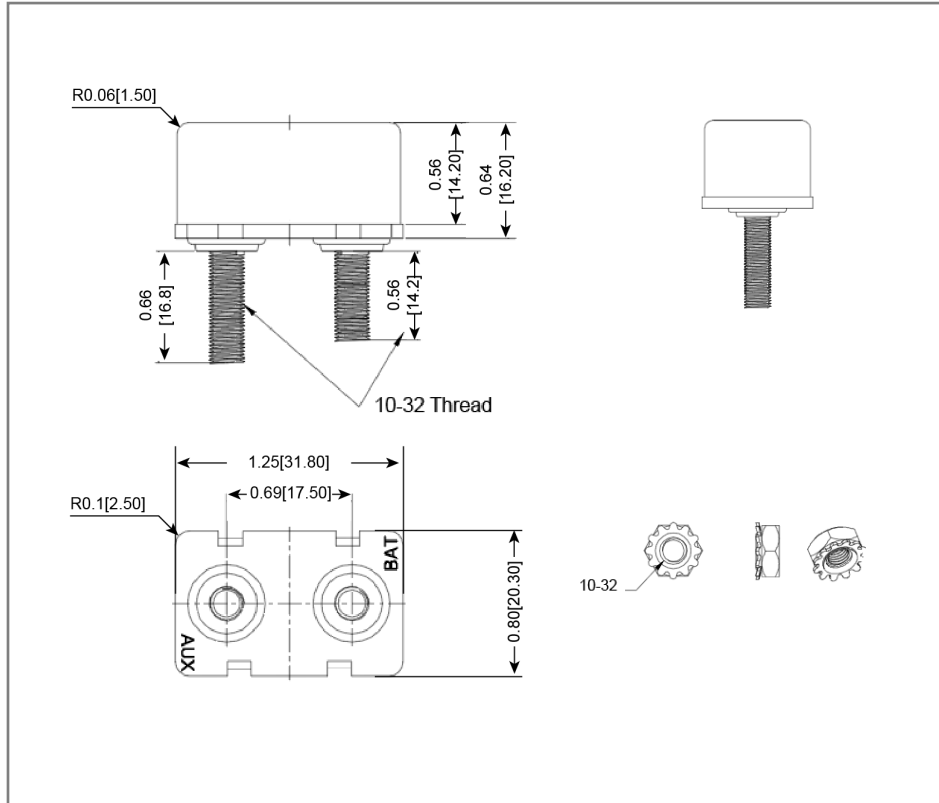

Part Numbers Information

Optifuse P/N	Current
ACBP-N-6A	6A
ACBP-N-8A	8A
ACBP-N-10A	10A
ACBP-N-15A	15A
ACBP-N-20A	20A
ACBP-N-25A	25A
ACBP-N-30A	30A
ACBP-N-40A	40A
ACBP-N-50A	50A

Time vs. Percent of Rated Current

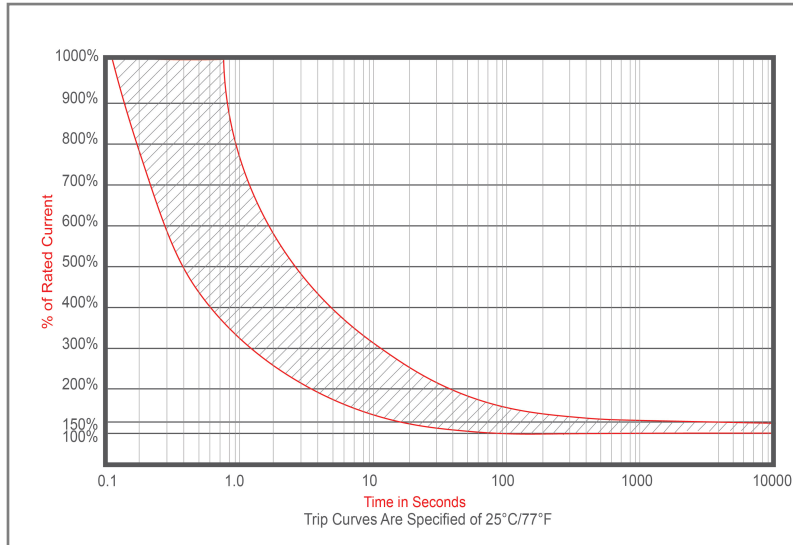

% of Rated Current	Min Trip Time	Max Trip Time
150%	1h	-
200%	4s	29s
300%	1.2s	10.5
400%	600ms	5s
500%	400ms	2.8s
600%	300ms	1.8s
800%	180ms	900ms
1000%	120ms	700ms

Electrical Specifications

Voltage Rating	32VDC	PENDING
Reset Type	Type I - Auto Reset	
Limited Short Circuit Current	1000A (UL1077)	
Insulation Resistance	DC 500V 100M ohm 5 sec	
Dielectric Strength	AC 1500V 1 minute	

Material Specifications

Body	Thermoplastic (UL94V-0)
Terminals	Battery – Copper Plate (0.58”), Auxiliary – Zinc Plate (0.66”)
Operation Temperature	-10°C ~ 60°C
Studs Torque	3.0±0.3 N.m
Ingress Protection	IP63

Ambient Temperature Correction Factor

-5 °C	(3A-4A)x 1.2, (5A-30A)x 1.12
+40 °C	(3A-4A)x 0.92, (5A-30A)x 0.94

The time/current characteristic curve depends on the ambient temperature prevailing. In order to eliminate nuisance tripping. Please multiply the current breaker current ratings by the derating factor shown below.

Example:

Normal Continuous Current	10A
Ambient Temperature	40 °C
Multiplication Factor	0.94
Recommended Rating	$10A/0.94=10.6A$
Select the Nearest Rating	11A

Rev Date of issue Revision Notes

Designed Approved

E	05-18-2023	Initial Drawing	RC	OF
---	------------	-----------------	----	----