

MATERIALS AND FINISHES :

SMA JACK STR  
 BODY BRASS  
 PLATED GOLD  
 INSULATOR TEFLON  
 CONTACT BERYLLIUM COPPER  
 PLATED GOLD  
 JAM NUT BRASS  
 PLATED GOLD  
 LOCK WASHER PHOSPHOR BRONZE  
 PLATED GOLD

SMA PLUG STR  
 BODY BRASS  
 PLATED GOLD  
 CONTACT BRASS  
 PLATED GOLD  
 INSULATOR TEFLON  
 C'RING BERYLLIUM COPPER  
 COUPLING NUT BRASS  
 PLATED GOLD  
 CRIMP TUBE BRASS  
 PLATED NICKEL

SHRINK TUBE VERSAFIT OR EQUIVALENT  
 CABLE RG174  
 LABEL SHRINK TUBE BLACK  
 TEXT AS SHOWN

PACKAGING BY PLASTIC BAG.

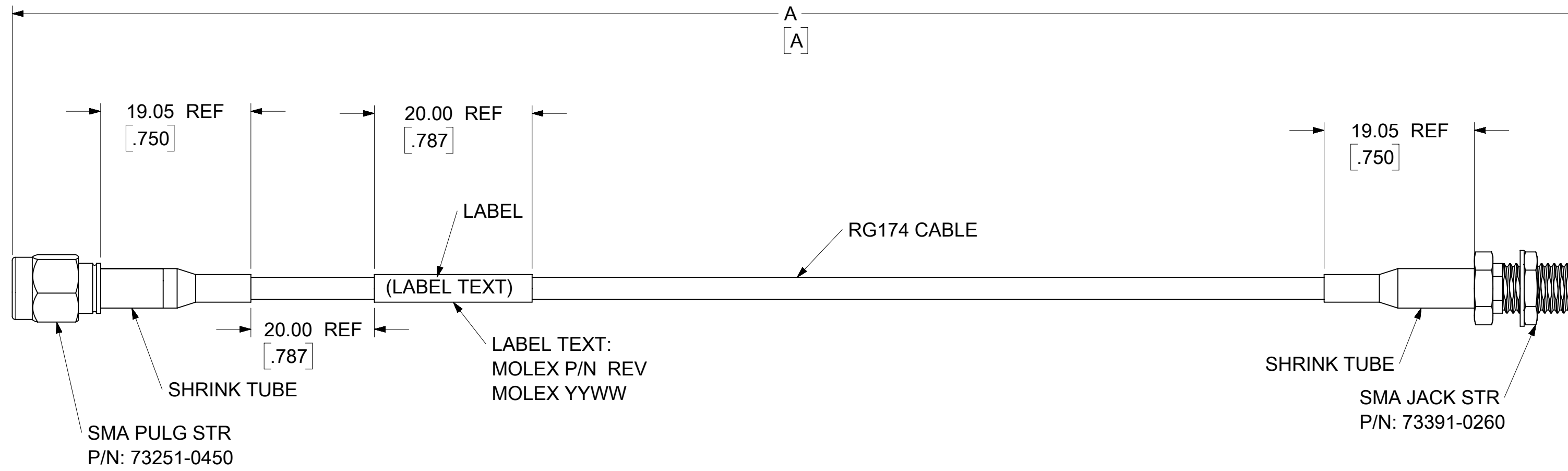
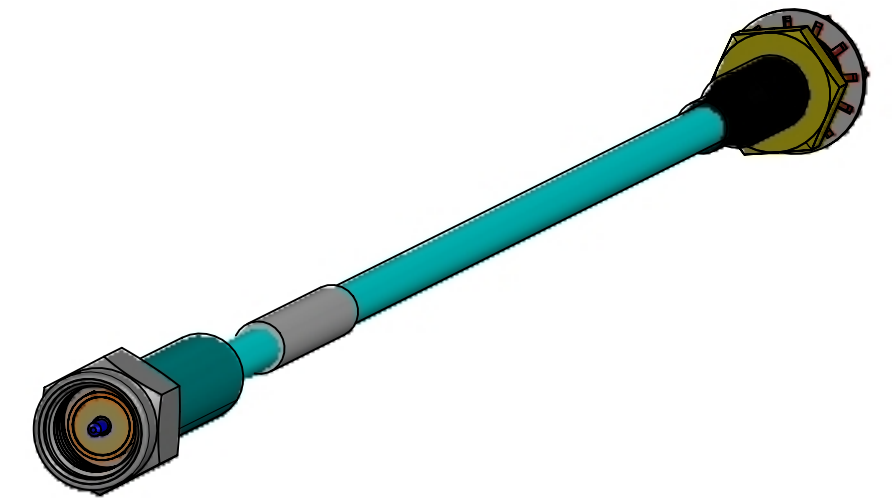

TABLE 1:

PS-89675-3460	PRODUCT SPECIFICATION
MIL-STD-348A, FIG. 301.1	INTERFACE
SPECIFICATION	DEACRIPTION

TABLE 2:

73230-5306	39.370±.472	1000.00±12.00
73230-5305	36.000±.472	914.40±12.00
73230-5304	24.000±.315	609.60±8.00
73230-5303	18.000±.236	457.20±6.00
73230-5302	12.000±.157	304.80±4.00
73230-5301	8.000±.118	203.20±3.00
73230-5300	6.000±.079	152.40±2.00
PART NO.	IN	MM
	DIM A	

FUNCTIONAL SYMBOLS $\frac{F}{A} = 0$ $\frac{E}{C} = 0$ $\frac{P}{D} = 0$ #####	THIS DRAWING CONTAINS INFORMATION THAT IS PROPRIETARY TO MOLEX ELECTRONIC TECHNOLOGIES, LLC AND SHOULD NOT BE USED WITHOUT WRITTEN PERMISSION		CURRENT REV DESC:		
	DIMENSION UNITS	SCALE	EC NO: 675763		
	MM/INCH	2:1	DRWN: WANGR2	2021/06/23	
	GENERAL TOLERANCES (UNLESS SPECIFIED)		CHK'D: MYLU07	2021/08/30	
ANGULAR TOL ± °		APPR: LCHEN03	2021/08/30	CA SMA JACK STR BKHD TO SMA PLUG STR WITH RG174 CABLE EWR#14557-A	
4 PLACES ±		INITIAL REVISION:		PRODUCT CUSTOMER DRAWING	
3 PLACES ±		DRWN: WANGR2	2021/06/23	DOCUMENT NUMBER	DOC TYPE   DOC PART   REVISION
2 PLACES ±		APPR: LCHEN03	2021/08/30	732305300	PSD   000   A
1 PLACE ±		THIRD ANGLE PROJECTION		MATERIAL NUMBER	CUSTOMER
0 PLACES ±		DRAWING		SEE TABLE 2	GENERAL MARKET
DRAFT WHERE APPLICABLE MUST REMAIN WITHIN DIMENSIONS		SERIES		SHEET NUMBER	
		C-SIZE		73230	1 OF 1