



ANATECH ELECTRONICS INC
RF & Microwave Filters & Products

710 MHz LC Bandpass Filter

Part Number: AE710B9360



Electrical Specifications

Center Frequency: 710 MHz
1-dB Passband : 614 MHz to 806 MHz
Insertion Loss: 1dB Max. @ 710 MHz
Return Loss: 14dB Min. @ 614 MHz to 806 MHz
Impedance: 50 Ohms

Mechanical

Connector Type: SMA(Female)
Dimensions: 2.50" x 1.125" x 0.750" in.

Environmental

Operating Temperature: -25°C to +70°C
Storage Temperature: -40°C to +90°C
Shock: 10 G. 11ms
Vibration: 10 G. 5 to 200Hz

Outline Drawing:

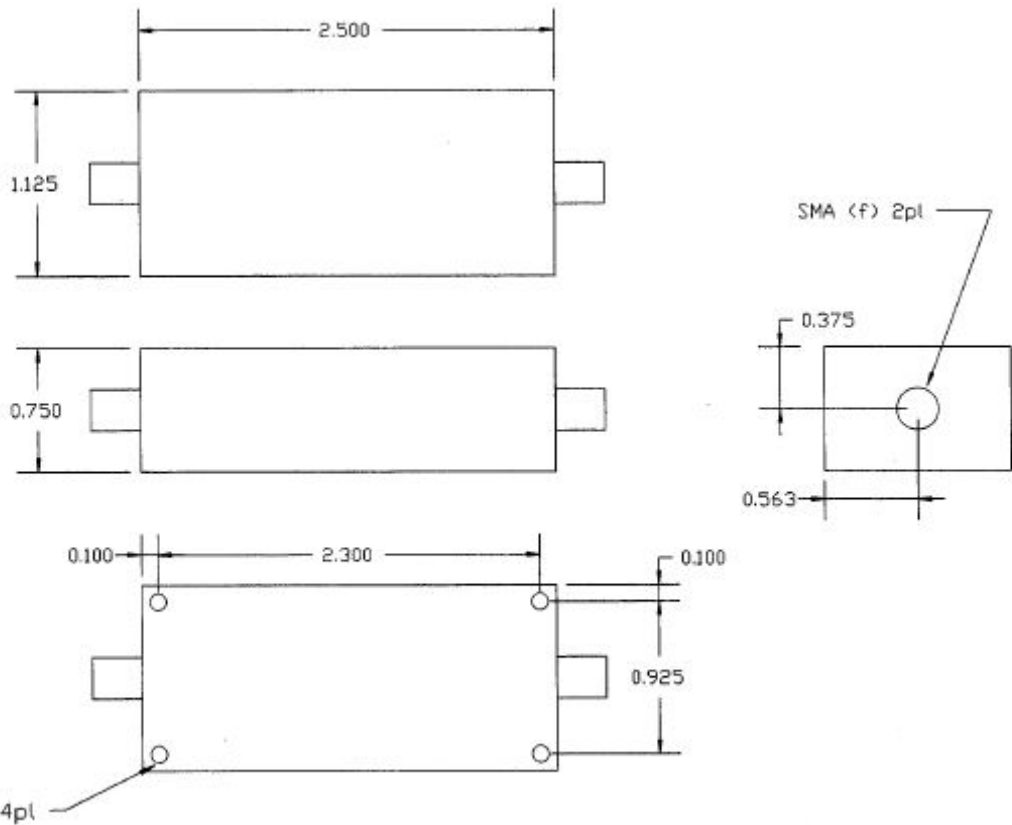

Tolerance: +/-0.01 inches [+/- 0.3mm]
 Angles: +/- 1 Deg.

*Tolerance as shown unless otherwise specified in the datasheet electrical specification tables above.

*When max dimensions are called out the above tolerances do not apply as long as it is under the max call out.

70 Outwater Lane Phone: (973) 772-4242
Garfield, NJ 07026 Fax : (973) 321-3941

Email: sales@anatechelectronics.com
Web: www.anatechelectronics.com



ANATECH ELECTRONICS INC
RF & Microwave Filters & Products

710 MHz LC Bandpass Filter

Part Number: AE710B9360



Response Plot:

