

| SIGN | DATE    | DESCRIPTION   | APPROVER |
|------|---------|---|----------|
| △    | 2/24'09 | The Withstand Vol changed from 2000V/min to 2500V/min | Kind     |
| △    | 2/23'11 | Add approval "cULus"                                  | Tason    |
| △    | 2/23'11 | Screw torque value changed from 18Kgf.cm to 16lb-In   | Tason    |
| △    | 5/07'12 | Add the description of "first pole"                   | Guoxue   |
| △    | 5/07'12 | Add the "TOP VIEW"                                    | Guoxue   |

*THIS IS CAD DRAWING, DO NOT REVISE MANUALLY!!!*

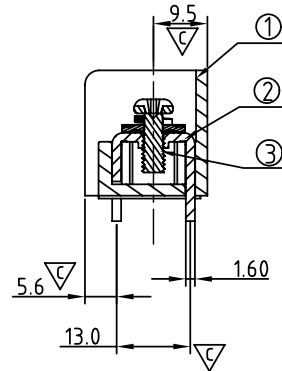

SECTION P-P

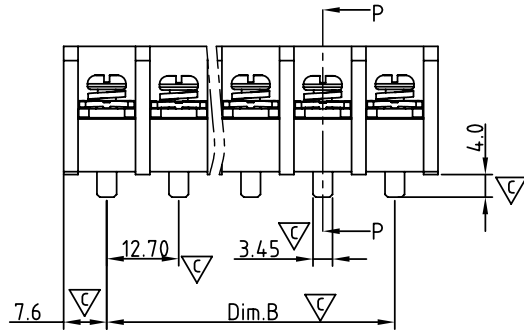
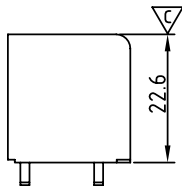
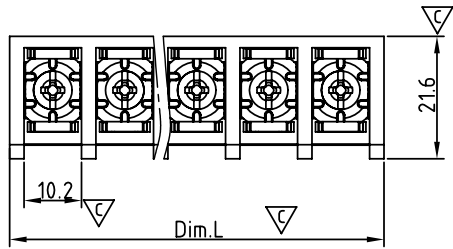
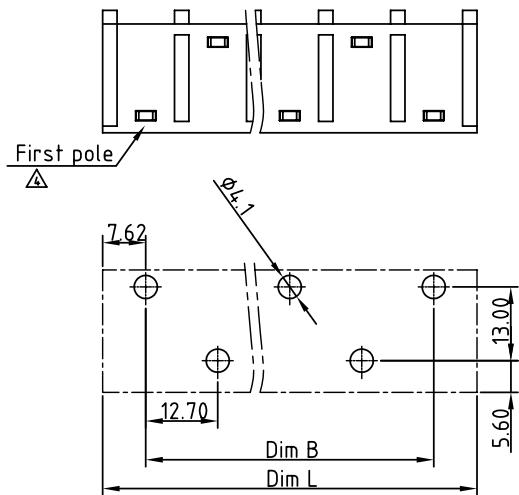

P.C.B LAYOUT  
TOP View

N= Number of poles  
 Dim.B= (N-1)x12.7  
 Dim.L= (N-1)x12.7+15.24

| POLE  | 2P~8P | 9P~14P | 15P~20P |
|-------|-------|--------|---------|
| Dim.B | ±0.20 | ±0.30  | ±0.40   |
| Dim.L | ±0.30 | ±0.40  | ±0.60   |

MATERIALS ELECTRICAL  
 RATED VOLTAGE & CURRENT: 600 V, 45A  
 △ WITHSTAND VOLTAGE: AC 2500 V/Min  
 INSULATION RESISTANCE: 1000 MΩ OR MORE AT DC 500 V  
 OPERATING TEMPERATURE RANG: -40 °C ~ +115 °C  
 △ SCREW TORQUE VALUE: 16lb-In  
 WIRE RANGE: 18 - 8 AWG  
 1) BODY: THERMOPLASTICS, UL94-V0 BLACK  
 2) TERMINAL: BRASS, 1.6t, Tin PLATED  
 3) TERMINAL SCREWS WITH WASHER: STEEL, Ni PLATED, M4.0  
 △ APPROVAL: Critical dimension:

YK 881 xx 0 x x 00G

NO. OF POLES ———— G RoHS compliant (lead<4%) In copper Alloy

02: 2 POLES  
 03: 3 POLES  
 04: 4 POLES  
 :  
 20: 20 POLES

MARK  
 0: "@ " MARK  
 1: "ANY" MARK

————— TERMINAL & SCREW PLATED  
 0: TERMINAL & SCREW: G/F  
 1: TERMINAL: G/F, SCREW: Ni  
 2: TERMINAL: Sn, SCREW: G/F  
 3: TERMINAL: Sn, SCREW: Ni

# ANYTEK

## CUSTOMER COPY

ALL RIGHTS RESERVED. REPRODUCTION OR ISSUE TO THIRD PARTIES IN ANY FORM WHATSOEVER IS NOT PERMITTED WITHOUT WRITTEN AUTHORITY FROM THE PROPRIETOR. PROPERTY OF ANYTEK TECHNOLOGY CO., LTD

| TITLE    |         | YK881 SERIES         |                      |          | DWG NO. |              | 8YK0001-881 |             |
|----------|---------|----------------------|----------------------|----------|---------|--------------|-------------|-------------|
| PART NO. |         | YK881xx0xx00G        |                      |          | DWG NO. |              | 8YK0001-881 |             |
| APPROVED | CHECKED | DESIGNED             | DRAWN                | CUST NO. |         | Tolerance    |             |             |
|          |         | Guoxue<br>2012.05.07 | Guoxue<br>2012.05.07 |          |         | UNIT: mm     |             | X. ±0.50    |
|          |         |                      |                      |          |         | SHEET: 01/01 |             | SCALE: NONE |
|          |         |                      |                      |          |         | REV.: D      |             | X.XX ±0.10  |
|          |         |                      |                      |          |         |              |             | X° ±1°      |