

PART NO.

**RFD-1601-HPL**

REV	DESCRIPTION	DWN	DATE	APPROVED
-	ENGINEERING RELEASE	CZS	02/20/14	JDMc

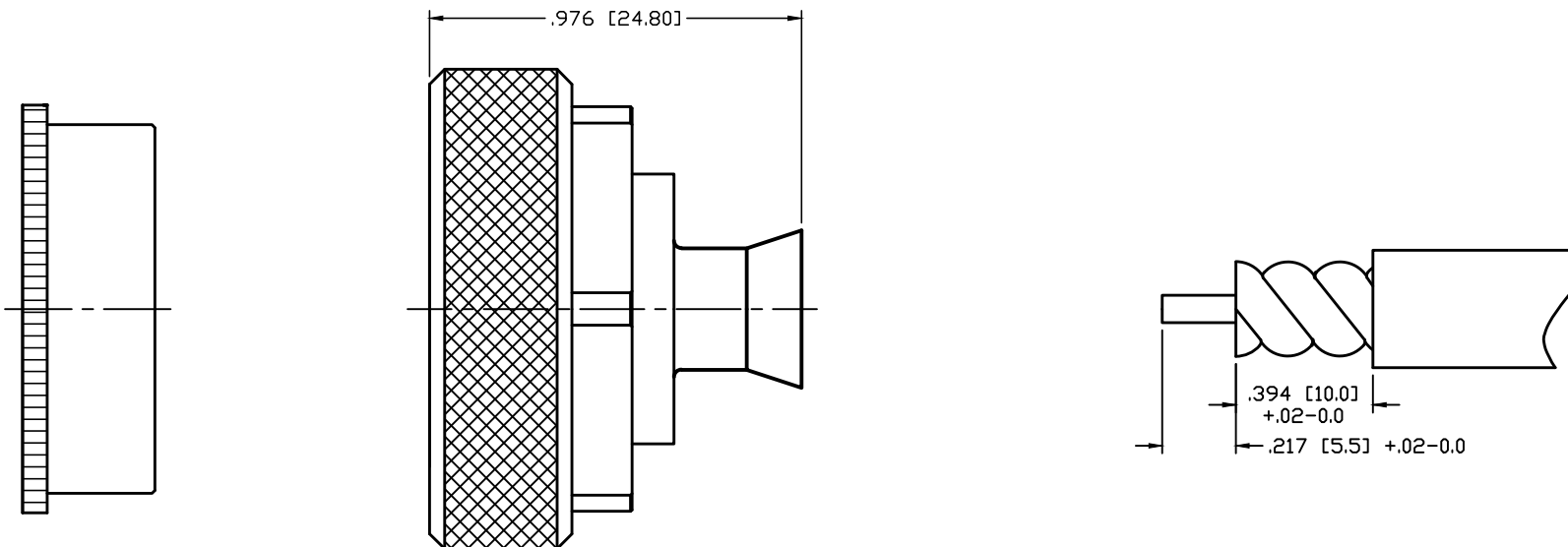

CUSTOMER  
OUTLINE DRAWING  
ALL DIMENSIONS  
ARE REFERENCE ONLY

UNLESS OTHERWISE SPECIFIED:  
DIMENSIONS ARE IN INCHES  
AND [MILLIMETERS]

DRAWN	C. ZUNIGA	02/20/14
CHECKED		
ORJ DRAWN	C. ZUNIGA	02/20/14

**RoHS**  
**COMPLIANT**

PROPRIETARY AND CONFIDENTIAL  
THIS DRAWING CONTAINS  
INFORMATION PROPRIETARY TO  
RF INDUSTRIES. ANY  
UNAUTHORIZED USE OF THIS  
DRAWING IS EXPRESSLY  
PROHIBITED WITHOUT WRITTEN  
PERMISSION FROM RF  
INDUSTRIES. ANY VIOLATION IS  
PUNISHABLE UNDER U.S.  
COPYRIGHT LAWS.

**RFconnectors**  
DIVISION OF RF INDUSTRIES, LTD. (858) 549-6345 FAX

7610 MIRAMAR RD.  
SAN DIEGO, CA 92126  
(858) 549-6340

**7/16 DIN PLUG**  
FOR SSP250

SIZE	CABLE GROUP	DWG NO.	REV
A	N/A	<b>RFD-1601-HPL</b>	—
SCALE:	ENGINEERING ID:	SHEET 1 OF 1	
NTS	001787		

#	DESCRIPTION	QTY	MATERIAL	FINISH
5	SHELL	1	BRASS	WHITE BRONZE
4	GASKET	1	RUBBER	----
3	PIN	1	BRASS	WHITE BRONZE
2	INSULATOR	1	PTFE	----
1	BODY	1	BRASS	WHITE BRONZE