

DO NOT SCALE
DIMENSIONS IN mm

METRIC

THIRD ANGLE
PROJECTION

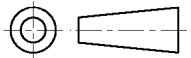

LTR.	REVISION RECORD	DR.	CHK.	DATE
C3	REVISED PER ECR-21-100855	AA	BH	14APR2021

TRADEMARK

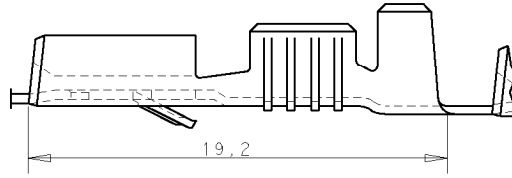
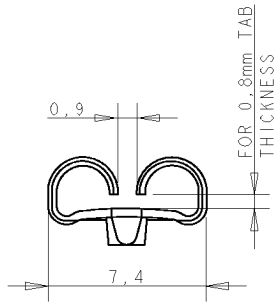
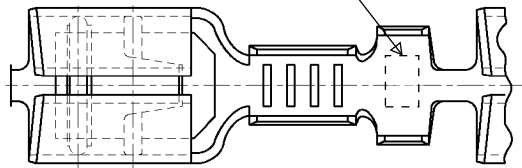

1 FOR USE ON MINIATURE APPLICATORS (LEFT-RIGHT FEED)
AND STANDARD APPLICATORS (RIGHT-LEFT FEED).

2. REELED WITH PAPER AND PAPER COVER.

3 OBSOLETE PARTS: OBSOLETE CIS STREAMLINING PER D.RENAUD/D.SINISI

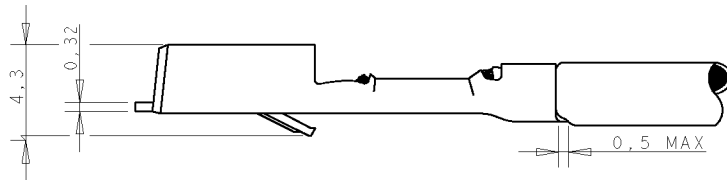
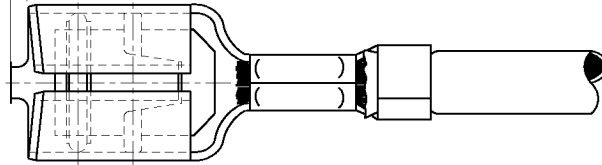
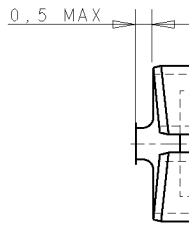

GENERAL TOLERANCES ± 0.3

3 OBSOLETE	NOTES	FINISH	MATERIAL	PARTNUMBER
		PRE-TINPLATED	PH.BRONZE	6-160927-6
		PRE-TINPLATED	BRASS	6-160927-7
		TINPLATED	PH.BRONZE	160927-4
		UNPLATED	PH.BRONZE	160927-3
		TINPLATED	BRASS	160927-2
		UNPLATED	BRASS	160927-1

CUSTOMER DRAWING		TE Connectivity	
FOR REFERENCE ONLY WILL NOT BE UPDATED		THIS DRAWING IS UNPUBLISHED RELEASED FOR PUBLICATION Jan .1988	
DR. R.v.Lokven	DATE 26.01.88	WIRE RANGE >1,0-2,5 mm ²	NAME .250 SRS FAST-IN-ON RECEPTACLE.
CHK. A.B.	DATE 02.02.88	INSUL. RANGE 2,1-3,1 DIA	REV. DATE D M Y 14 4 21
APP. L.v.Soest	DATE 03.02.88	SIZE A3	SHEET 1 OF 1
		DWG. No. 160927	REV. LTR. C3

DIRECTION OFF TOP OF REEL

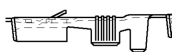

107 - 3 FIG 8.

8 7 6 5 4 3 2 1