

6

5

4

3

2

1

APPROVED: _____

DATE: _____ TITLE: _____

CA-FJFJ-XX004X

Rev	AWO #	Description	Date	Appr
-		RELEASED	10/12/22	

P1 CODE		P2 CODE	
Z	Water Blue	Z	Water Blue
N	Pastel Green	N	Pastel Green
M	Pink Orange	M	Pink Orange
L	Carmin	L	Carmin
K	Curry	K	Curry
I	Yellow	I	Yellow
H	Violet	H	Violet
G	Grey	G	Grey
F	Brown	F	Brown
E	Green	E	Green
D	Purple	D	Purple
C	Blue	C	Blue
B	White	B	White
A	Black	A	Black
Code	Color	Code	Color
Jack		Jack	

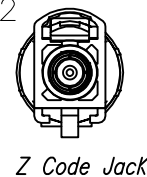
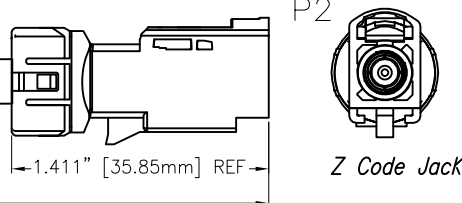
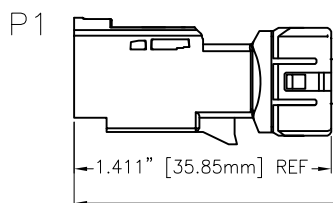
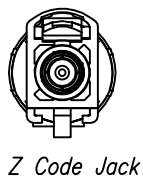
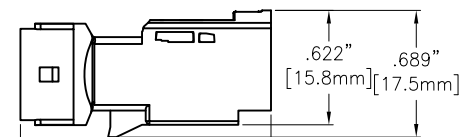
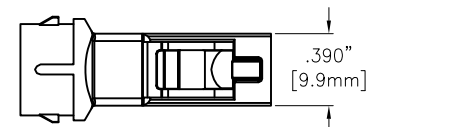
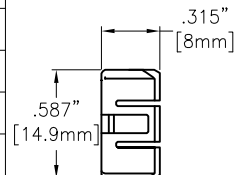
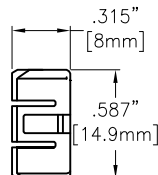
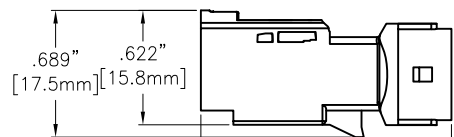
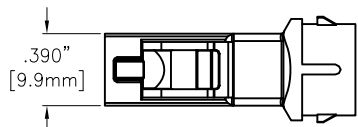

ADAM-P/N	L±T
CA-FJFJ-XX00403WP	11.811"±.787" [300±20mm]
CA-FJFJ-XX00406WP	23.622"±.787" [600±20mm]
CA-FJFJ-XX00410WP	39.370"±1.969" [1000±50mm]
CA-FJFJ-XX00420WP	78.740"±1.969" [2000±50mm]
CA-FJFJ-XX00430WP	118.110"±1.969" [3000±50mm]
CA-FJFJ-XX00440WP	157.480"±1.969" [4000±50mm]
CA-FJFJ-XX00450WP	196.850±3.937 [5000±100mm]

SPECIFICATIONS:

Connector:
P1&P2= FAKRA Female Code See Chart, Straight, Brass Gold Plated Contacts
ADAM-P/N: RF55-61Z-Y-02-50

Cable:
RG316U, Color: Brown

Electrical Test:
All Assemblies must be 100% Tested for
Shorts, Open, Continuity, and Physical Appearance.

Environmental:
IP Rating: IPX7

Lead free, RoHS compliant



UNLESS OTHERWISE SPECIFIED ALL DIMENSIONS ARE INCHES [MM]. TOLERANCES: EXCEPT AS NOTED

INCHES		HOLES	
.X	±.10	∅X	±.10
.XX	±.020	∅XX	±.015
.XXX	±.015	∅XXX	±.010

DRAWN	LH	10/12/22
CHECKED	RC	10/12/22
APPROVED		

THIS DRAWING CONTAINS INFORMATION THAT IS PROPRIETARY AND SHOULD NOT BE USED WITHOUT PRIOR WRITTEN PERMISSION FROM ADAM TECH



909 Rahway Avenue,
Union, NJ 07083
Phone: 908-687-5000
Fax: 908-687-5710

TITLE
CUSTOM CABLE ASSEMBLY, FAKRA FEMALE STRAIGHT TO FAKRA FEMALE STRAIGHT, RG316U, IPX7 RATED

SIZE	PART NO.	REV.
X	CA-FJFJ-XX004XWP	-
REF:	S00288T	SCALE: NTS SHEET 1 OF 1

6

5

4

3

2

1