

- 1
- 2
- 3
- 4
- 5
- 6
- 7
- 8
- 9
- 10
- 11
- 12
- 13
- 14
- 15
- 16
- 17
- 18

**STANDARD EXECUTIONS**

- **BEL-PH-ANB-1**: anodised aluminium body black colour. Glass window without contrast ring.
- **BEL-PH-TP-1**: technopolymer body white colour. Transparent technopolymer window, without contrast ring.
- **BEL-PH-TP-2**: technopolymer body white colour. Transparent technopolymer window, with contrast ring.

**CONTRAST FLUID**

- **K**: colourless
- **G**: transparent green

**SENSITIVITY OF THE BULL'S EYE LEVEL**

- # **10**: movement of the bubble by 2 mm for an inclination of the body of 10 angle minutes with respect to the horizontal surface.
- # **40**: movement of the bubble by 2 mm for an inclination of the body of 40 angle minutes with respect to the horizontal surface.
- See Bull's eye levels and screw-on levels technical data (on page 780).



**FEATURES AND APPLICATIONS**

BEL-PH bull's eye levels are used to control the horizontal positioning of jigs, machines, devices, equipment and instruments. The bull's eye levels are not aligned, that is, there is no pin in the external surface of the bull's eye level. The vertical position must be ensured by aligning the plate or the housing on which the element is mounted. The black colour of the execution (BEL-PH-ANB) creates a reflection on the bubble contour that significantly enhances readability. BEL-PH-TP execution is also available with contrast ring inside the housing (BEL-PH-TP-2) to create the same effect. As an alternative, the contrast can also be improved by a dark surface inside the mounting hole.

Conversion Table	
1 mm = 0,039 inch	
D	
mm	inch
10	0.39
12	0.47
14	0.55
15	0.59
18	0.71

**BEL-PH-ANB**

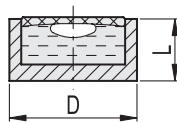

**BEL-PH-TP**

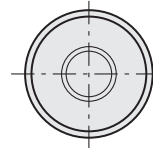
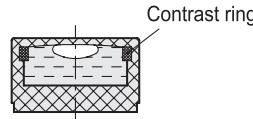

**BEL-PH-ANB-1**

**METRIC**

Code	Description	D	L	⚖️
156301	BEL-PH-ANB-10-K-10-1	10	6.9	1
156303	BEL-PH-ANB-12-K-10-1	12	6.4	2
156305	BEL-PH-ANB-14-K-10-1	14	6.2	2
156307	BEL-PH-ANB-15-K-10-1	15	7.4	3
156309	BEL-PH-ANB-18-K-10-1	18	7.3	4

**BEL-PH-TP-1**

**METRIC**

Code	Description	D	L	⚖️
156323	BEL-PH-TP-10-K-40-1	10	6	1
156335	BEL-PH-TP-12-K-40-1	12	7	2
156345	BEL-PH-TP-14-K-40-1	14	8	2
156355	BEL-PH-TP-15-K-40-1	15	8	3
156365	BEL-PH-TP-18-K-40-1	18	9	4
156321	BEL-PH-TP-10-G-40-1	10	6	1
156331	BEL-PH-TP-12-G-40-1	12	7	2
156341	BEL-PH-TP-14-G-40-1	14	8	2
156351	BEL-PH-TP-15-G-40-1	15	8	2
156361	BEL-PH-TP-18-G-40-1	18	9	4

**BEL-PH-TP-2**

**METRIC**

Code	Description	D	L	⚖️
156337	BEL-PH-TP-12-K-40-2	12	7	2
156347	BEL-PH-TP-14-K-40-2	14	8	2
156357	BEL-PH-TP-15-K-40-2	15	8	3
156367	BEL-PH-TP-18-K-40-2	18	9	4
156333	BEL-PH-TP-12-G-40-2	12	7	2
156343	BEL-PH-TP-14-G-40-2	14	8	2
156353	BEL-PH-TP-15-G-40-2	15	8	3
156363	BEL-PH-TP-18-G-40-2	18	9	4

Standard machine parts