

PART NO. **RFD-1610DS-H8**

REV	DESCRIPTION	DWN	DATE	APPROVED
—	ENGINEERING RELEASE	DM	11/2/20	JDM

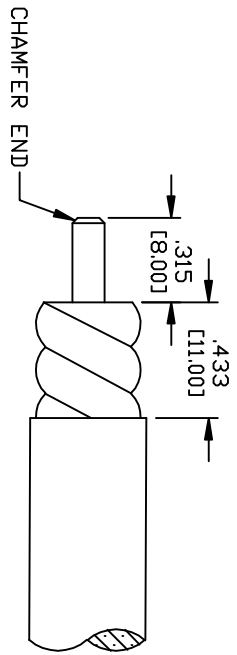
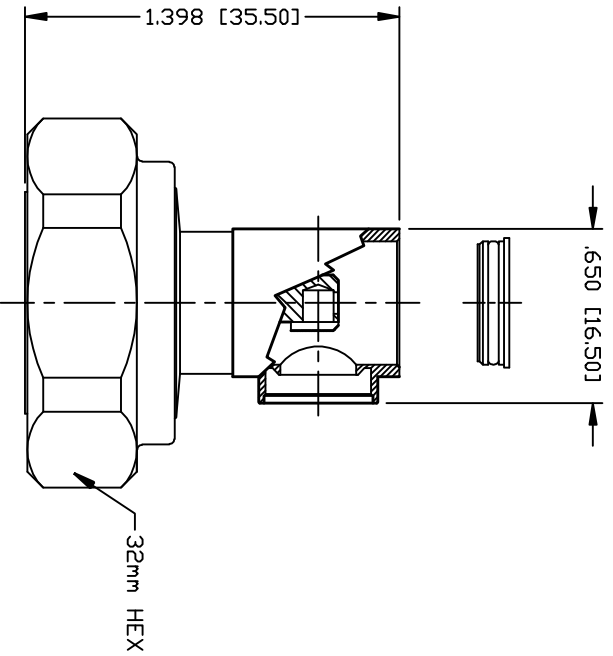

RECOMMENDED STRIPPING DIMENSIONS

SOLDER CABLE CONDUCTOR TO CONNECTOR INNER CONDUCTOR TO THE PIN CAVITY INSIDE THE CONNECTOR

**SPECIFICATIONS:**

IMPEDANCE: 50 Ohms  
 INTERFACE: IEC 61169-4  
 FREQUENCY RANGE: 0-7.5 GHz  
 INSERTION LOSS: -0.1 dB MAX  
 RETURN LOSS: 30 dB 0-700 MHz  
 RETURN LOSS: 23 dB 700-5000 MHz  
 RETURN LOSS: 19 dB 5-6 GHz  
 3rd ORDER IM TEST METHOD: 2x43 dBm  
 COUPLING TORQUE: 25 Nm MIN.  
 CABLE RETENTION FORCE: 250 Nm  
 ENVIRONMENTAL/COMPLIANCE: IP68 MATED / RoHS  
 TEMPERATURE RANGE: -55°C +85°C  
 DURABILITY: >500 MATING CYCLES  
 DIELECTRIC WITHSTANDING VOLTAGE: 4000 VRMS SEA LEVEL  
 INSULATION RESISTANCE: > 10,000 MΩ  
 NET WEIGHT: 0.15 lb  
 FOR FSJ2-50, LCF38-50J, LDF2-50, SCF38-50J, SPF-375, SPO-375 & SPP-375 CABLE

#	DESCRIPTION	QTY	MATERIAL	FINISH
1	Coupling Nut	1	BRASS	CuSnZn Alloy
2	Gasket	1	SILICONE	---
3	PIN	1	BRASS	SILVER
4	INSULATOR	1	PTFE	NATURAL
5	BODY	1	BRASS	CuSnZn Alloy

CUSTOMER OUTLINE DRAWING  
 ALL DIMENSIONS ARE REFERENCE ONLY  
 UNLESS OTHERWISE SPECIFIED: DIMENSIONS ARE IN INCHES AND [MILLIMETERS]

PROPRIETARY AND CONFIDENTIAL  
 THIS DRAWING CONTAINS INFORMATION PROPRIETARY TO RF INDUSTRIES. ANY UNAUTHORIZED USE OF THIS DRAWING IS EXPRESSLY PROHIBITED WITHOUT WRITTEN PERMISSION FROM RF INDUSTRIES. ANY VIOLATION IS PUNISHABLE UNDER U.S. COPYRIGHT LAWS.

**RF Industries**  
 DIVISION OF RF INDUSTRIES, LTD. (858) 548-6346 FAX  
 RFINDUSTRIES.COM  
 7610 MIRAMAR RD.  
 SAN DIEGO, CA 92126  
 (858) 548-6340

**7/16 DIN MALE R/A DIRECT SOLDER, FOR 3/8" SUPERFLEX**

CABLE GROUP DWG # **RFD-1610DS-H8** REVISION  
 H8  
 FORMAT A SCALE NTS CONTROL # 000000 SHEET 1 OF 1