

This document is the property of Amphenol Corporation and is delivered on the condition that it is not to be distributed, reproduced or used, in whole or in part, for manufacture or sale by anyone other than Amphenol Corporation without the prior consent, & that no right is granted to anyone or to use any information in this document.

REVISIONS				
SYM	CON	DESCRIPTION	DATE	APPROVED
A	HK000X	INITIAL RELEASE	4/15/05	Michael IP

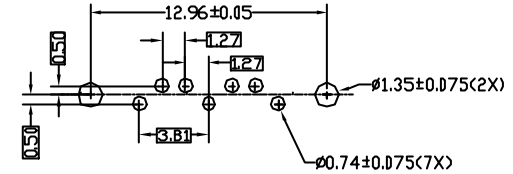
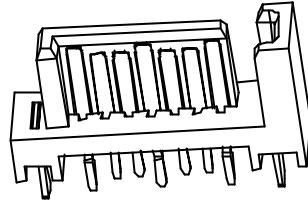
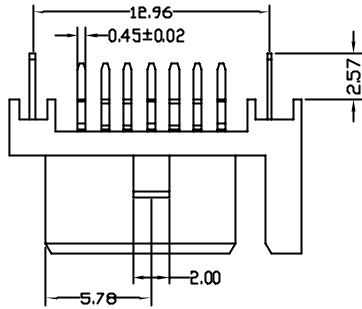

RECOMMENDED PCB LAYOUT  
(PCB THICKNESS 1.6mm OR 2.0mm)

**NOTE:**

**1. MATERIAL:**

**HOUSING:** FR-6145, UL 94 V-0, BLACK;

**CONTACTS:** COPPER ALLOY T=0.25mm;

**CONTACT FINISHED:** 1.27-2.54um. NICKEL UNDER PLATED ON ENTIRE CONTACT;

SEE NOTES 4 FOR GOLD PLATING ON MATING AREA;

2.54-5.08um MATTE TIN PLATED ON TAIL AREA;

**SOLDER TAB:** BRASS, t=0.25;

**SOLDER TAB FINISHED:** 2.54-5.05um TIN OVER 1.27um MIN. NICKEL;

**2. SPECIFICATIONS:**

**RATED CURRENT:**

SIGNAL PIN 1.5A MIN

POWER PIN 1.5A MIN

**DIELECTRIC STRENGTH:**

1000V FOR 1 MINUTE

**INSULATION RESISTANCE:**

1x10<sup>3</sup> MΩ

**TEMPERATURE:**

-40°C TO +105°C

**CONTACT RESISTANCE:**

30mΩ MAX

**PIN RETENTION FORCE:**

10N MIN. TOTAL (2.25 LB)

**3. PACKAGE: PACKING WITH TRAY.**

**4. ORDERING INFORMATION:**

SATA - 011 - 2017 - X

**GOLD PLATING ON MATING AREA:**

1: 0.76 um MIN.

2: 0.38 um MIN.

3: GOLD FLASH

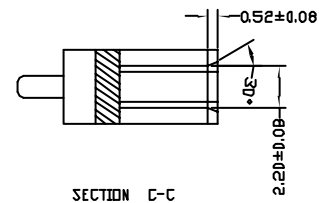
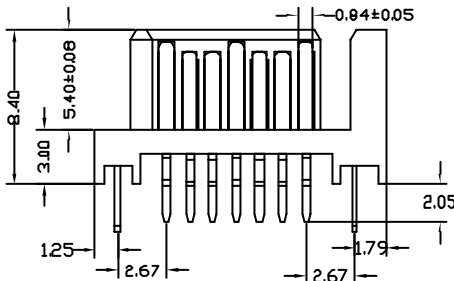
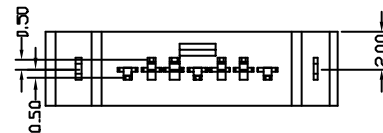
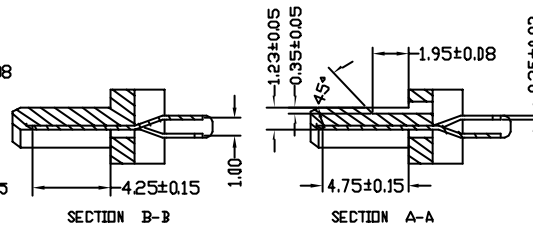
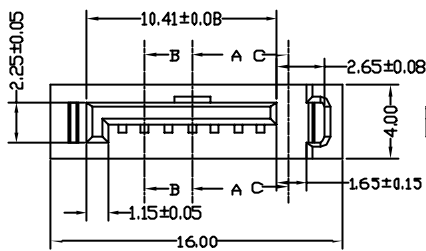

Customer Drawing

UNLESS OTHERWISE SPECIFIED <b>TOLERANCES</b> U.S. METRIC X +/- 0.3 XX +/- 0.15 XXX +/- FRACTIONS +/- ANGLES +/- 2° FOR MATERIALS AND FINISHES SEE NOTES REMOVE SHARP EDGES DIMENSIONS U.S. INCHES (METRIC) (IN)	APPROVAL DRAWN: TomJiang CHECKED: Michael IP	DATE 4/15/05 4/15/05	Amphenol
	DRAWING FILE: \\WINNINGDATA\DATA\DRAWING\2007\2007040		
	ANGLE OF PROJECTION 	SIZE A3C	DRAWING NO. SATA-011-2017-X
		SCALE NONE	REV. A
		SHEET 1 OF 1	