

THIS DRAWING IS UNPUBLISHED. RELEASED FOR PUBLICATION
 © COPYRIGHT - By - ALL RIGHTS RESERVED.

LOC	DIST	REVISIONS			
P	LTR	DESCRIPTION	DATE	DWN	APVD
AF	50	H2	REVISED PER ECR-18-013412	03SEP2018	BDA LB

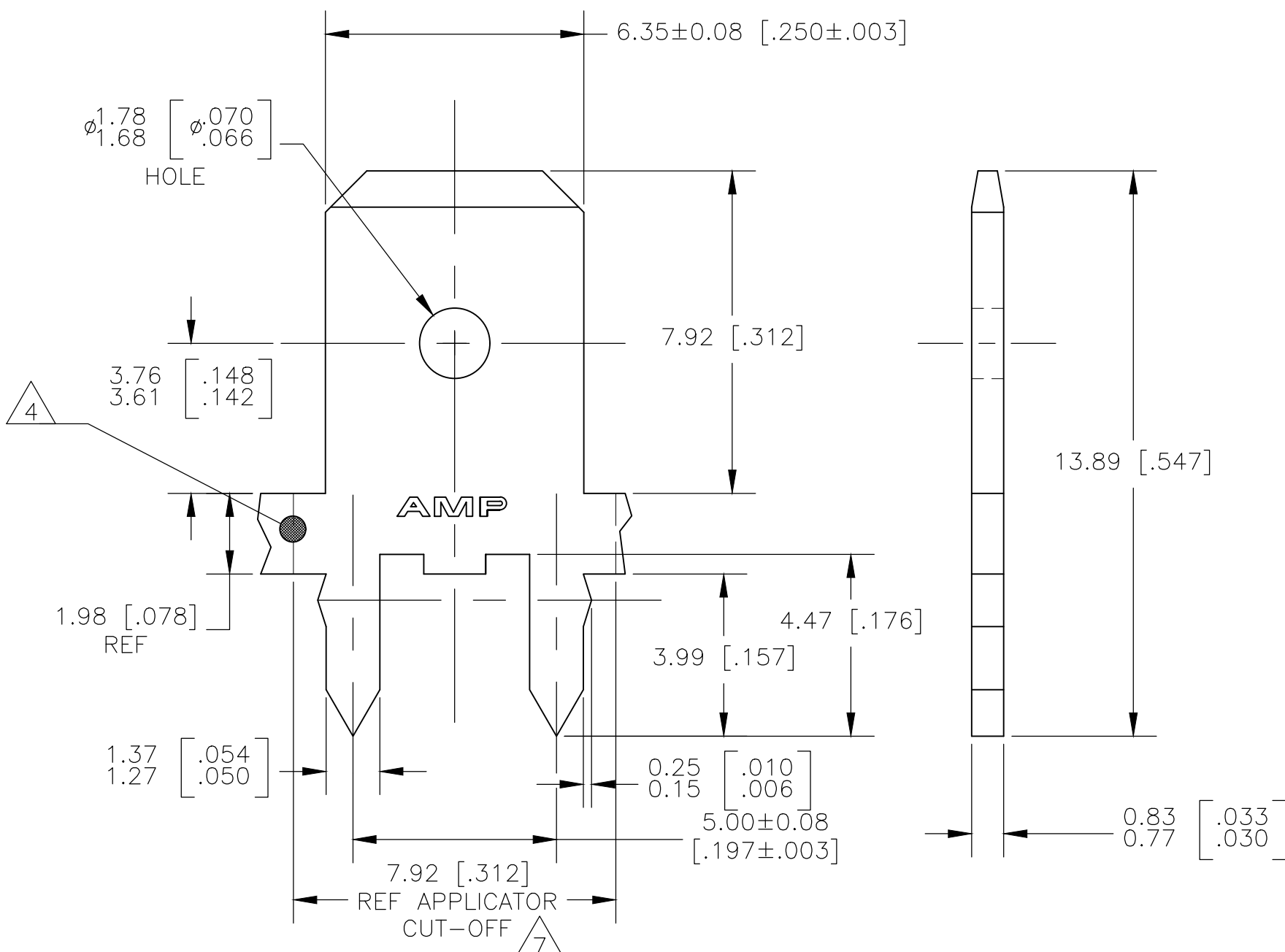

- 1 CONTINUOUS STRIP ON REELS.
- △ 2 TIN PLATE 0.00381 [.000150] MIN OVER 0.00254 [.000100] MIN THK COPPER OR TIN PLATE 0.00381 [.000150] MIN OVER 0.00127 [.000050] MIN THK NICKEL.
- 3 FEED IS 7.92±0.076 [.312±.003]
- △ 4 OPTIONAL ID MARK, LOCATION APPROX AS SHOWN.
- △ 5 REELED WITH INTERLEAVING PAPER.
- △ 6 LOOSE PIECE
- △ 7 LOOSE PIECE CUT-OFF DIMENSION

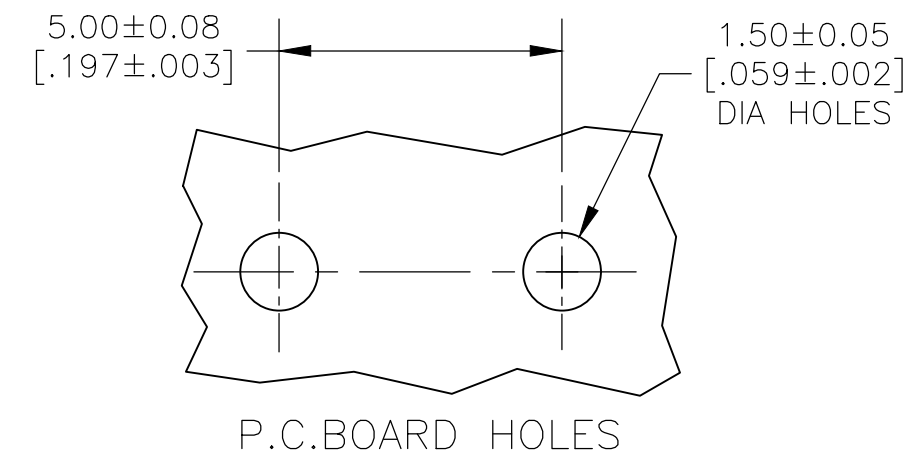

△ 6	63986-4
△ 5	63986-3
	63986-1
PART NUMBER	

THIS DRAWING IS A CONTROLLED DOCUMENT.		DWN	JR RUTH	30NOV00	STE TE Connectivity		
DIMENSIONS: mm[INCHES]		CHK	MS FEHER	30NOV00			
TOLERANCES UNLESS OTHERWISE SPECIFIED:		APVD	G PORTA	30NOV00	NAME		
0 PLC	± -	PRODUCT SPEC		TAB, FASTON, PC BOARD, 6.35 [.250] SERIES			
1 PLC	± -	APPLICATION SPEC		RESTRICTED TO			
2 PLC	± 0.25 [.010]	114-2115		SIZE	CAGE CODE	DRAWING NO	
3 PLC	± -	WEIGHT -		A3	00779	C=63986	
4 PLC	± -	MATERIAL BRASS		CUSTOMER DRAWING			
ANGLES	± -	FINISH △ 2		SCALE	SHEET	REV	
				8:1	1 of 1	H2	