

Single (S)

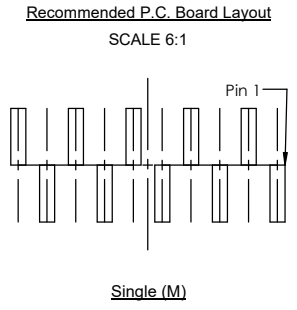

Single (M)

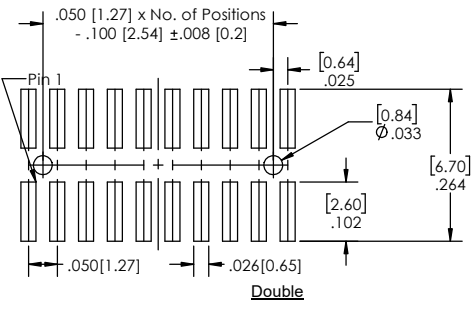

Double

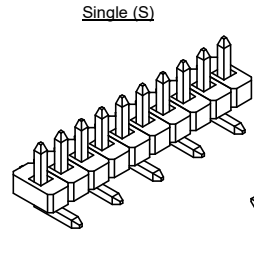

Single (S)

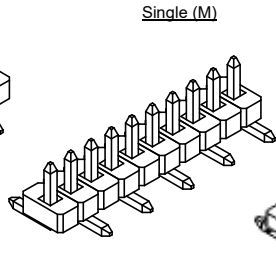

Single (M)

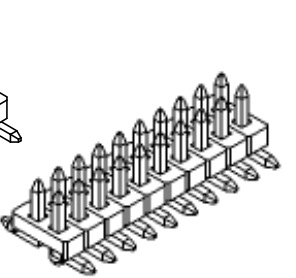

LTSHSM-5 **XX** - **X** - **XX** - **XX** - **V** - **XXX** - **X** - **XX** - **X** - **XX** - **LF**  
**(A)** **(B)** **(C)** **(D)** **(E)** **(F)** **(G)** **(H)** **(I)** **(J)** **(K)**

- A. Pins Per Row  
- 1 through 40
- B. Row Specification  
- S= Single Row  
- D= Double Row
- C. Pin Options  
- See Pin Options below
- D. Plating Options  
- See Plating Options below
- E. Vertical
- F. Polarized Position  
- Leave blank if not needed  
- If required, specify empty pin position  
- e.g. 012 for Pin 12
- G. Footprint option (only for single row)  
- S= Pin 1 left  
- M= Pin 1 right
- H. Packing Information  
- TR= Tape and Reel  
- TB= Tube
- I. Pad  
- P= Plastic  
- O= No Pad  
- If left blank packaging left to MLE's discretion  
- Pad may be metal, mylar or plastic
- J. Alignment Pin Option ( Only for Double Row)  
- Leave blank if not needed.  
- AP=With
- K. Lead Free

Mates with:  
LSSH  
SMSS  
SSH

Pin Options	
Post Height	
01	0.150 3.81
02	0.065 1.65
04	0.075 1.91
06	0.120 3.05

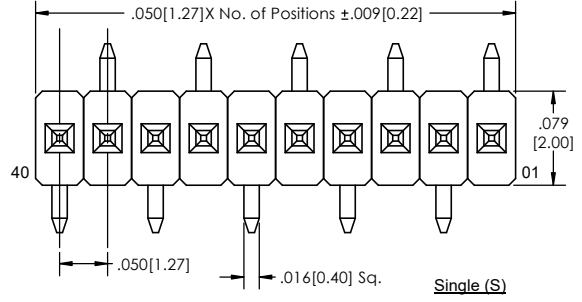
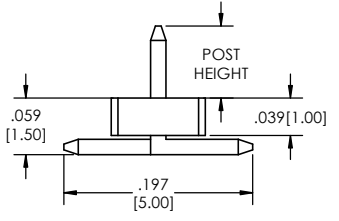

Single (S)

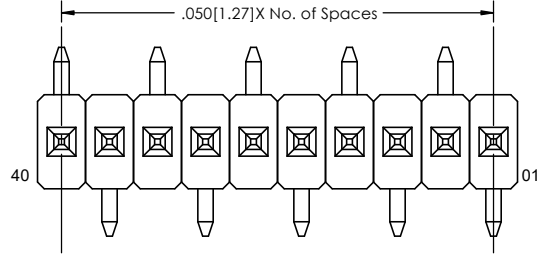

Single (M)

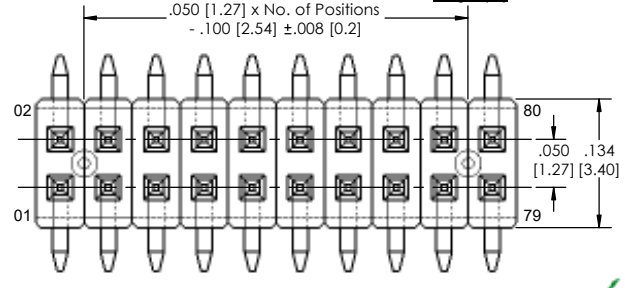

Double

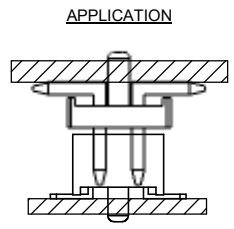
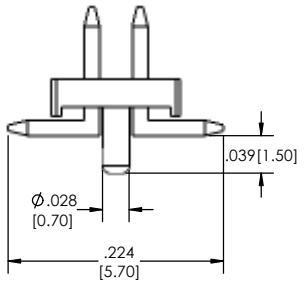

APPLICATION

Plating options	
G	-10µ Gold on Contact Area/ Flash on Tail
T	-Matte Tin all Over
GT	-10µ Gold on Contact Area/ Matte Tin on Tail
H	-30µ Gold on Contact Area/ Matte Tin on Tail
F	-Gold Flash over Entire Pin
FT	- Gold Flash on Contact Area/ Matte Tin on Tail

Specifications:  
 Current Rating: 1.0 Ampere  
 Insulation Resistance: 1000M Ohms Min.  
 Dielectric Withstanding: 300V AC  
 Contact Resistance: 20M Ohms Max.  
 Operation Temperature: -40°C to +105°C  
 Max. Process Temperature  
 Peak: 260°C up to 10 secs.  
 Process: 230°C up to 60 secs.  
 Wave: 260°C up to 6 secs.  
 Reflow: 260°C up to 10 secs.  
 Manual Solder: 350°C up to 5 secs.

Materials:  
 Contact Material: Phosphor Bronze  
 Insulator Material: Nylon 6T  
 Plating: Au or Sn over 50µ" (1.27) Ni  
 Tails may be clipped to achieve specific dimensions.

Products cut to specific sizes are uncancelable/ nonreturnable.  
 Parts are subject to change without notice.

PROPRIETARY AND CONFIDENTIAL  
 THE INFORMATION CONTAINED IN THIS DRAWING IS THE SOLE PROPERTY OF Major League Electronics. ANY REPRODUCTION IN PART OR AS A WHOLE WITHOUT THE WRITTEN PERMISSION OF Major League Electronics IS PROHIBITED.



UNLESS OTHERWISE SPECIFIED:		NAME	DATE
DRAWN		EOW	08/29/16
CHECKED		GWE	08/29/16
ENG APPR.			
MFG APPR.			
INTERPRET GEOMETRIC TOLERANCING PER:		ADDRESS:	
MATERIAL:		2533 Centennial Blvd.	
NEXT ASSY USED ON:		Jeffersonville, In 47130	
FINISH:		Phone: 812-670-4174	
APPLICATION		Fax: 812-670-4175	
DO NOT SCALE DRAWING		E-Mail: mle@mlelectronics.com	



TITLE: LTSHSM-5-V SERIES  
 SIZE DWG. NO. **C** REV **G**  
 SCALE 12:1 SHEET 1 OF 1