

REVISIONS					
P	LTR	DESCRIPTION	DATE	DWN	APVD
	A	NEW RELEASE PER ECO-14-013323	09-01-14	DM	DM

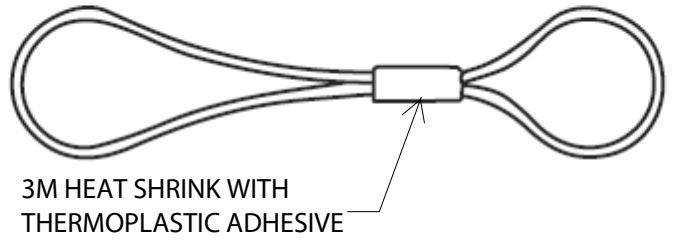
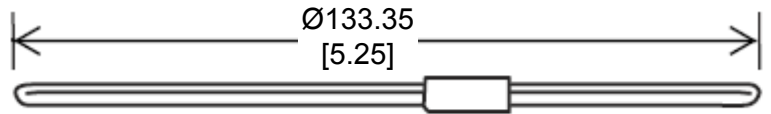
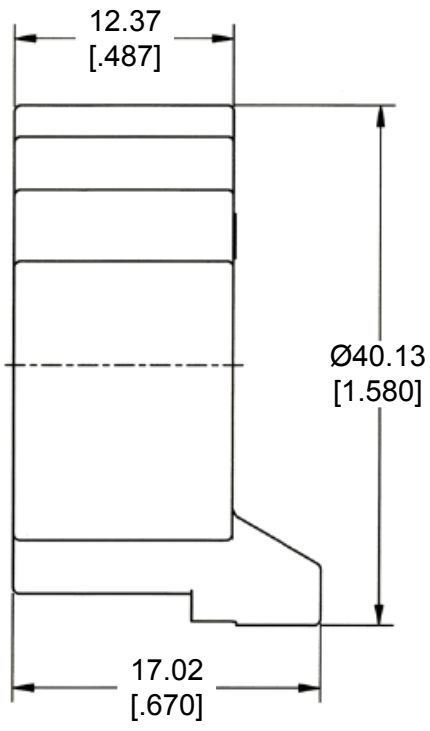
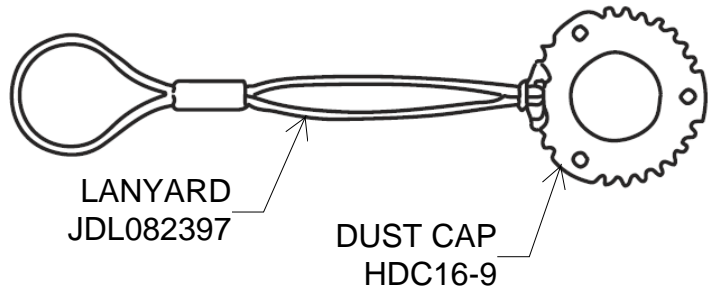

4. PART NO. HDC16-9-JDL
3. TEMPERATURE RATING: -40°C TO +108°C [-40°F TO +226°F]
2. MATERIAL: LANYARD-NITRILE, DUST CAP-PA66
1. THIS PART IS USED ON
 HD10-9-XXX RECEPTALCES
 HD14-9-XXX RECEPTALCES
 WHERE XXX IS PIN ARRANGEMENTS. SEE INVIDUAL CUSTOMER DRAWINGS

2014

RELEASED FOR PUBLICATION

THIS DRAWING IS UNPUBLISHED.

ALL RIGHTS RESERVED.
 © COPYRIGHT 2014 BY TE CONNECTIVITY

DIMENSIONS: MM [INCH]	DWN	D. MEYER 01SEP2014	MATERIAL	SEE NOTE 2	FINISH	GRAY
	CHK	I. GRANTCHAROVA 01SEP2014				
TOLERANCES UNLESS OTHERWISE SPECIFIED:	APVD	D. MEYER 01SEP2014				
0 PLC ±	PRODUCT SPEC	NAME				DUST CAP WITH LANYARD, SIZE 9
1 PLC ±	APPLICATION SPEC	HD10 SERIES				
2 PLC ± 0.63 [.025]		SIZE	CAGE CODE	DRAWING NO	RESTRICTED TO	
3 PLC ±	WEIGHT	19.93g	A 4	4AFU8	© = HDC16-9-JDL	-
4 PLC ±	Customer Drawing				SCALE	NONE
ANGLES ± 5°					SHEET	1 OF 1
					REV	A