

THIS DOCUMENT IS SUBJECT TO CHANGE WITHOUT NOTICE. IT IS CONFIDENTIAL AND A PROPERTY OF Amphenol LTW. DISCLOSURE TO THIRD PARTY HAS TO BE AUTHORIZED BY Amphenol LTW.

REV.	ECN NO.	DATE	SIGN	DESCRIPTION
B	LE3-960044	2009/06/22	Prune	Change The Note And 螺牙
C	LEN1450150	2014/05/22	Sam	Modify title

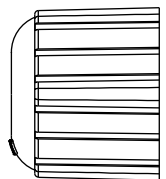

8 Sealing Nut



7 Seals

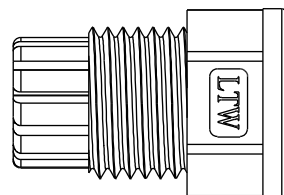

6 Clamp Ring



5 Gasket

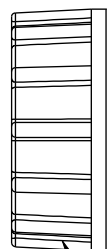

4 Lock Nut

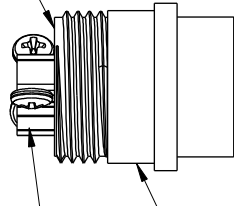

3 Screw



2 Connector



1 O-ring

With Liquid Glue

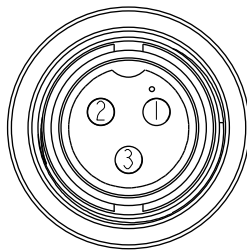
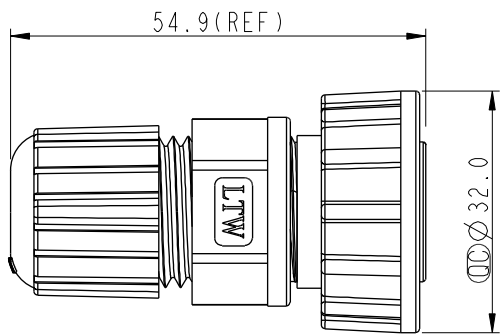

Pin Assignments
Front View

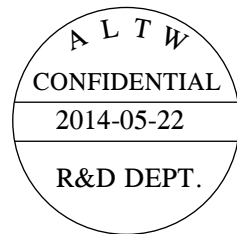

Note:

- * (CC) Important Dimension To Check.
- * Waterproof Rate: IP67
- * Housing: Nylon+GF
- * Male Pin: Copper Alloy, Gold Plated
- * Liquid Glue: Clear
- * Screw: Stainless Steel
- * Ring: Black, EPDM
- * Nut: Black, Nylon+GF
- * Gasket: Black, Silicone
- * Clamping Ring: Black, Nylon
- * Seals: Black, EPDM
- * Sealing Nut: Black, Nylon
- * Seal For Cable OD: $\varnothing 5.5\text{mm} \sim 10.8\text{mm}$
- * One Set Unassembled In One PE Bag
- * Application AWG: 14~16AWG

PE Pag 9



UNIT: mm			TITLE Large Assy Screw 3Pin F Conn M Pin
TOLERANCE .X ±0.25 .XX ±0.1 .XXX ±0.05 ANGLES ±1°	SCALE 1:1	SIZE A4	SHEET 1 OF 1
	REV. C	WC-REV. A.2	CC: Inspection item

Amphenol LTW
安費諾亮泰企業股份有限公司

ITEM NO DC-03BFMB-SL7001	DRAWN BY Sam	DATE 2014-05-22
DWG NO DC-03BFMB-SL7001	CHECKED BY Vicky	DATE 2014-05-22
CUSTOMER ALTW	APPROVED BY Rita	DATE 2014-05-22