

RUA Series

Features

- 130°C, 2,000 ~ 3,000 hours assured
- For automobile modules and other high temperature applications
- RoHS compliance
- AEC-Q200 Parts Available: Replace "S" Suffix with "KS" or "LS" Suffix



Specifications

Items	Performance																																								
Category Temperature Range	10 ~ 250V -40°C ~ +130°C	350 ~ 450V -25°C ~ +130°C																																							
Capacitance Tolerance	±20% (at 120 Hz, 20°C)																																								
Leakage Current (at 20°C)	<table border="1"> <tr> <th>Rated voltage</th> <th>≤ 100V</th> <th>> 100V</th> </tr> <tr> <th>Time</th> <td>after 2 minutes</td> <td>after 1 minutes</td> </tr> <tr> <th>Leakage Current</th> <td>I = 0.01CV or 3 (μA) whichever is greater</td> <td>CV ≤ 1,000 I = 0.1CV + 40(μA)</td> </tr> <tr> <td></td> <td></td> <td>CV > 1,000 I = 0.04CV + 100(μA)</td> </tr> </table> <p>Where, C = rated capacitance in μF, V = rated DC working voltage in V</p>		Rated voltage	≤ 100V	> 100V	Time	after 2 minutes	after 1 minutes	Leakage Current	I = 0.01CV or 3 (μA) whichever is greater	CV ≤ 1,000 I = 0.1CV + 40(μA)			CV > 1,000 I = 0.04CV + 100(μA)																											
Rated voltage	≤ 100V	> 100V																																							
Time	after 2 minutes	after 1 minutes																																							
Leakage Current	I = 0.01CV or 3 (μA) whichever is greater	CV ≤ 1,000 I = 0.1CV + 40(μA)																																							
		CV > 1,000 I = 0.04CV + 100(μA)																																							
Tanδ (at 120 Hz, 20°C)	<table border="1"> <tr> <th>Rated Voltage</th> <td>10</td><td>16</td><td>25</td><td>35</td><td>50</td><td>63</td><td>160</td><td>200</td><td>250</td><td>350</td><td>400</td><td>450</td> </tr> <tr> <th>Tanδ (max)</th> <td>0.15</td><td>0.12</td><td>0.10</td><td>0.10</td><td>0.08</td><td>0.08</td><td>0.20</td><td>0.20</td><td>0.20</td><td>0.24</td><td>0.24</td><td>0.24</td> </tr> </table>		Rated Voltage	10	16	25	35	50	63	160	200	250	350	400	450	Tanδ (max)	0.15	0.12	0.10	0.10	0.08	0.08	0.20	0.20	0.20	0.24	0.24	0.24													
Rated Voltage	10	16	25	35	50	63	160	200	250	350	400	450																													
Tanδ (max)	0.15	0.12	0.10	0.10	0.08	0.08	0.20	0.20	0.20	0.24	0.24	0.24																													
Low Temperature Characteristics (at 120 Hz)	<p>Impedance ratio shall not exceed the values given in the table below.</p> <table border="1"> <tr> <th>Rated Voltage</th> <td>10</td><td>16</td><td>25</td><td>35</td><td>50</td><td>63</td><td>160</td><td>200</td><td>250</td><td>350</td><td>400</td><td>450</td> </tr> <tr> <th>Impedance Ratio</th> <td>Z(-25°C) / Z(+20°C)</td> <td>3</td><td>2</td><td>2</td><td>2</td><td>2</td><td>3</td><td>3</td><td>3</td><td>6</td><td>6</td><td>6</td> </tr> <tr> <td></td> <td>Z(-40°C) / Z(+20°C)</td> <td>6</td><td>4</td><td>4</td><td>4</td><td>4</td><td>6</td><td>6</td><td>6</td><td>-</td><td>-</td><td>-</td> </tr> </table>		Rated Voltage	10	16	25	35	50	63	160	200	250	350	400	450	Impedance Ratio	Z(-25°C) / Z(+20°C)	3	2	2	2	2	3	3	3	6	6	6		Z(-40°C) / Z(+20°C)	6	4	4	4	4	6	6	6	-	-	-
Rated Voltage	10	16	25	35	50	63	160	200	250	350	400	450																													
Impedance Ratio	Z(-25°C) / Z(+20°C)	3	2	2	2	2	3	3	3	6	6	6																													
	Z(-40°C) / Z(+20°C)	6	4	4	4	4	6	6	6	-	-	-																													
Endurance	<table border="1"> <tr> <th>Test Time</th> <td>2,000 Hrs for φD ≤ 8 mm; 3,000 Hrs for φD ≥ 10 mm</td> </tr> <tr> <th>Capacitance Change</th> <td>Within ±20% of initial value</td> </tr> <tr> <th>Tanδ</th> <td>Less than 200% of specified value</td> </tr> <tr> <th>Leakage Current</th> <td>Within specified value</td> </tr> </table> <p>* The above specifications shall be satisfied when the capacitors are restored to 20°C after applied with rated subjected to DC voltage with the rated ripple current is applied for 2,000 / 3,000 hours at 130°C.</p>		Test Time	2,000 Hrs for φD ≤ 8 mm; 3,000 Hrs for φD ≥ 10 mm	Capacitance Change	Within ±20% of initial value	Tanδ	Less than 200% of specified value	Leakage Current	Within specified value																															
Test Time	2,000 Hrs for φD ≤ 8 mm; 3,000 Hrs for φD ≥ 10 mm																																								
Capacitance Change	Within ±20% of initial value																																								
Tanδ	Less than 200% of specified value																																								
Leakage Current	Within specified value																																								
Shelf Life Test	<table border="1"> <tr> <th>Test Time</th> <td>1,000 hrs</td> </tr> <tr> <th>Capacitance Change</th> <td>Within ±20% of initial value</td> </tr> <tr> <th>Tanδ</th> <td>Less than 200% of specified value</td> </tr> <tr> <th>Leakage Current</th> <td>Less than 500% of specified value</td> </tr> </table> <p>* The above specifications shall be satisfied when the capacitors are restored to 20°C after exposing them for 1,000 hours at 130°C without voltage applied. The rated voltage shall be applied to the capacitors before the measurements for 160 ~ 450V (Refer to JIS C 5101-4 4.1).</p>		Test Time	1,000 hrs	Capacitance Change	Within ±20% of initial value	Tanδ	Less than 200% of specified value	Leakage Current	Less than 500% of specified value																															
Test Time	1,000 hrs																																								
Capacitance Change	Within ±20% of initial value																																								
Tanδ	Less than 200% of specified value																																								
Leakage Current	Less than 500% of specified value																																								
Ripple Current and Frequency Multipliers	<table border="1"> <tr> <th rowspan="2">Rated Voltage (V)</th> <th rowspan="2">Cap.(μF)</th> <th colspan="4">Freq.(Hz)</th> </tr> <tr> <th>120</th> <th>1k</th> <th>10k</th> <th>100k up</th> </tr> <tr> <td rowspan="3">10 ~ 63</td> <td>0.47 ~ 100</td> <td>1.00</td> <td>1.85</td> <td>2.25</td> <td>2.50</td> </tr> <tr> <td>150 ~ 470</td> <td>1.00</td> <td>1.70</td> <td>1.88</td> <td>2.00</td> </tr> <tr> <td>1,000</td> <td>1.00</td> <td>1.45</td> <td>1.58</td> <td>1.65</td> </tr> <tr> <td rowspan="2">160 ~ 450</td> <td>≤ 33</td> <td>1.00</td> <td>1.50</td> <td>1.75</td> <td>1.80</td> </tr> <tr> <td>47 ≤</td> <td>1.00</td> <td>1.30</td> <td>1.40</td> <td>1.50</td> </tr> </table>		Rated Voltage (V)	Cap.(μF)	Freq.(Hz)				120	1k	10k	100k up	10 ~ 63	0.47 ~ 100	1.00	1.85	2.25	2.50	150 ~ 470	1.00	1.70	1.88	2.00	1,000	1.00	1.45	1.58	1.65	160 ~ 450	≤ 33	1.00	1.50	1.75	1.80	47 ≤	1.00	1.30	1.40	1.50		
Rated Voltage (V)	Cap.(μF)	Freq.(Hz)																																							
		120	1k	10k	100k up																																				
10 ~ 63	0.47 ~ 100	1.00	1.85	2.25	2.50																																				
	150 ~ 470	1.00	1.70	1.88	2.00																																				
	1,000	1.00	1.45	1.58	1.65																																				
160 ~ 450	≤ 33	1.00	1.50	1.75	1.80																																				
	47 ≤	1.00	1.30	1.40	1.50																																				

Diagram of Dimensions

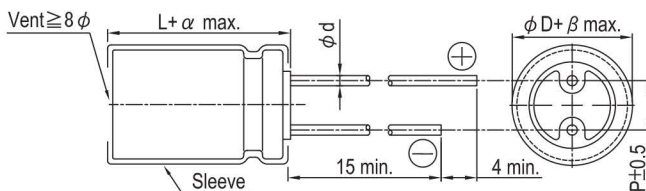

Lead Spacing and Diameter Unit: mm

φD	8	10	12.5	16
P	3.5	5.0	5.0	7.5
φd	0.6			0.8
α	L<20: 1.5, L≥20: 2.0			
β	0.5			

The case size of 16×20 is suitable for below diagram:

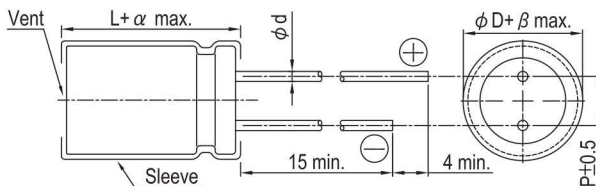

Dimension and Permissible Ripple Current Dimension: $\phi D \times L$ (mm)
Ripple Current: mA/rms at 120 Hz, 130°C

Cap.(μ F)	Rated Volt. (V _{DC}) Contents	10V (1A)		16V (1C)		25V (1E)		35V (1V)		50V (1H)		63V (1J)	
		$\phi D \times L$	mA	$\phi D \times L$	mA	$\phi D \times L$	mA	$\phi D \times L$	mA	$\phi D \times L$	mA	$\phi D \times L$	mA
10	100									8×11.5	84	8×11.5	84
22	220							8×11.5	113	10×12.5	149	10×12.5	149
33	330					8×11.5	138	10×12.5	162	10×16	200	10×16	200
47	470			8×11.5	150	10×12.5	194	10×16	213	10×16	239	10×20	260
100	101	10×12.5	231	10×16	285	10×16	312	10×20	338				
220	221	10×16	378	10×20	458	12.5×20	557	12.5×25	605	12.5×20	419	12.5×20	419
330	331	10×16	462	12.5×20	621	12.5×25	740	16×20	755				
470	471	10×20	599	12.5×25	806	16×20	902			16×20	689		
1,000	102	16×20	1073										

Cap.(μ F)	Rated Volt. (V _{DC}) Contents	160V (2C)		200V (2D)		250V (2E)		350V (2V)		400V (2G)		450V (2W)	
		$\phi D \times L$	mA	$\phi D \times L$	mA	$\phi D \times L$	mA	$\phi D \times L$	mA	$\phi D \times L$	mA	$\phi D \times L$	mA
4.7	4R7							10×20	53	10×20	53	10×25	58
10	100			10×20	78	10×20	78	10×25	85	10×25	86	12.5×20	86
22	220	10×20	115	10×25	126	12.5×20	128	12.5×25	139	12.5×25	142	16×25	154
33	330	10×25	154	12.5×20	157	12.5×25	171	16×25	189	16×25	189	16×31.5	203
47	470	12.5×20	187	12.5×25	204	16×25	225	16×31.5	243	16×31.5	243		
68	680	12.5×25	245	16×20	250	16×31.5	292						
100	101	16×25	329	16×25	329								
150	151	16×31.5	434										

Part Numbering System

RUA Series 470 μ F \pm 20% 16V Bulk Package Gas Type 12.5 ϕ ×25L

RUA **471** **M** **1C** **BK** - **1325** **S**

Series Name Capacitance Capacitance Tolerance Rated Voltage Lead Configuration and Package Rubber Type Case Size Regional Code

Note: For more details, please refer to "Part Numbering System (Radial Type)" on page 13.