

CAD FILE S8708991.DGN  
 DWG. NO. SD 87089-\*\*-91

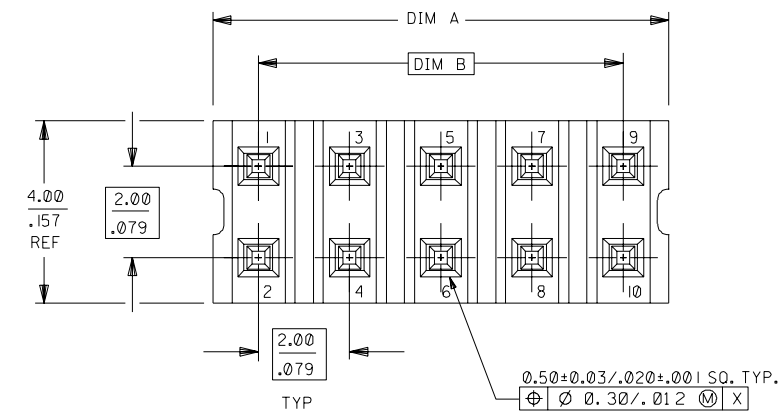

PART NUMBER LEGEND  
 87089- \* \* 9 1  
 CKT SIZE

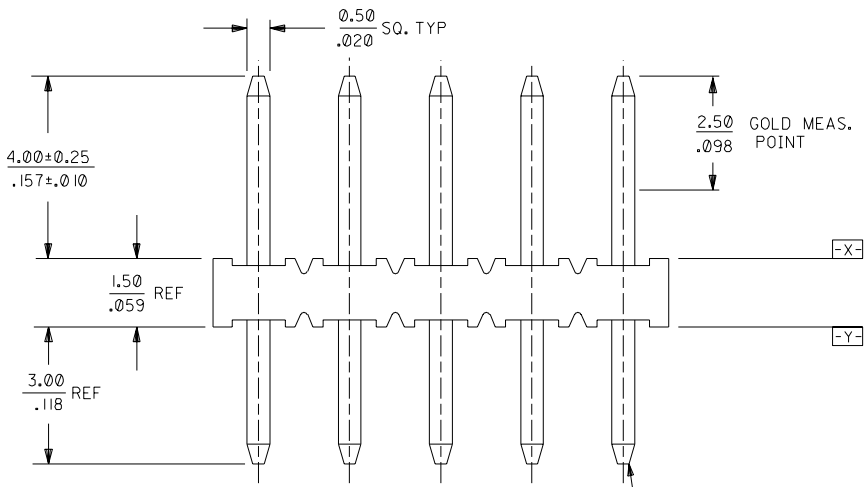

- NOTES:
- 1) 10 CKT SIZE SHOWN FOR ILLUSTRATION ONLY
  - 2) CKT I.D. NUMBERS ARE SHOWN FOR LOCATION IDENTIFICATION AND ARE NOT PRESENT ON MOLDED PARTS
  - 3) PLATING : 0.38um/15u" GOLD IN SELECTED AREA AND 1.90um/75u" MIN. TIN/LEAD IN SELECTED AREA OVER 1.27um/50u" MIN. NICKEL OVERALL

4) 4CKT & 6CKT SIZES ARE MADE BY CUTTING ASSEMBLY PART NOS. 87089-0891 & -1291. THE CUT END MUST NOT EXCEED THE TOLERANCE OF THE OVERALL LENGTH SPECIFIED.

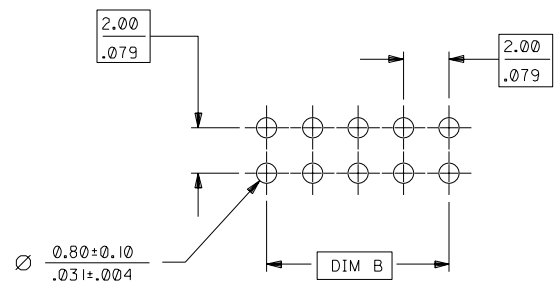

RECOMMENDED PCB PATTERN  
 (SCALE 5:1)

PART No.	CKT SIZE	DIM A		DIM B	
		MM	INCH	MM	INCH
87089-04**	4	3.90	.154	2.00	.079
87089-06**	6	5.90	.232	4.00	.157
87089-08**	8	7.90	.311	6.00	.236
87089-10**	10	9.90	.390	8.00	.315
87089-12**	12	11.90	.468	10.00	.394
87089-14**	14	13.90	.547	12.00	.472
87089-16**	16	15.90	.626	14.00	.551
87089-18**	18	17.90	.705	16.00	.630
87089-20**	20	19.90	.783	18.00	.709
87089-22**	22	21.90	.862	20.00	.787
87089-24**	24	23.90	.941	22.00	.866
87089-26**	26	25.90	1.020	24.00	.945
87089-28**	28	27.90	1.098	26.00	1.024
87089-30**	30	29.90	1.177	28.00	1.102
87089-32**	32	31.90	1.256	30.00	1.181
87089-34**	34	33.90	1.334	32.00	1.260
87089-36**	36	35.90	1.413	34.00	1.338
87089-38**	38	37.90	1.492	36.00	1.417
87089-40**	40	39.90	1.571	38.00	1.496
87089-42**	42	41.90	1.650	40.00	1.575
87089-44**	44	43.90	1.728	42.00	1.653
87089-46**	46	45.90	1.807	44.00	1.732
87089-48**	48	47.90	1.886	46.00	1.811
87089-50**	50	49.90	1.965	48.00	1.890

MATERIAL : HOUSING : 30% G.F NYLON 46 94V-0 COLOR BLACK PIN : 0.50mm SQ. PHOSPHOR BRONZE 510				MOLEX SINGAPORE PTE LTD SHEET 1 OF 1	
FINISH : SEE NOTE 3				GENERAL TOLERANCES ± 0.20/0.008 REV B1	
B1 ADD DIM. "A" ON CKT 6 & 4 S50392 JACK 950215		B ADD CKT SIZE MXS-PDR-1344 S40048 JACK 930727		DWG. NO. : SD 1 87089-**-91	
A RELEASE TO TOOLING S30302 JACK 921130		LTR REVISION RECORD ECN DR CHK DATE		DRAWN BY : J.WAN 921130 APPR'D BY : R.WONG 921202	
REVISE ONLY ON CAD SYSTEM				TITLE : "MILLI-GRID" 2mm VERTICAL HEADER	

DO NOT SCALE DRAWING