

## SUMMARY

### # Wires

Low voltage 65



*Image is for illustrative purpose only*

Series 1R  
Termination type Female crimp  
IP rating 50  
AWG wire size 32.00 - 28.00  
Cable Ø 2.00 - 9.20 mm  
Status active  
Matching parts [FGG.1R.365.GLC92](#)

### Download

[Request a quote](#)

[Catalog](#)

## TECHNICAL DETAILS

### Mechanics

Shell Style/Model EBG\*: Fixed receptacle, key (G) or key (A) with visible shell  
Keying 3 keys (alpha=50,beta=30, plug: male contacts, receptacle: female contacts)  
Housing Material Crastin® PBT (Polybutylene terephthalate), gray  
Weight 16.86 g

### Performance

Configuration 1R.365 : 65 low voltage  
Insulator L: PEEK (UL 94 / V-0/1.5)  
Rated Current 0.5 Amps

### Specifications

Contact Type: Crimp  
Test voltage (kV rms) Contact-contact: 0.6

### Others

*LEMO products and services are provided "as is". LEMO makes no warranties or representations with regard to LEMO product & services or use of them, express, implied or statutory, including for accuracy, completeness, or security. The user is fully responsible for his products and applications using LEMO components.*

# DRAWINGS

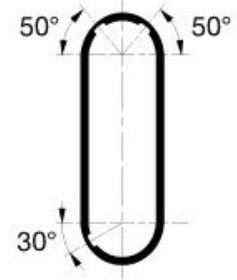
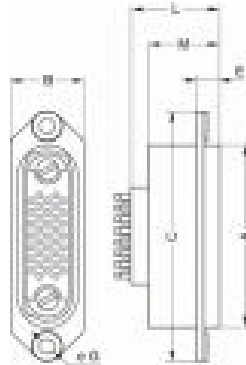

## Dimensions

	A	B	C	E	G	L	M
mm.	37	15	51	4.5	3.2	19.5	14.5
in.	1,46	0,59	2,01	0,18	0,13	0,77	0,57

# RECOMMENDED BY LEMO

## Tools

- Crimp Tool: [DPC.91.701.V](#)  
Crimp settings: AWG/Selector = 28-30-32/4-3-3  
Positionner: [DCE.91.051.BVM](#)  
Extractor: [DCC.05.02B.LAG](#)  
Replacement contact: EGG.00.654.ZZM

LEMO products and services are provided "as is". LEMO makes no warranties or representations with regard to LEMO product & services or use of them, express, implied or statutory, including for accuracy, completeness, or security. The user is fully responsible for his products and applications using LEMO components.