

Inductive sensor

NBB2-V3-US

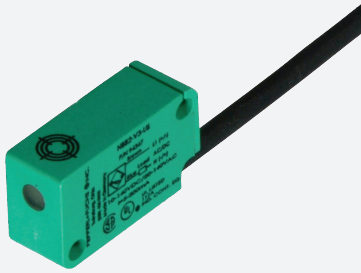

- Sensing range 2 mm
- 2-wire AC/DC



Dimensions

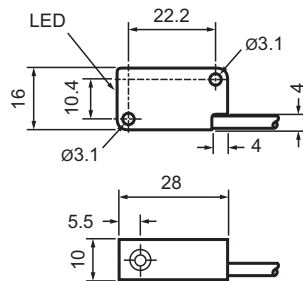

Technical Data

General specifications

Switching function		Normally open (NO)
Output type		Two-wire
Rated operating distance	s_n	2 mm
Installation		flush mountable
Output polarity		AC/DC

Release date: 2020-03-20 Date of issue: 2020-03-30 Filename: 094347_eng.pdf

Refer to "General Notes Relating to Pepperl+Fuchs Product Information".

Pepperl+Fuchs Group
www.pepperl-fuchs.com

USA: +1 330 486 0001
fa-info@us.pepperl-fuchs.com

Germany: +49 621 776 1111
fa-info@de.pepperl-fuchs.com

Singapore: +65 6779 9091
fa-info@sg.pepperl-fuchs.com

 PEPPERL+FUCHS

Technical Data

Reduction factor r_{Al}		0.5
Reduction factor r_{Cu}		0.46
Reduction factor r_{304}		0.9
Reduction factor r_{Si37}		1
Reduction factor r_{Brass}		0.8
Nominal ratings		
Operating voltage DC	U_B	10 ... 140 V
Operating voltage AC	U_B	20 ... 140 V
Switching frequency	f	25 Hz
Reverse polarity protection		no
Short-circuit protection		no
Voltage drop	U_d	≤ 7 V
Operating current	I_L	5 ... 200 mA max
Off-state current	I_r	≤ 0.8 mA
Switching state indicator		LED, red
Compliance with standards and directives		
Standard conformity		
Standards		EN 60947-5-2:2007 EN 60947-5-2/A1:2012 IEC 60947-5-2:2007 IEC 60947-5-2 AMD 1:2012
Ambient conditions		
Ambient temperature		-25 ... 70 °C (-13 ... 158 °F)
Mechanical specifications		
Connection type		cable PUR , 2 m
Core cross-section		0.25 mm ²
Housing material		PBT
Sensing face		PBT
Degree of protection		IP67

Connection

