

PLUG P/N	CKT	DIM "A"	DIM "B"	DIM "C"	DIM "D"
2004882002	2	9.60	10.00	15.00	4.95
2004882003	3	13.80	14.20	19.20	4.95
2004882004	4	18.00	18.40	23.40	4.95
2004882005	5	22.20	22.60	27.60	12.95
2004882006	6	26.40	26.80	31.80	12.95

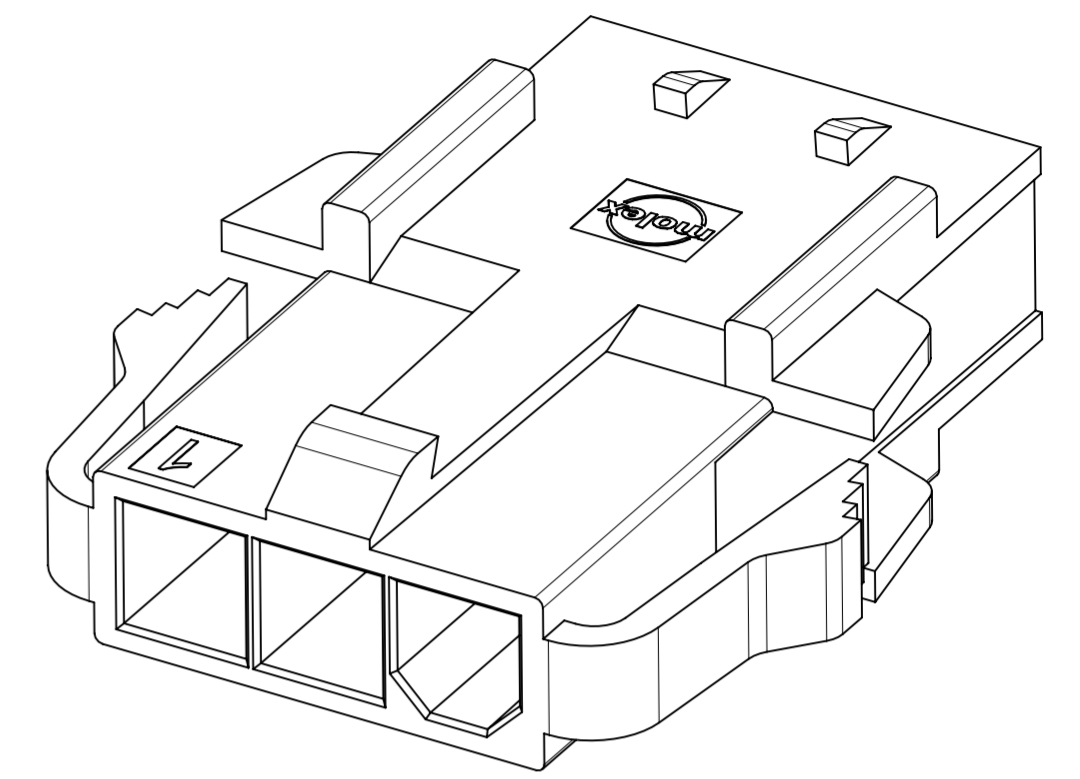

MOLEX LOGO DIM "D" REF

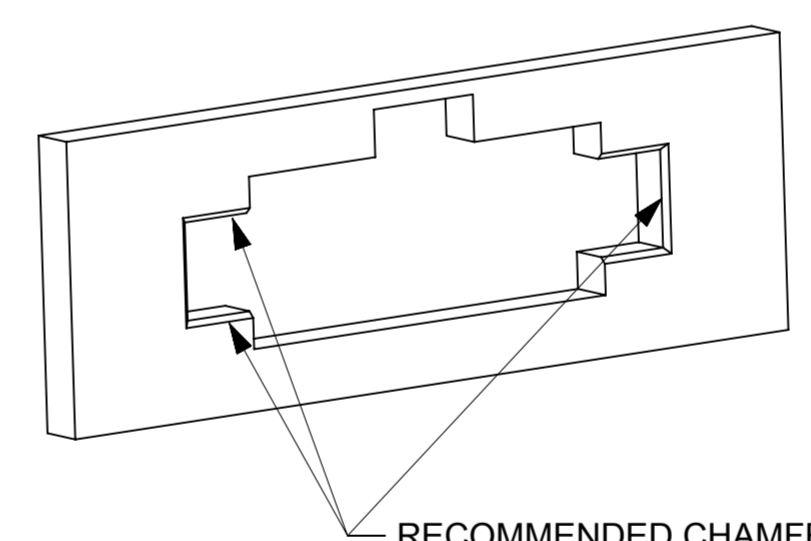
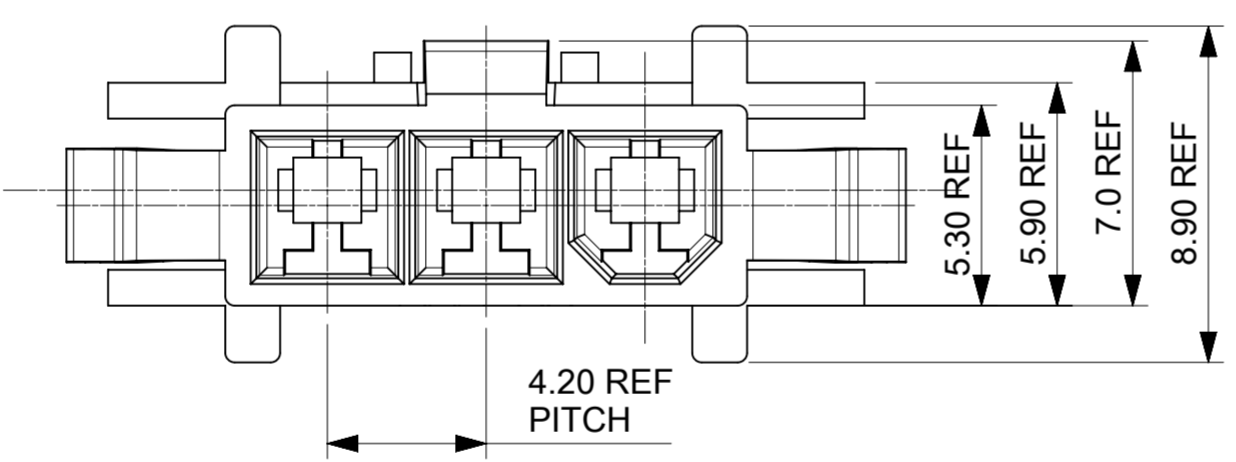
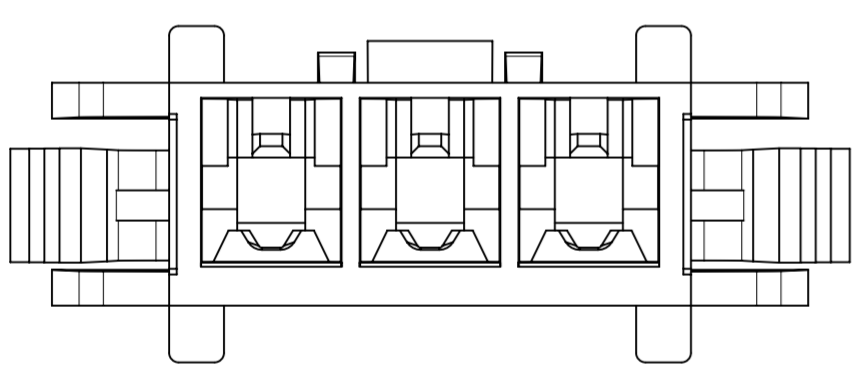

RECOMMENDED CHAMFER
C0.20~0.30 AT INSERTION SIDE

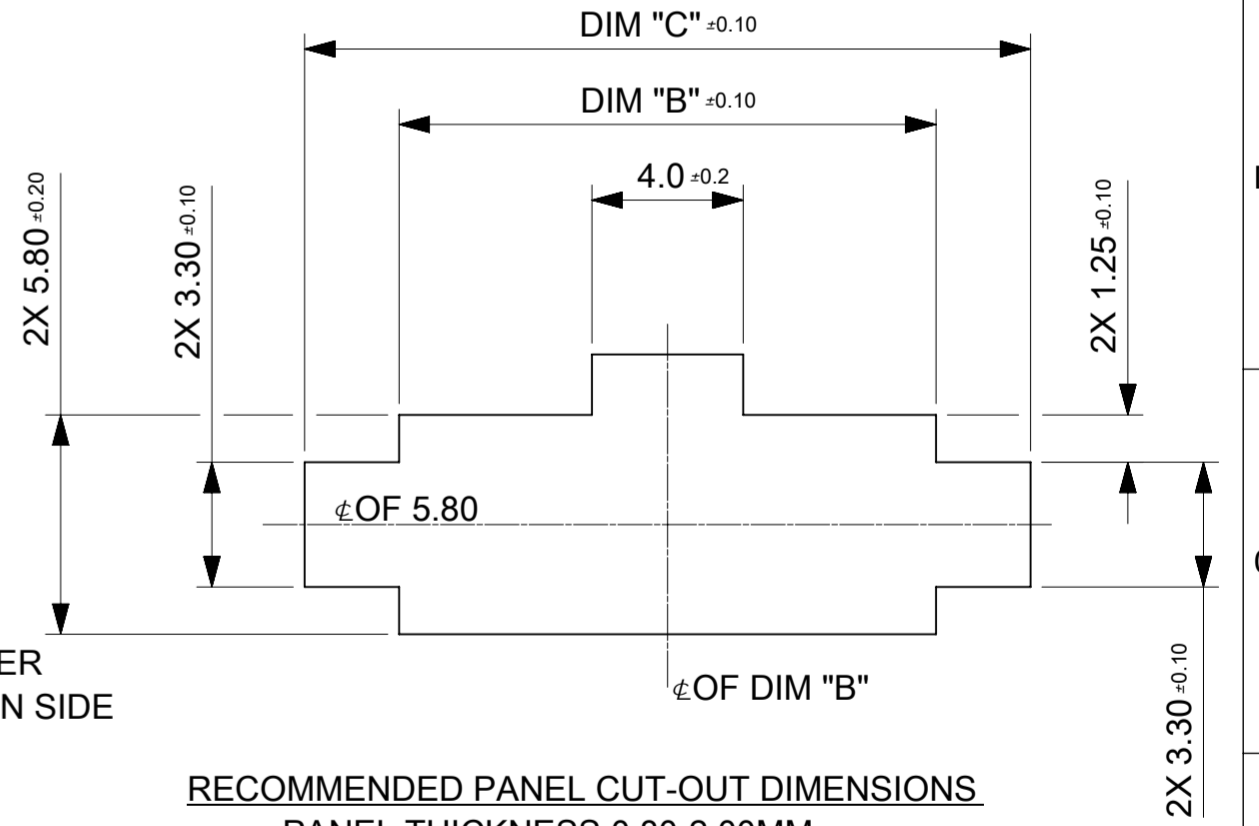

RECOMMENDED PANEL CUT-OUT DIMENSIONS
PANEL THICKNESS 0.80-2.00MM

- NOTES:
- MATERIAL:
NYLON, UL 94V-0 AND GLOW WIRE CAPABLE PER IEC60335-1; COLOR: BLACK
 - FINISH: NONE
 - PRODUCT SPECIFICATION: 2131370000-PS/2029880002-PS
APPLICATION SPECIFICATION: 2131370000-AS
 - PACKAGING SPECIFICATION: 200488-0001-PK
REFER TO AS-45499-001 FOR MOISTURIZING NYLON CONNECTOR PARTS.
 - THIS PART TO BE USED WITH FEMALE TERMINAL SERIES 172765, 203070 AND TPA SERIES 172709-2***.
 - THIS PART MATES WITH RECEPTACLE SERIES 200453-1***
 - THIS PART CONFORMS TO CLASS 'B' REQUIREMENTS OF COSMETIC SPECIFICATION PS-45499-002.
 - SEE DRAWING 1727090002-SD FOR OTHER TPA INFORMATION.
 - SEE DRAWING 2004531000(SD) FOR OTHER RECEPTACLE INFORMATION.
 - SEE DRAWINGS SD-172718-0000 AND 2029880001-PSD FOR OTHER CRIMP TERMINAL INFORMATION.

FUNCTIONAL SYMBOLS	THIS DRAWING CONTAINS INFORMATION THAT IS PROPRIETARY TO MOLEX ELECTRONIC TECHNOLOGIES, LLC AND SHOULD NOT BE USED WITHOUT WRITTEN PERMISSION		CURRENT REV DESC:	
$\frac{F}{A} = 0$	DIMENSION UNITS	SCALE		
$\frac{F}{C} = 0$	mm	5:1		
$\frac{F}{P} = 0$	GENERAL TOLERANCES (UNLESS SPECIFIED)			
	ANGULAR TOL	± °		
	4 PLACES	±	EC NO: 653179	
	3 PLACES	±	DRWN: ALUO02	2021/01/15
	2 PLACES	± 0.25	CHK'D: YXZHENG	2021/01/18
	1 PLACE	± 0.36	APPR: YXZHENG	2021/01/18
	0 PLACES	±	INITIAL REVISION:	
	DRAFT WHERE APPLICABLE MUST REMAIN WITHIN DIMENSIONS		DRWN: ALUO02	2019/09/24
	THIRD ANGLE PROJECTION		APPR: YXZHENG	2019/10/11
	DRAWING	SERIES	MATERIAL NUMBER	CUSTOMER
	A2-SIZE	200488	SEE TABE	GENERAL MARKET
			DOCUMENT NUMBER	DOC TYPE DOC PART REVISION
			2004880001-SD	PSD 000 B1
				SHEET NUMBER
				1 OF 2

DOCUMENT STATUS	P1	RELEASE DATE	2021/01/18	01:45:38

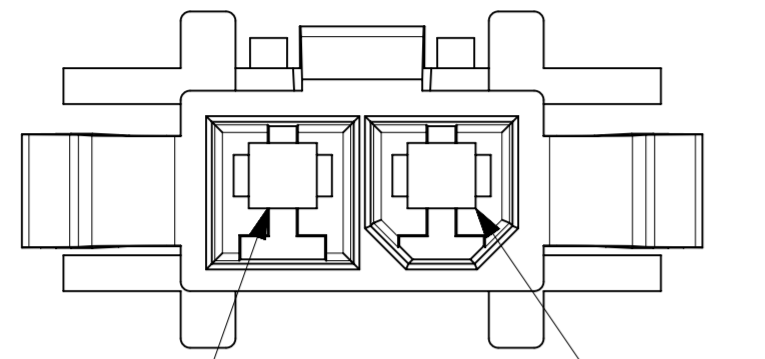

1 CKT 2 CKT
2-CKT

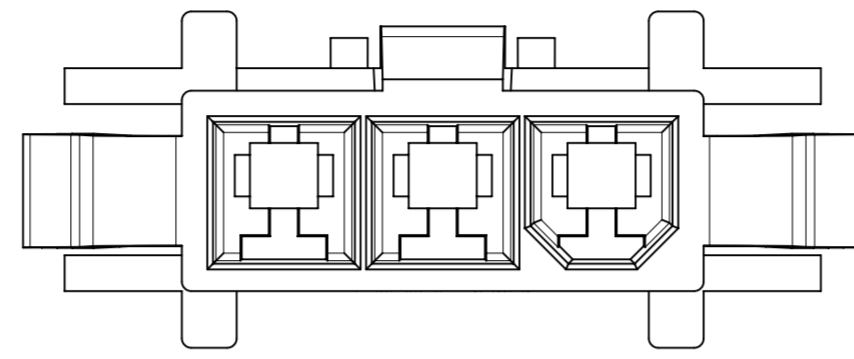

3-CKT

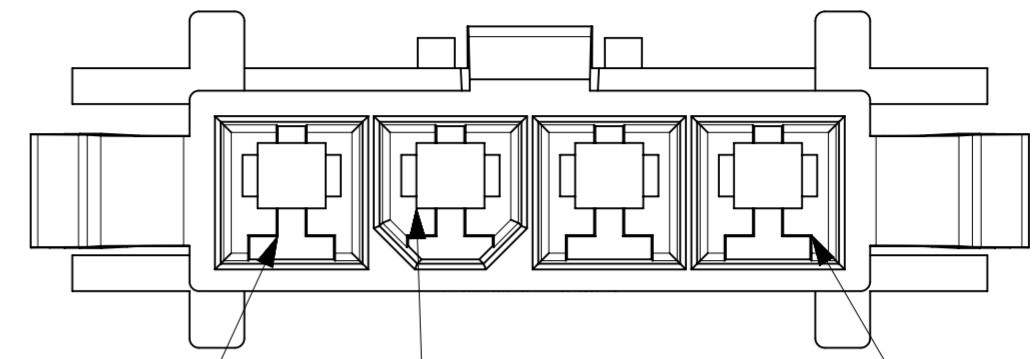

1 CKT 2 CKT LAST CKT
4-CKT

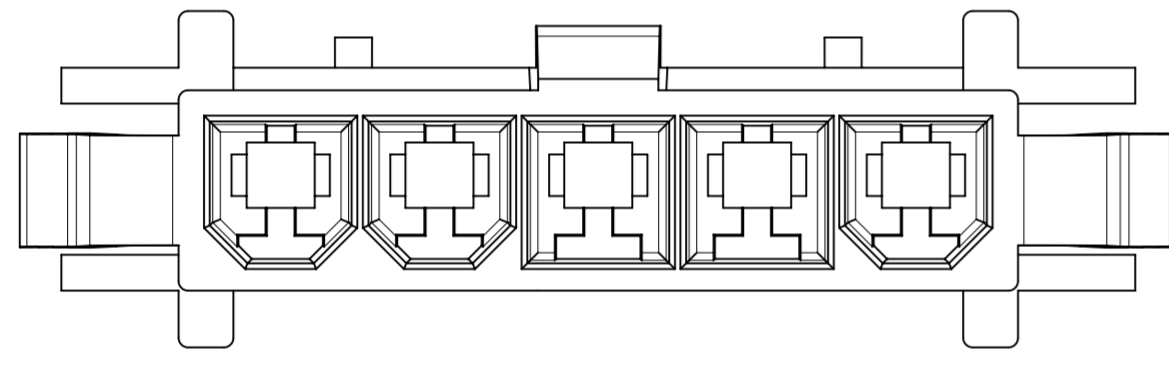

5-CKT

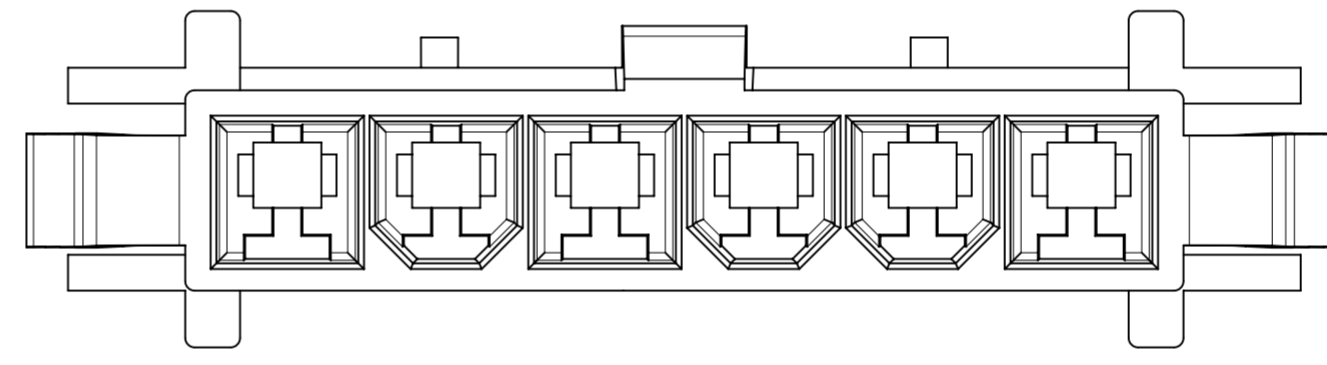

6-CKT

FUNCTIONAL SYMBOLS $\nabla_A = 0$ $\nabla_C = 0$ $\nabla_P = 0$ DIVISIONAL SYMBOLS	THIS DRAWING CONTAINS INFORMATION THAT IS PROPRIETARY TO MOLEX ELECTRONIC TECHNOLOGIES, LLC AND SHOULD NOT BE USED WITHOUT WRITTEN PERMISSION		<div style="text-align: center;">molex</div> SD-DRAWING OF MINI-FIT SIGMA SR PLUG				
	DIMENSION UNITS	SCALE					PRODUCT CUSTOMER DRAWING
	mm	5:1	EC NO: 653179	2021/01/15	DOC TYPE	DOC PART	REVISION
	GENERAL TOLERANCES (UNLESS SPECIFIED)		DRWN: ALU002	2021/01/18	PSD	000	B1
ANGULAR TOL ± °		CHK'D: YXZHENG	2021/01/18	DOCUMENT NUMBER			
4 PLACES ±		APPR: YXZHENG	2021/01/18	2004880001-SD			
3 PLACES ±		INITIAL REVISION:	2019/09/24	MATERIAL NUMBER			
2 PLACES ± 0.25		DRWN: ALU002	2019/10/11	CUSTOMER			
1 PLACE ± 0.36		APPR: YXZHENG		GENERAL MARKET			
0 PLACES ±		DRAFT WHERE APPLICABLE MUST REMAIN WITHIN DIMENSIONS	THIRD ANGLE PROJECTION	DRAWING	SERIES	SHEET NUMBER	
				A2-SIZE	200488	2 OF 2	