

TECHNICAL SPECIFICATIONS

D-Sub Hood:

Material: Zinc, Nickel Plated
 Operating Temperature: -40°C to +120°C
 Cable Entry: Side Entry 35°
 Thumbscrews: UNC 4-40 (Standard)
 Cable O.D: Up to 13mm

Female D-Sub Solder Cup:

Insulator: PBT, Black, UL94 V-0
 Shell: Steel, Tin Plated
 Contact pins: Copper Alloy
 Stamped & Formed Pins: Class 3, 100 inserts min.
 Machined Contact Pins: Class 1, 500 inserts min.
 Contact Plating: Selective Gold over Nickel
 Operating Temperature: -55°C to +105°C
 Withstanding voltage: 1000V for 1 minute
 Insulator resistance: 1000MΩ min

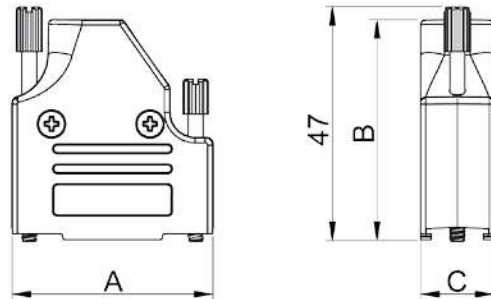

Features:

- Available in sizes 9-15-25-37
- 360° EMI Shielding
- Quick assembly
- Supports all types of cables
- Suitable for any common D-Sub connector

| Size MHDM35 | Dim A | Dim B | Dim C |
|-------------|-------|-------|-------|
| 9-way | 43,0 | 32,0 | 15,5 |
| 15-way | 43,0 | 40,4 | 15,5 |
| 25-way | 48,0 | 54,0 | 15,5 |
| 37-way | 53,0 | 70,5 | 15,5 |

Ordering information - Black Insulator:

| Size: | P/N - Kitted: | Class 3 - 100 inserts min. |
|--------|---------------|----------------------------|
| 9-way | 6355-0007-11 | MHDM35-09-DBS-K |
| 15-way | 6355-0007-12 | MHDM35-15-DBS-K |
| 25-way | 6355-0007-13 | MHDM35-25-DBS-K |
| 37-way | 6355-0007-14 | MHDM35-37-DBS-K |

| Size: | P/N - Kitted: | Class 1 - 500 inserts min. |
|--------|---------------|----------------------------|
| 9-way | 6355-0008-11 | MHDM35-09-DMS-K |
| 15-way | 6355-0008-12 | MHDM35-15-DMS-K |
| 25-way | 6355-0008-13 | MHDM35-25-DMS-K |
| 37-way | 6355-0008-14 | MHDM35-37-DMS-K |

Ordering information - White Insulator:

| Size: | P/N - Kitted: | Class 3 - 100 inserts min. |
|--------|---------------|----------------------------|
| 9-way | 6355-8007-11 | MHDM35-09-DBS-W-K |
| 15-way | 6355-8007-12 | MHDM35-15-DBS-W-K |
| 25-way | 6355-8007-13 | MHDM35-25-DBS-W-K |
| 37-way | 6355-8007-14 | MHDM35-37-DBS-W-K |

| Size: | P/N - Kitted: | Class 1 - 500 inserts min. |
|--------|---------------|----------------------------|
| 9-way | 6355-8008-11 | MHDM35-09-DMS-W-K |
| 15-way | 6355-8008-12 | MHDM35-15-DMS-W-K |
| 25-way | 6355-8008-13 | MHDM35-25-DMS-W-K |
| 37-way | 6355-8008-14 | MHDM35-37-DMS-W-K |

