

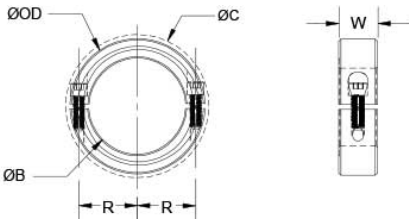

MSPH-95-SS

Ruland MSPH-95-SS, 95mm Heavy Duty Shaft Collar, 303 Stainless Steel, Two-Piece Clamp Style, 140mm OD, 32mm Width



Description

Ruland MSPH-95-SS is a two-piece heavy duty shaft collar with a 95mm bore, 140mm OD, and 32mm width. The clamp style design does not mar the shaft, is easy to remove, and is indefinitely adjustable. It is commonly used for guiding, spacing, stopping, mounting, and component alignment. Equipment manufacturers benefit from the tightly controlled face to bore perpendicularity of Ruland shaft collars, TIR of ± 0.05 mm. Perpendicularity is critical for alignment when the shaft collar is used as a load bearing face, mechanical stop, or for mounting components such as gears or bearings. Proprietary processes have been developed by Ruland to maintain superior fit, finish, and holding power. MSPH-95-SS is stamped with the Ruland name and bore size for ease of identification. This heavy duty shaft collars have larger ODs and screws for higher holding power. Halves are mated throughout the manufacturing process for proper fit and alignment. Forged screws test beyond DIN 912 12.9 standards to ensure maximum holding power. MSPH-95-SS is manufactured from solid bar stock sourced from select North American mills and machined to a fine burr free finish. Ruland uses 303 stainless steel with hardware of like material for consistent corrosion resistance. Stainless steel hardware undergoes a proprietary surface treatment process to prevent galling. MSPH-95-SS is RoHS3 and REACH compliant and manufactured in our Marlborough, MA factory under strict controls using proprietary processes.

Product Specifications

Bore (B)	95 mm	Bore Tolerance	+0.102 mm / -0.000 mm
Outer Diameter (OD)	140 mm	Clearance Diameter (C) MAX	149.9 mm
Width (W)	32 mm	Width Tolerance	+0.076 mm / -0.254 mm
Recommended Gap	3.18 mm	Recommended Shaft Tolerance	+0.000 mm / -0.025 mm
Forged Clamp Screw	M12 x 40	Screw Material	18-8 300 Series Stainless Steel
Hex Wrench Size	10.0 mm	Screw Finish	Bright
Seating Torque	81 Nm	Screw Location (R)	61.50 mm
Number of Screws	2 ea	Axial Load	22240 N
Material Specification	Type 303 Austenitic, Non-Magnetic Bar	Finish Specification	Bright, No Plating
Manufacturer	Ruland Manufacturing	Country of Origin	USA
Temperature	-40°F to 350°F (-40°C to 176°C)	Weight (lbs)	4.280000
Tariff Code	8483.60.8000	UNSPC	31162811
Note 1	Performance ratings are for guidance only. The user must determine suitability for a particular application.		
Prop 65	⚠ WARNING This product can expose you to the chemical Nickel (metallic), known to the State of California to cause cancer. For more information go to www.P65Warnings.ca.gov .		

Installation Instructions

1. Use the MSPH-95-SS heavy duty shaft collar as it is received.
2. Wipe the bore clean.
3. Apply a thin coat of light oil to the shaft.
4. Place the collar onto the desired shaft location and tighten it using a 10.0 mm hex wrench until a slight resistance is felt.
5. Be sure to maintain the gap of 3.18 mm between the two halves of the collar during installation.
6. Wring collar into its final position and tighten the screw to the full recommended seating torque of 81 Nm using a 10.0 mm torque wrench.