

ASSEMBLY PART NO.	PACKAGING SPECIFICATION
151214-1118	PK-151214-0002 (TRAY)
151214-2118	PK-151214-0001 (TUBE)
151214-3118	PK-151214-0003 (TAPE & REEL)

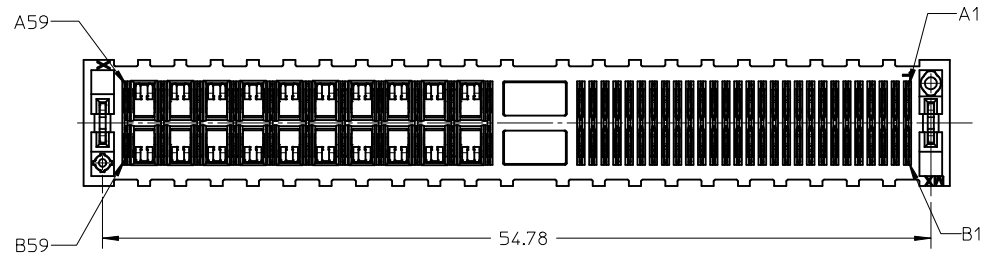
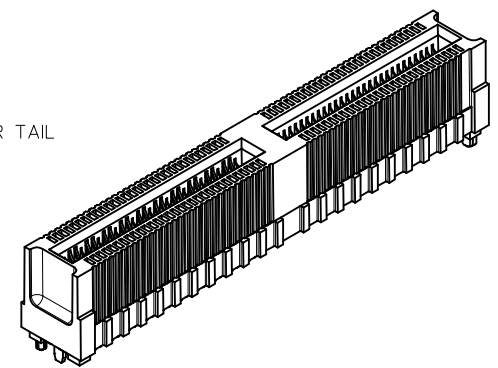
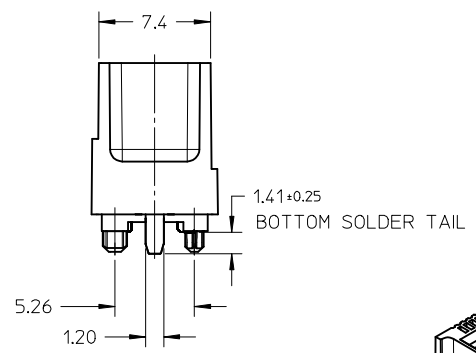
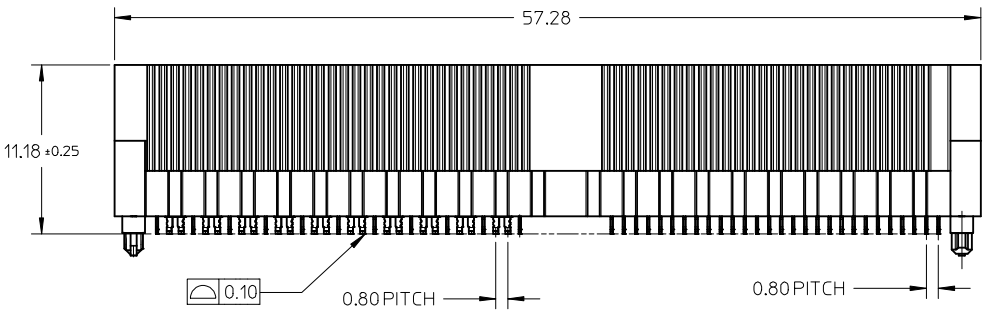

- NOTES:
- MATERIAL:
HOUSING - GLASS FILLED THERMOPLASTIC, 94-V0, BLACK
TERMINALS - HIGH PERFORMANCE COPPER ALLOY
 - FINISH:
CONTACT AREA: SELECT GOLD 0.76µm MIN
SOLDER TAIL: 2.54µm MIN TIN (MATTE)
UNDERPLATE: 1.27µm MIN NICKEL ALL OVER
 - PRODUCT SPECIFICATION: PS-151214-0001.
 - PACKAGING SPECIFICATION: REFER TO TABLE
 - APPLICATION SPECIFICATION: AS-151214-0001.
 - MATING PC BOARD THICKNESS = 1.60±0.16MM OVER CONTACT PADS.
 - PRODUCT IS ELV AND RoHS COMPLIANT. LEVEL OF COMPLIANCE: 6/6
ALL BANNED SUBSTANCES ARE REMOVED:
Pb (LEAD)/ HEXAVALENT CHROMIUM (CrVI)/CADMIUM
MERCURY/ POLYBROMINATED BIPHENYL (PBB)
POLYBROMINATED DIPHENYL ETHER (PBDE)
 - THIS PART CONFORMS TO CLASS B REQUIREMENTS OF COSMETIC SPEC PS-45499-002
 - COPLANARITY OF SOLDER TAIL NOT EXCEED 0.10MM

ADDED T&R OPTION EC NO: S2017-0446 DRWN:CTEH 2017/03/08 CHKD:CGTAN 2017/03/21 APPR:SHLENI 2017/03/21	QUALITY SYMBOLS F _A =0 F _G =0 F _P =0	GENERAL TOLERANCES (UNLESS SPECIFIED)		DIMENSION STYLE	SCALE	DESIGN UNITS	THIRD ANGLE PROJECTION
		mm	INCH	MM ONLY	NTS	METRIC	
2	DESCRIPTION	4 PLACES	± --- ± ---	DRAWN BY	DATE	TITLE	SALES DRAWING EDGELINE25 850HM 118CKTS SMT
		3 PLACES	± --- ± ---	WZHA021	2016/10/06		
2	DESCRIPTION	2 PLACES	± 0.13 ± ---	CHECKED BY	DATE		molex
		1 PLACE	± 0.25 ± ---	WZHA021	2016/10/06		
2	DESCRIPTION	0 PLACE	± --- ± ---	APPROVED BY	DATE		SD-151214-0118
				SHLENI	2016/11/14		
ANGULAR ± 5 °		DRAFT WHERE APPLICABLE MUST REMAIN WITHIN DIMENSIONS		MATERIAL NO.	DOCUMENT NO.		SHEET NO.
				SEE TABLE	SD-151214-0118		1 OF 3
THIS DRAWING CONTAINS INFORMATION THAT IS PROPRIETARY TO MOLEX INCORPORATED AND SHOULD NOT BE USED WITHOUT WRITTEN PERMISSION							

10 9 8 7 6 5 4 3 2 1

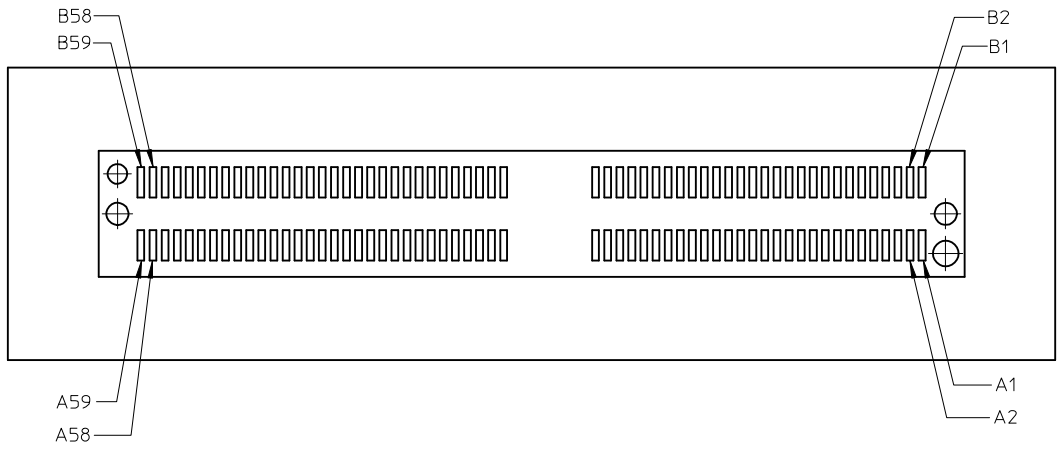
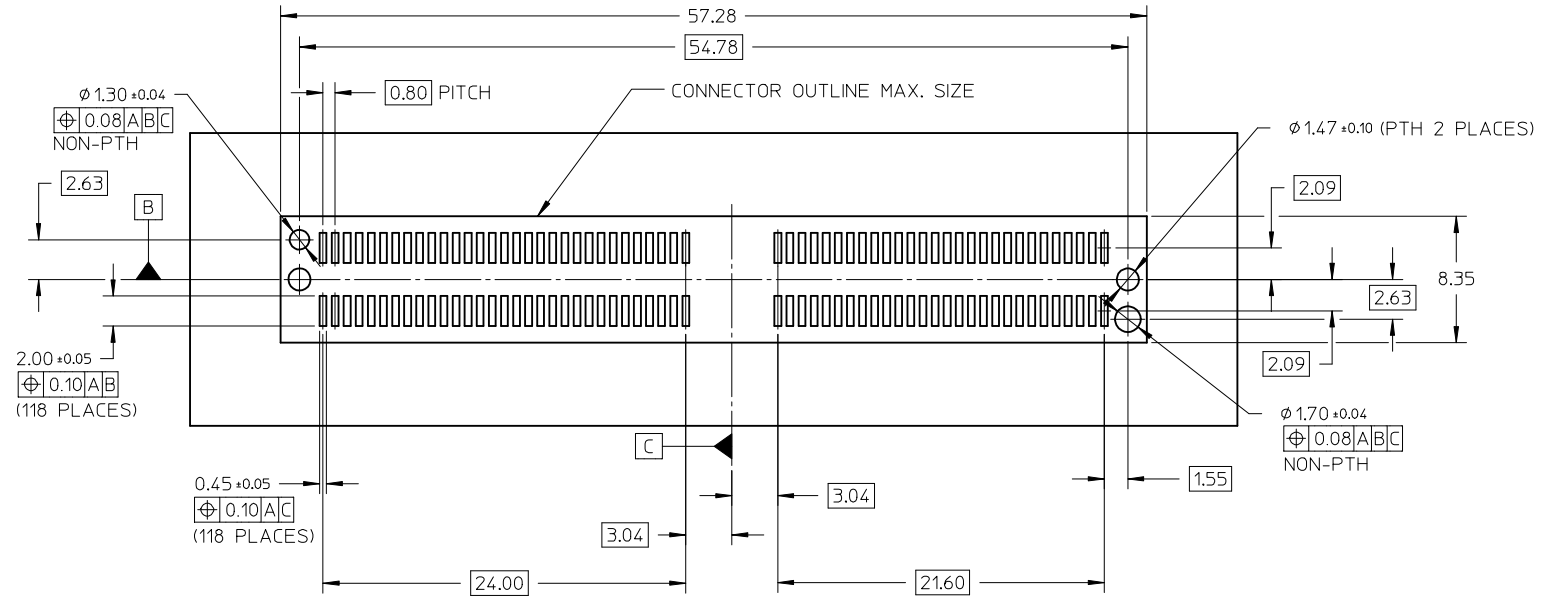

NOTES:
1. DATUM A IS THE TOP OF THE PCB.

ADDED T&R OPTION	EC NO: S2017-0446	2017/03/08
	DRWN: CTEH	2017/03/21
	CHKD: GTAN	2017/03/21
	APPR: SHLENI	2017/03/21

QUALITY SYMBOLS	DESCRIPTION
$F_A=0$	
$F_G=0$	
$F_P=0$	

GENERAL TOLERANCES (UNLESS SPECIFIED)	
	mm INCH
4 PLACES	± --- ± ---
3 PLACES	± --- ± ---
2 PLACES	± 0.13 ± ---
1 PLACE	± 0.25 ± ---
0 PLACE	± --- ± ---
ANGULAR ± 5 °	
DRAFT WHERE APPLICABLE MUST REMAIN WITHIN DIMENSIONS	

DIMENSION STYLE	
MM ONLY	
DRAWN BY	DATE
WZHA021	2016/10/06
CHECKED BY	DATE
WZHA021	2016/10/06
APPROVED BY	DATE
SHLENI	2016/11/14
MATERIAL NO.	
SEE TABLE	
SIZE	A3

SCALE	NTS	DESIGN UNITS	METRIC	THIRD ANGLE PROJECTION
TITLE				
SALES DRAWING EDGELINE25 85OHM 118CKTS SMT				
molex				
DOCUMENT NO.				SHEET NO.
SD-151214-0118				2 OF 3
THIS DRAWING CONTAINS INFORMATION THAT IS PROPRIETARY TO MOLEX INCORPORATED AND SHOULD NOT BE USED WITHOUT WRITTEN PERMISSION				

9 8 7 6 5 4 3 2 1

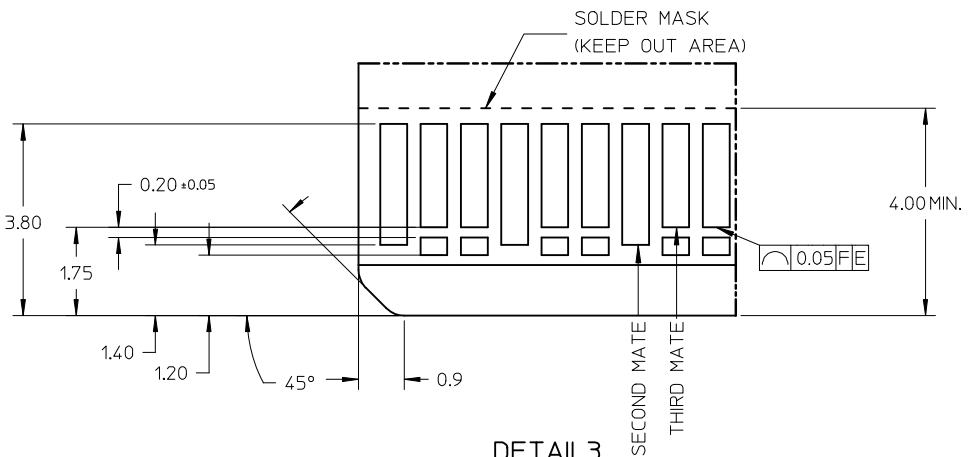
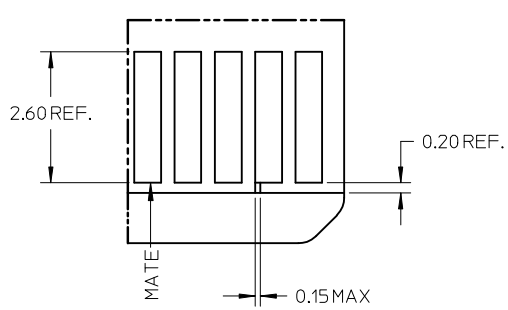
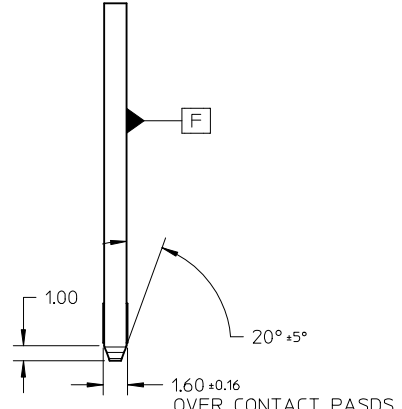
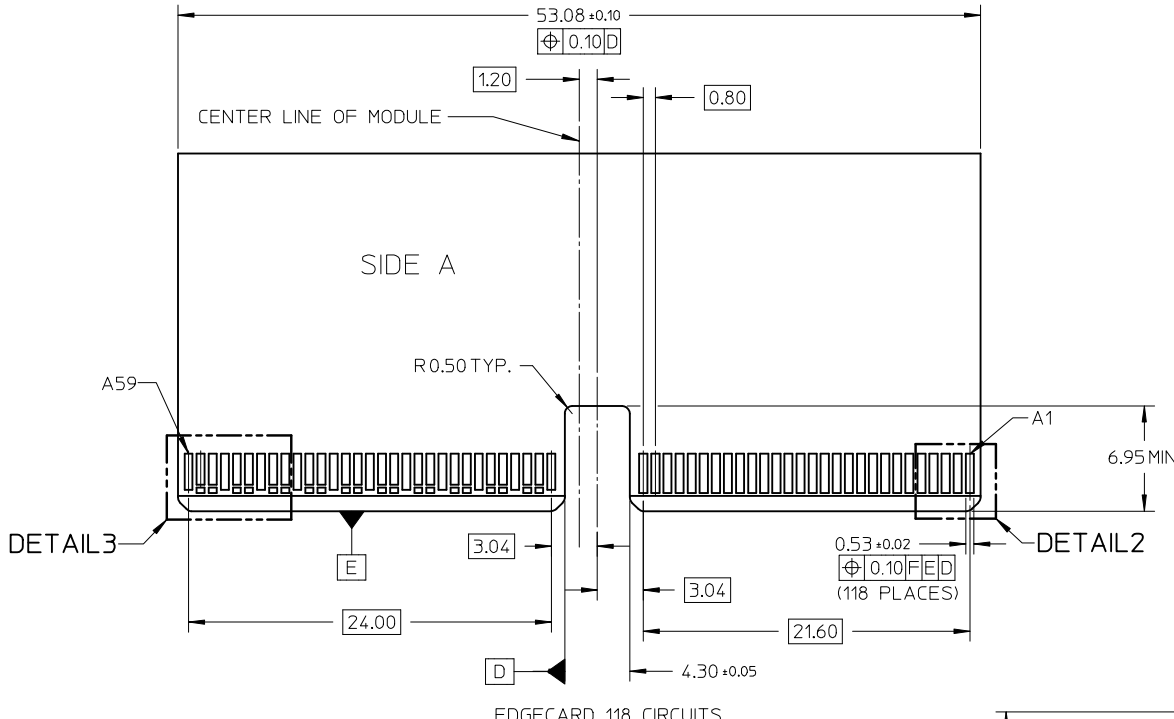

DETAIL 2
 RECOMMENDED TIE BAR SIZE

NOTE:
 1. THESE ARE GENERIC DETAILS THAT DESCRIBES THE CONFIGURATION OF VARIOUS PCB DESIGN ELEMENTS. THE CUSTOMER MUST DETERMINE WHERE AND WHEN TO USE EACH ELEMENT TO ACCOMMODATE THEIR SPECIFIC APPLICATION.
 2. CHAMFER ROUGHNESS NOT TO EXCEED 3.17µM
 3. EDGE CARD CHAMFER NOT TO GO THRU GOLD PAD.

ADDED T&R OPTION EC NO: S2017-0446 DRW: CTEH 2017/03/08 CHKD: CGTAN 2017/03/21 APPR: SHLENI 2017/03/21	QUALITY SYMBOLS $\nabla_A = 0$ $\nabla_C = 0$ $\nabla_B = 0$	GENERAL TOLERANCES (UNLESS SPECIFIED)		DIMENSION STYLE		SCALE	DESIGN UNITS	THIRD ANGLE PROJECTION		
				MM ONLY		NTS	METRIC			
			mm	INCH	DRAWN BY	DATE	TITLE			
		4 PLACES	± ---	± ---	WZHA021	2016/10/06	SALES DRAWING EDGELINE25 850HM 118CKTS SMT			
3 PLACES	± ---	± ---	CHECKED BY	DATE						
2 PLACES	± 0.13	± ---	WZHA021	2016/10/06	molex DOCUMENT NO. SD-151214-0118 SHEET NO. 3 OF 3					
1 PLACE	± 0.25	± ---	APPROVED BY	DATE						
0 PLACE	± ---	± ---	SHLENI	2016/11/14						
		ANGULAR ± 5 °		MATERIAL NO.						
		DRAFT WHERE APPLICABLE MUST REMAIN WITHIN DIMENSIONS		SEE TABLE						
				SIZE A3		THIS DRAWING CONTAINS INFORMATION THAT IS PROPRIETARY TO MOLEX INCORPORATED AND SHOULD NOT BE USED WITHOUT WRITTEN PERMISSION				

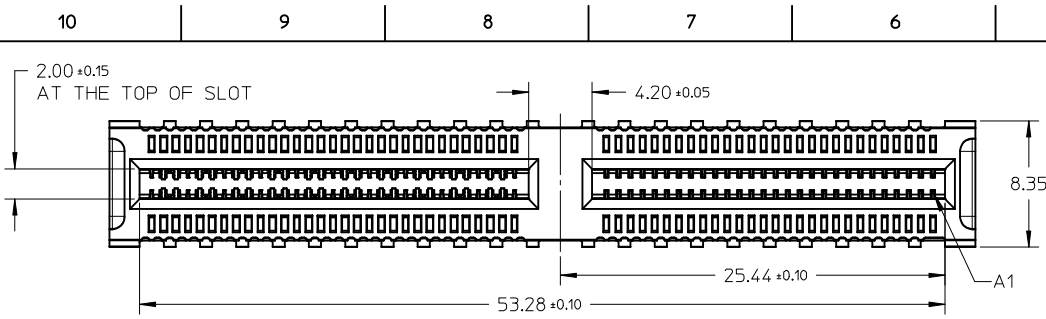

ASSEMBLY PART NO.	PACKAGING SPECIFICATION
151214-1118	PK-151214-0002 (TRAY)
151214-2118	PK-151214-0001 (TUBE)
151214-3118	PK-151214-0003 (TAPE & REEL)

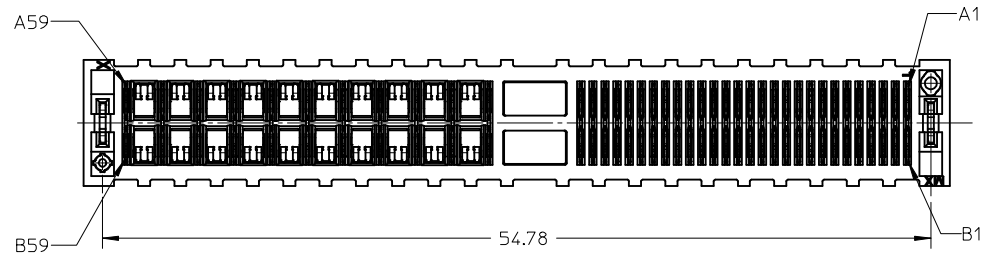
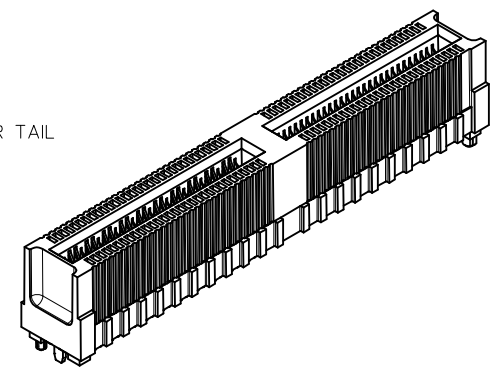
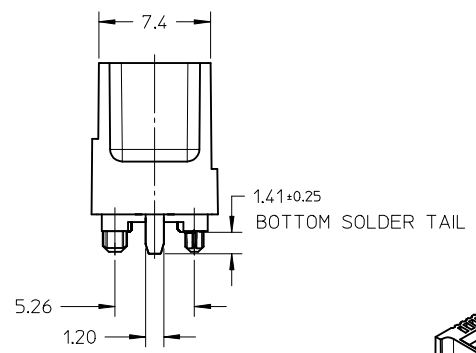
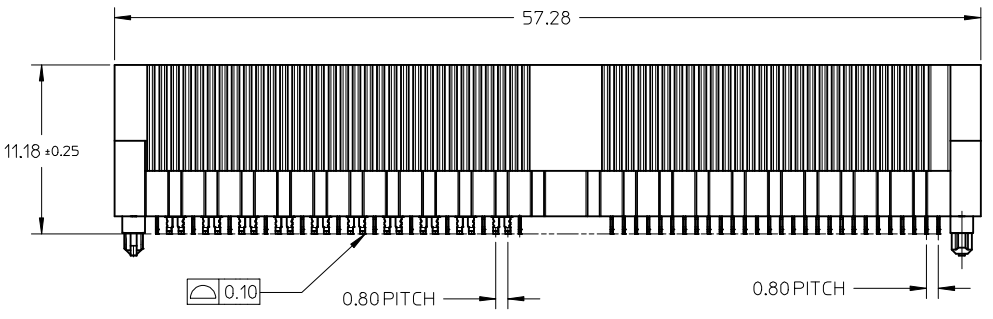

- NOTES:
- MATERIAL:
HOUSING - GLASS FILLED THERMOPLASTIC, 94-V0, BLACK
TERMINALS - HIGH PERFORMANCE COPPER ALLOY
 - FINISH:
CONTACT AREA: SELECT GOLD 0.76µm MIN
SOLDER TAIL: 2.54µm MIN TIN (MATTE)
UNDERPLATE: 1.27µm MIN NICKEL ALL OVER
 - PRODUCT SPECIFICATION: PS-151214-0001.
 - PACKAGING SPECIFICATION: REFER TO TABLE
 - APPLICATION SPECIFICATION: AS-151214-0001.
 - MATING PC BOARD THICKNESS = 1.60±0.16MM OVER CONTACT PADS.
 - PRODUCT IS ELV AND RoHS COMPLIANT. LEVEL OF COMPLIANCE: 6/6
ALL BANNED SUBSTANCES ARE REMOVED:
Pb (LEAD)/ HEXAVALENT CHROMIUM (CrVI)/CADMIUM
MERCURY/ POLYBROMINATED BIPHENYL (PBB)
POLYBROMINATED DIPHENYL ETHER (PBDE)
 - THIS PART CONFORMS TO CLASS B REQUIREMENTS OF COSMETIC SPEC PS-45499-002
 - COPLANARITY OF SOLDER TAIL NOT EXCEED 0.10MM

ADDED T&R OPTION EC NO: S2017-0446 DRW: NCTEH 2017/03/08 CHKD: CGTAN 2017/03/21 APPR: SHLENI 2017/03/21	QUALITY SYMBOLS $F_A=0$ $F_G=0$ $F_P=0$	GENERAL TOLERANCES (UNLESS SPECIFIED)		DIMENSION STYLE MM ONLY		SCALE NTS	DESIGN UNITS METRIC	THIRD ANGLE PROJECTION
		mm	INCH	DRAWN BY	DATE	TITLE	SALES DRAWING EDGE LINE 25 850HM 118CKTS SMT 	
4 PLACES	± ---	± ---	WZHA021	2016/10/06		MATERIAL NO. SD-151214-0118 DOCUMENT NO. SD-151214-0118 SHEET NO. 1 OF 3		
3 PLACES	± ---	± ---	CHECKED BY	DATE				
2 PLACES	± 0.13	± ---	WZHA021	2016/10/06		SEE TABLE		
1 PLACE	± 0.25	± ---	APPROVED BY	DATE				
0 PLACE	± ---	± ---	SHLENI	2016/11/14		DRAFT WHERE APPLICABLE MUST REMAIN WITHIN DIMENSIONS		
ANGULAR ± 5 °		MATERIAL NO.		DOCUMENT NO.				
DRAFT WHERE APPLICABLE MUST REMAIN WITHIN DIMENSIONS		SIZE A3		THIS DRAWING CONTAINS INFORMATION THAT IS PROPRIETARY TO MOLEX INCORPORATED AND SHOULD NOT BE USED WITHOUT WRITTEN PERMISSION				

10 9 8 7 6 5 4 3 2 1

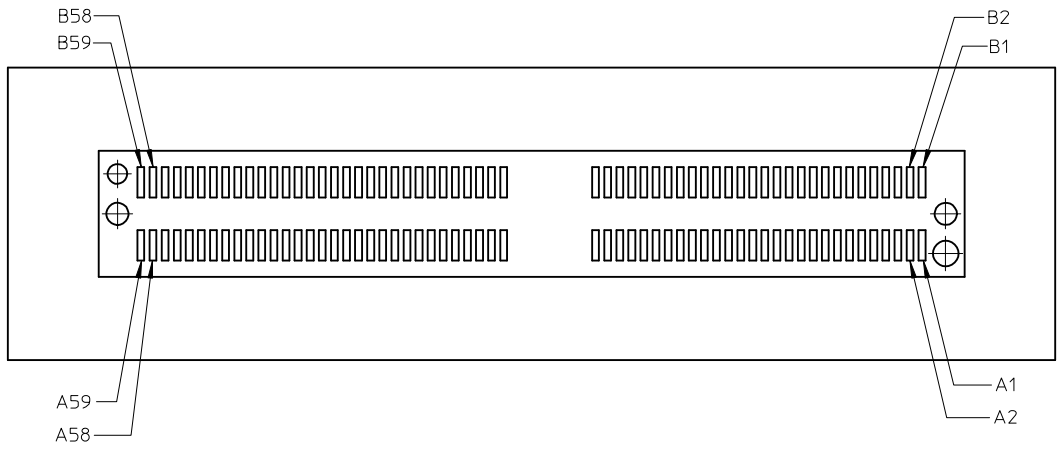
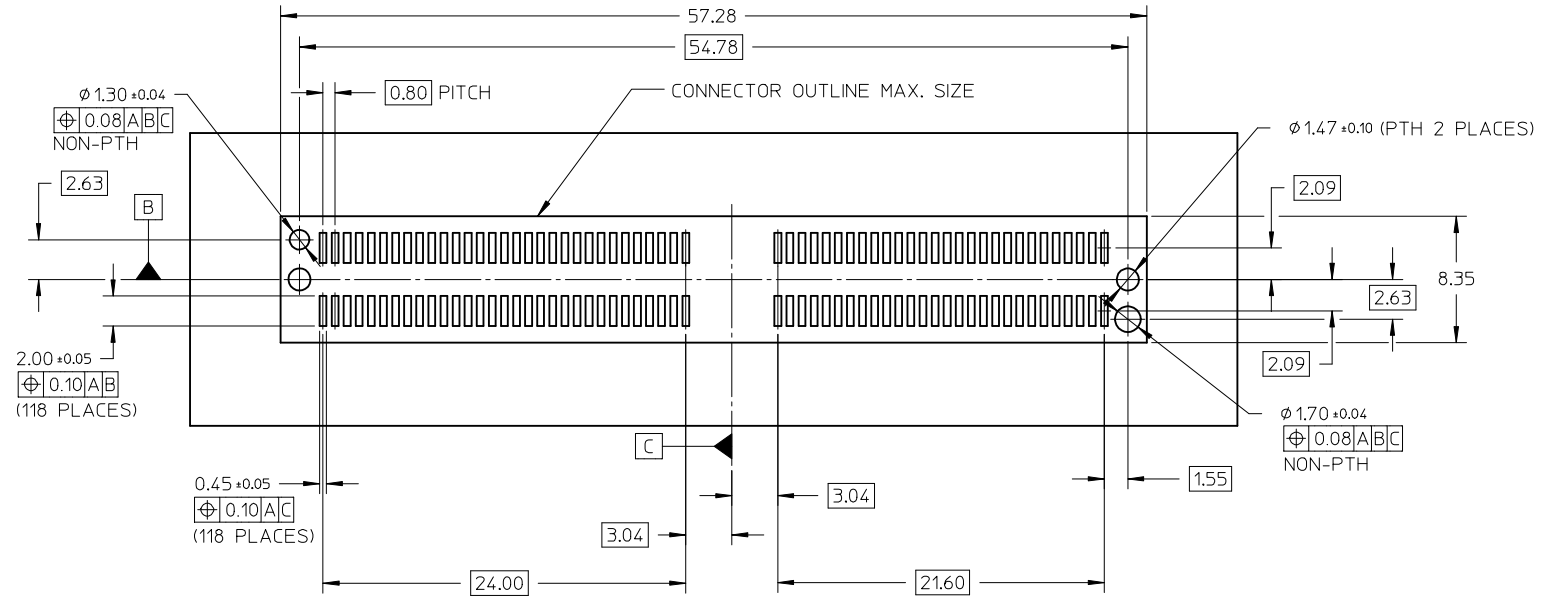

NOTES:
1. DATUM A IS THE TOP OF THE PCB.

ADDED T&R OPTION EC NO: S2017-0446 DRWN: CTEH 2017/03/08 CHKD: GTAN 2017/03/21 APPR: SHLENI 2017/03/21	QUALITY SYMBOLS $F_A=0$ $F_G=0$ $F_P=0$	GENERAL TOLERANCES (UNLESS SPECIFIED)		DIMENSION STYLE MM ONLY		SCALE NTS	DESIGN UNITS METRIC	THIRD ANGLE PROJECTION	
			mm	INCH	DRAWN BY WZHA021	DATE 2016/10/06	TITLE SALES DRAWING EDGELINE25 850HM 118CKTS SMT		
		4 PLACES	± ---	± ---	CHECKED BY WZHA021	DATE 2016/10/06	molex SD-151214-0118		
		3 PLACES	± ---	± ---	APPROVED BY SHLENI	DATE 2016/11/14			
2 PLACES	± 0.13	± ---	SEE TABLE		SD-151214-0118		2 OF 3		
1 PLACE	± 0.25	± ---	THIS DRAWING CONTAINS INFORMATION THAT IS PROPRIETARY TO MOLEX INCORPORATED AND SHOULD NOT BE USED WITHOUT WRITTEN PERMISSION						
0 PLACE	± ---	± ---							
		ANGULAR ± 5 °							
		DRAFT WHERE APPLICABLE MUST REMAIN WITHIN DIMENSIONS							

9 8 7 6 5 4 3 2 1

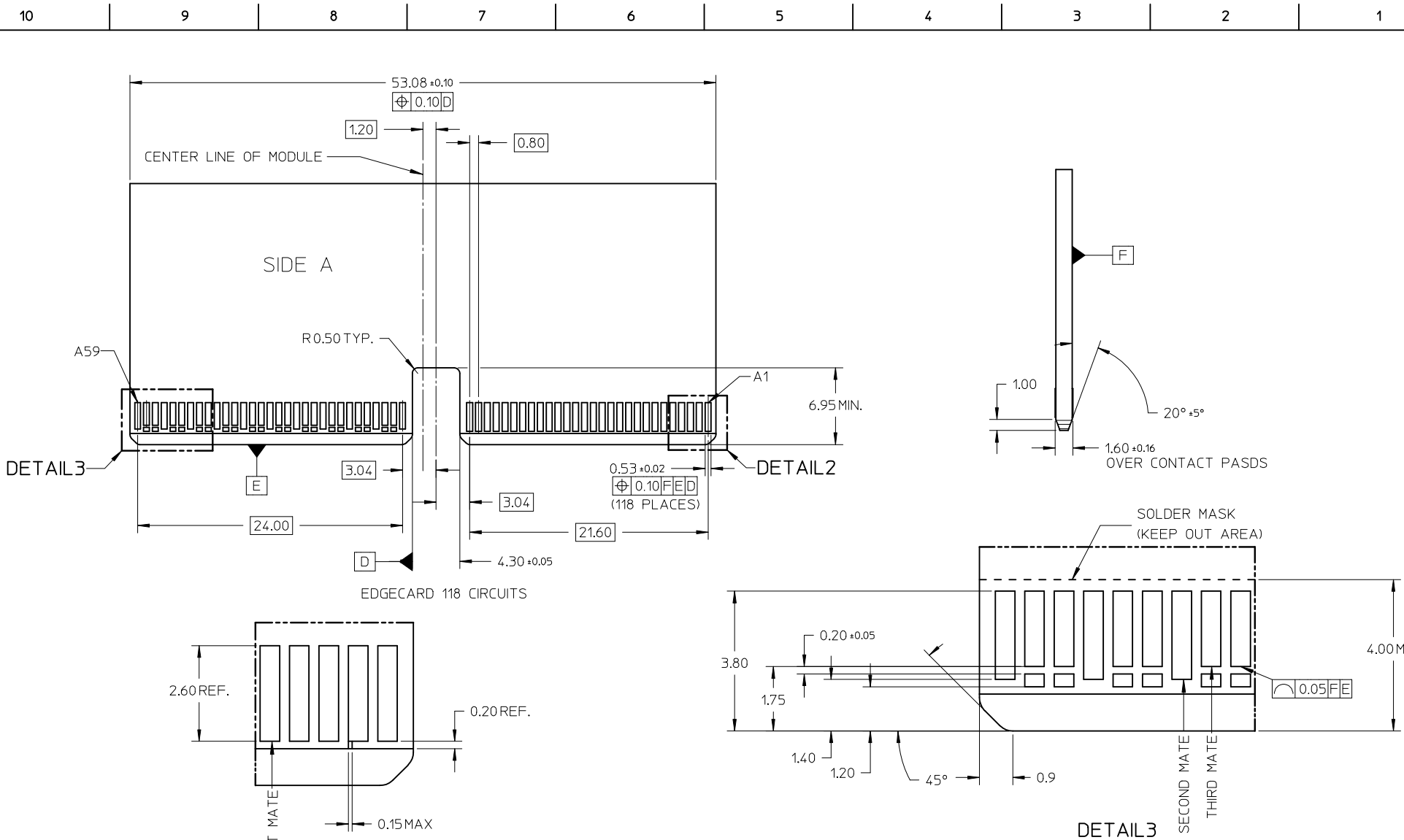

NOTE:

- THESE ARE GENERIC DETAILS THAT DESCRIBES THE CONFIGURATION OF VARIOUS PCB DESIGN ELEMENTS. THE CUSTOMER MUST DETERMINE WHERE AND WHEN TO USE EACH ELEMENT TO ACCOMMODATE THEIR SPECIFIC APPLICATION.
- CHAMFER ROUGHNESS NOT TO EXCEED 3.17µM
- EDGE CARD CHAMFER NOT TO GO THRU GOLD PAD.

ADDED T&R OPTION EC NO: S2017-0446 DRWN: CTEH 2017/03/08 CHKD: CGTAN 2017/03/21 APPR: SHLENI 2017/03/21	QUALITY SYMBOLS $\nabla_A = 0$ $\nabla_C = 0$ $\nabla_P = 0$	GENERAL TOLERANCES (UNLESS SPECIFIED)		DIMENSION STYLE MM ONLY		SCALE NTS	DESIGN UNITS METRIC	THIRD ANGLE PROJECTION																										
		<table border="1"> <thead> <tr> <th></th> <th>mm</th> <th>INCH</th> </tr> </thead> <tbody> <tr> <td>4 PLACES</td> <td>± ---</td> <td>± ---</td> </tr> <tr> <td>3 PLACES</td> <td>± ---</td> <td>± ---</td> </tr> <tr> <td>2 PLACES</td> <td>± 0.13</td> <td>± ---</td> </tr> <tr> <td>1 PLACE</td> <td>± 0.25</td> <td>± ---</td> </tr> <tr> <td>0 PLACE</td> <td>± ---</td> <td>± ---</td> </tr> </tbody> </table>		mm	INCH	4 PLACES	± ---	± ---	3 PLACES	± ---	± ---	2 PLACES	± 0.13	± ---	1 PLACE	± 0.25	± ---	0 PLACE	± ---	± ---	<table border="1"> <thead> <tr> <th>DRAWN BY</th> <th>DATE</th> <th>TITLE</th> </tr> </thead> <tbody> <tr> <td>WZHA021</td> <td>2016/10/06</td> <td></td> </tr> <tr> <td>WZHA021</td> <td>2016/10/06</td> <td></td> </tr> <tr> <td>SHLENI</td> <td>2016/11/14</td> <td></td> </tr> </tbody> </table>	DRAWN BY	DATE	TITLE	WZHA021	2016/10/06		WZHA021	2016/10/06		SHLENI	2016/11/14		SALES DRAWING EDGE LINE 25 850HM 118CKTS SMT
	mm	INCH																																
4 PLACES	± ---	± ---																																
3 PLACES	± ---	± ---																																
2 PLACES	± 0.13	± ---																																
1 PLACE	± 0.25	± ---																																
0 PLACE	± ---	± ---																																
DRAWN BY	DATE	TITLE																																
WZHA021	2016/10/06																																	
WZHA021	2016/10/06																																	
SHLENI	2016/11/14																																	
DRAFT WHERE APPLICABLE MUST REMAIN WITHIN DIMENSIONS	SEE TABLE		MATERIAL NO.	DOCUMENT NO.	SHEET NO.																													
2	SIZE A3	THIS DRAWING CONTAINS INFORMATION THAT IS PROPRIETARY TO MOLEX INCORPORATED AND SHOULD NOT BE USED WITHOUT WRITTEN PERMISSION																																