

10 9 8 7 6 5 4 3 2 1

MAT'L NO.	ENG NO.	PLATING OPTION
15-24-4345	A-8981-4V5	TIN/LEAD
15-24-4745	A-8981-4V5-LF	TIN

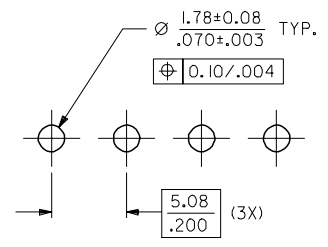
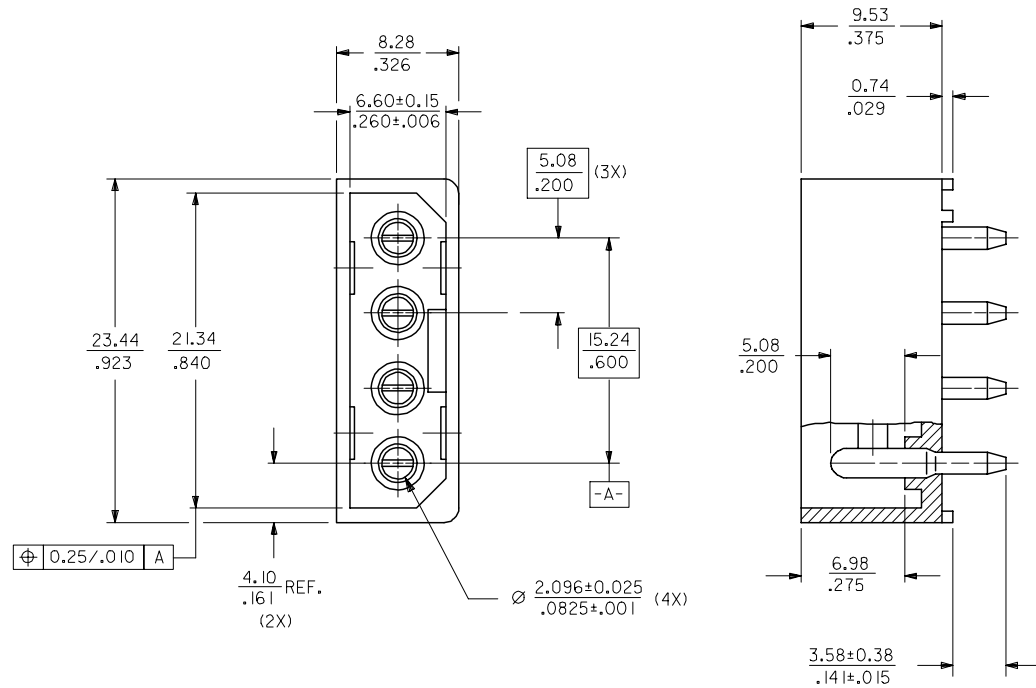

RECOMMENDED PCB HOLE LAYOUT

- NOTES :
1. PLATING
POSTPLATE 0.0025/4.000100 MIN. TIN/LEAD OR TIN OVER 0.00127/.000050 MIN. NICKEL OVERALL.
 2. PART TO MATE WITH 8981-4P*.
 3. PRODUCT SPEC PS-8981-4V4/4R1-P APPLIES.
 4. MATERIAL:
HOUSING - G.F. PCT UL94V-0
COLOR BLACK
TERMINAL - PHOS BRONZE

F
E
D
C
B
A

EDIT NOTE 3 EC NO: S2006-0765 DRWN: LO/IAO 2006/01/26 CHKD: BOKOK 2006/01/26 APPR: PTL/IM 2006/02/06	QUALITY SYMBOLS ▽=0 ◻=0	GENERAL TOLERANCES (UNLESS SPECIFIED)		DIMENSION STYLE MM/IN		SCALE NTS	DESIGN UNITS METRIC	THIRD ANGLE PROJECTION			
		4 PLACES ± --- ± ---	3 PLACES ± --- ± .008	DRAWN BY SKTOH	DATE 1991/10/17	TITLE POWER CONNECTOR, 4 CKTS VERTICAL MOUNT					
		2 PLACES ± 0.20 ± ---	1 PLACE ± --- ± ---	CHECKED BY MLA1	DATE 1991/10/17						
		ANGULAR ± 3 °		APPROVED BY RWONG	DATE 1991/10/18	MOLEX MOLEX INCORPORATED					
DRAFT WHERE APPLICABLE MUST REMAIN WITHIN DIMENSIONS		MATERIAL NO. SEE TABLE		DOCUMENT NO. SD-8981-4V5				SHEET NO. 1 OF 1			

9 8 7 6 5 4 3 2 1