

SEE INTERFACE DRAWING(SEE CHART) FOR POCKET DETAILS  
SEE NOTE 3.7

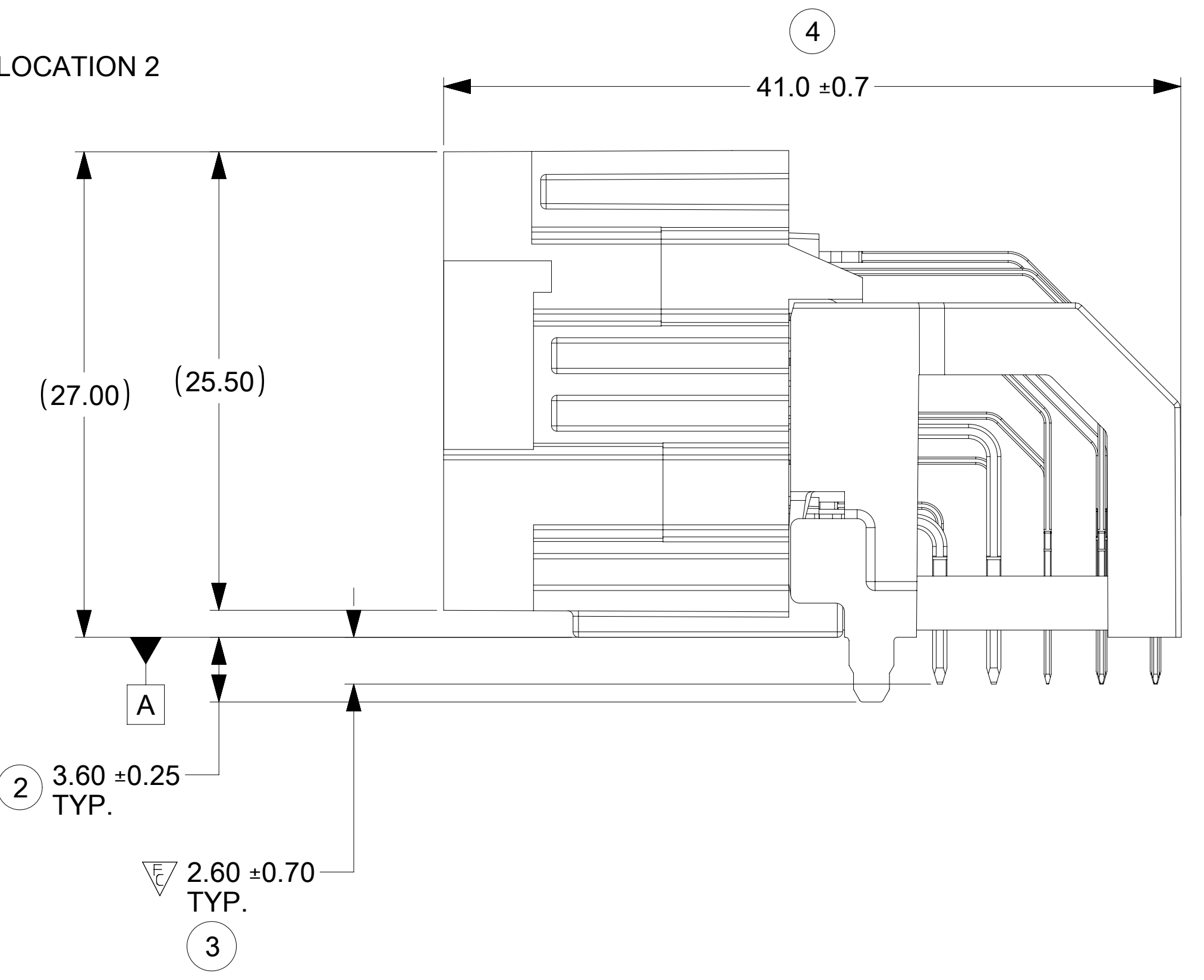

MARKING THIS HALF OF THIS SURFACE, BAY 1 (SEE NOTE 4.3)

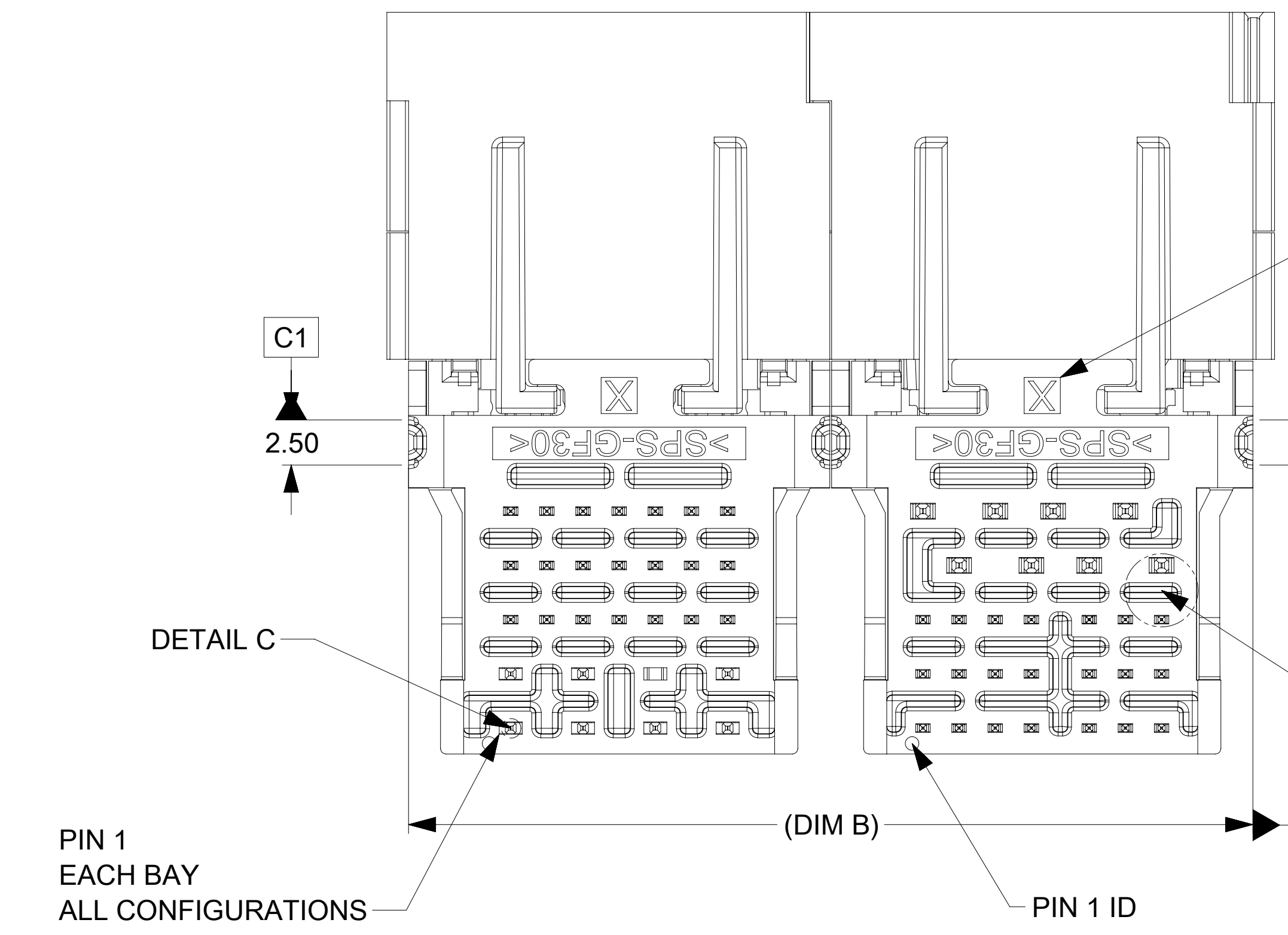

PIN 1  
EACH BAY  
ALL CONFIGURATIONS

BAY QTY	DIM A	DIM B
2	49.1	46.7
3	72.5	70.1
4	95.9	93.5
5	119.3	116.9
6	142.7	140.3
7	166.1	163.7

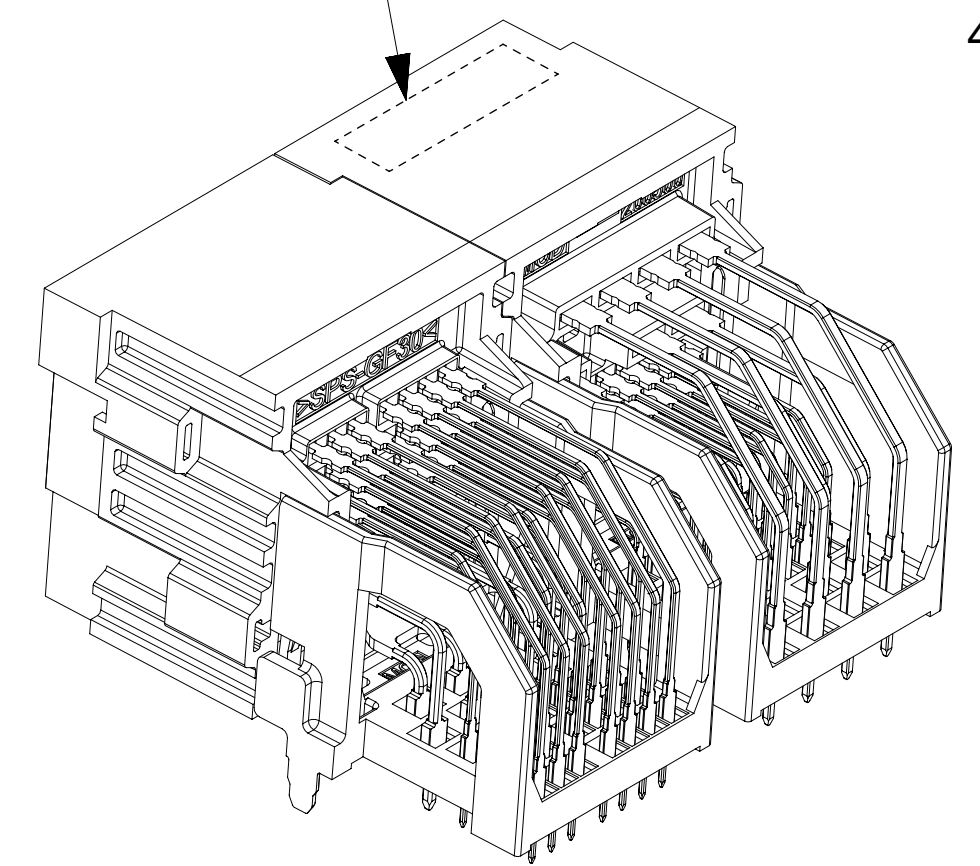

NOTES: VALID UNLESS OTHERWISE SPECIFIED

1. GENERAL:
  - 1.1 APPLICATION SPECIFICATION 2005060000-AS
  - 1.2 PRODUCT SPECIFICATION 2005060001-PS CLASSIFICATIONS T1V1S1 TO GMW 3191 2012
  - 1.3 PACKAGING SPECIFICATION PER MOLEX DRAWING
2. DESIGN - MATERIALS: SEE COMPONENT DRAWINGS
  - 2.1 HOUSING: SPS 30% GF
  - 2.2 BLADE TERMINALS:
    - A. 0.5MM BLADES  
BASE MATERIAL: COPPER ALLOY  
CONDUCTIVITY > 28% IACS @ 20°C  
UNDERPLATE: OVERALL NICKEL  
OVERPLATE: OVERALL TIN
    - B. 1.2MM BLADES  
BASE MATERIAL: COPPER ALLOY  
CONDUCTIVITY > 28% IACS @ 20°C  
UNDERPLATE: OVERALL NICKEL  
OVERPLATE: OVERALL TIN
    - C. 2.8MM BLADES  
BASE MATERIAL: COPPER ALLOY  
CONDUCTIVITY > 40% IACS @ 20°C  
UNDERPLATE: OVERALL NICKEL  
OVERPLATE: OVERALL TIN
3. DESIGN - GEOMETRY:
  - 3.1 ALL GRAPHIC DATA IS BASIC (NO TOLERANCE) AND MUST BE TAKEN FROM THE DATA FILE AT ITS LATEST REVISION.
  - 3.2 PRODUCT DESIGN MODEL NUMBER: SEE CHART. MODEL NUMBERS SAME AS PART NUMBERS
  - 3.3 GEOMETRIC DIMENSIONS AND TOLERANCES PER ASME Y14.5-2009
  - 3.4 EDGES OF UNDEFINED SHAPE PER ISO 13715
  - 3.5 CORNERS SHOWN AS SHARP TO BE R 0.4 MAX.
  - 3.6 LETTERING SHALL BE MAX POSSIBLE FOR READABILITY. THIS INCLUDES RECYCLING CODE, CAVITY ID,VENDOR IDENTIFICATION, AND CUSTOMER MATERIAL NUMBER.
  - 3.7 FOR BAY/POCKET DEFINITION SEE MOLEX INTERFACE DRAWINGS IN CHART. FUNCTIONAL APPLIES TO ALL FUNCTIONALS IN INTERFACE DRAWINGS.
  - 3.8 [G] DENOTES DIMENSIONS TO BE QUALIFIED WITH GAGE FOR PPAP AND IN PROCESS QUALITY CHECKS.
4. DESIGN - MANUFACTURING:
  - 4.1 VISUAL DEFECTS SHALL MEET MOLEX COSMETIC STANDARD PS-45499-002 (CLASS B)
  - 4.2 REFLOW SOLDERABILITY PER SMES-152
  - 4.3 LASER ETCHED PART MARKING (1.5mm HEIGHT) CODED AS FOLLOWS  
ROW 1: "YYDDDDHHMMSS"  
- DATE AND TIME CODE  
ROW 2: "XXXXX" OR "XXXXX\_X"  
-" XXXXX" IS LAST 5 DIGITS OF PART NO AND DENOTES ORIGINAL ASSEMBLY LINE  
-"\_X" DENOTES CAPACITY ASSEMBLY LINE SUCH AS "\_B" OR MORE IN FUTURE

INSPECTION BALLOON NUMBER LOG	SEE SHEET 2
PER DRAWING REVISION: C10	
LAST BALLOON NUMBER: 16	
ADDED BALLOON NUMBER: NONE	
DELETED BALLOON NUMBER: NONE	

REVISION	DESCRIPTION

FUNCTIONAL SYMBOLS		THIS DRAWING CONTAINS INFORMATION THAT IS PROPRIETARY TO MOLEX ELECTRONIC TECHNOLOGIES, LLC AND SHOULD NOT BE USED WITHOUT WRITTEN PERMISSION		CURRENT REV DESC: SEE REVISION TABLE	
FA = 0	mm	SCALE	4:1		
FE = 2	GENERAL TOLERANCES (UNLESS SPECIFIED)				
FP = 0	ANGULAR TOL		±	°	
DIVISIONAL SYMBOLS		4 PLACES	±	0.0	EC NO: 680371
		3 PLACES	±	0.0	DRWN: PKH 2021/09/28
		2 PLACES	±	0.13	CHK'D: YPENG47 2021/10/07
		1 PLACE	±	0.25	APPR: JCONDON 2021/10/07
		0 PLACES	±	0.0	INITIAL REVISION:
DRAFT WHERE APPLICABLE MUST REMAIN WITHIN DIMENSIONS		DRWN: JJOYA 2016/05/31			
		APPR: KDEKOSKI 2016/06/17			
THIRD ANGLE PROJECTION		DRAWING	SERIES	MATERIAL NUMBER	CUSTOMER
D-SIZE		200506	SEE CHART		
DOCUMENT NUMBER		DOC TYPE	DOC PART	REVISION	
2005060000		PSD	000	C10	
SHEET NUMBER		1 OF 4			

DOCUMENT STATUS	P1	RELEASE DATE	2021/10/07	15:12:41
-----------------	----	--------------	------------	----------

ASSEMBLY PART NO.	SINGLE BAY ASSEMBLY PART NUMBER PER LOCATION						
	1	2	3	4	5	6	7
2005062004	2005020284	2005020251	-----NA-----	-----NA-----	-----NA-----	-----NA-----	-----NA-----
2005062005	2005020121	2005020271	-----NA-----	-----NA-----	-----NA-----	-----NA-----	-----NA-----
2005066001	2005020281	2005020322	2005020253	2005020283	2005020324	2005020273	-----NA-----
2005063001	2005020123	2005020321	2005020323	-----NA-----	-----NA-----	-----NA-----	-----NA-----
2005062007	2005020121	2005020122	-----NA-----	-----NA-----	-----NA-----	-----NA-----	-----NA-----
2005062008	2005020321	2005020323	-----NA-----	-----NA-----	-----NA-----	-----NA-----	-----NA-----
2005063006	2005020321	2005020282	2005020323	-----NA-----	-----NA-----	-----NA-----	-----NA-----
2005063007	2005020321	2005020322	2005020323	-----NA-----	-----NA-----	-----NA-----	-----NA-----
2005063008	2005020321	2005020282	2005020283	-----NA-----	-----NA-----	-----NA-----	-----NA-----
2005063003	2005020251	2005020252	2005020321	-----NA-----	-----NA-----	-----NA-----	-----NA-----
2005063009	2005020123	2005020253	2005020322	-----NA-----	-----NA-----	-----NA-----	-----NA-----
2005062009	2005020284	2005020281	-----NA-----	-----NA-----	-----NA-----	-----NA-----	-----NA-----
2005063010	2005020122	2005020123	2005020124	-----NA-----	-----NA-----	-----NA-----	-----NA-----
2005063011	2005020322	2005020252	2005020251	-----NA-----	-----NA-----	-----NA-----	-----NA-----
2005062011	2005020271	2005020272	-----NA-----	-----NA-----	-----NA-----	-----NA-----	-----NA-----
2005066002	2005020251	2005020252	2005020123	2005020122	2005020124	2005020322	-----NA-----
2005065003	2005020251	2005020252	2005020253	2005020324	2005020323	-----NA-----	-----NA-----
2005062012	2005020323	2005020121	-----NA-----	-----NA-----	-----NA-----	-----NA-----	-----NA-----
2005063012	2005020321	2005020322	2005020254	-----NA-----	-----NA-----	-----NA-----	-----NA-----
2005064004	2005020321	2005020322	2005020323	2005020324	-----NA-----	-----NA-----	-----NA-----
2005062013	2005020323	2005020324	-----NA-----	-----NA-----	-----NA-----	-----NA-----	-----NA-----
2005062014	2005020324	2005020321	-----NA-----	-----NA-----	-----NA-----	-----NA-----	-----NA-----
2005064006	2005020253	2005020281	2005020282	2005020283	-----NA-----	-----NA-----	-----NA-----
2005062015	2005020271	2005020124	-----NA-----	-----NA-----	-----NA-----	-----NA-----	-----NA-----
2005063015	2005020323	2005020271	2005020124	-----NA-----	-----NA-----	-----NA-----	-----NA-----
2005063016	2005020281	2005020282	2005020283	-----NA-----	-----NA-----	-----NA-----	-----NA-----

SINGLE BAY ASSEMBLY	DRAWING	INTERFACE DRAWING	TERMINAL QUANTITIES		
			0.5mm	1.2mm	2.8mm
2005020121 THROUGH 2005020124	2005021120SD	SD-160026-002		8	4
2005020251 THROUGH 2005020254	2005021250SD	SD-160027-002	21		4
2005020271 THROUGH 2005020274	2005021270SD	SD-160029-002	19	8	
2005020281 THROUGH 2005020284	2005021280SD	SD-160014-002	21	7	
2005020321 THROUGH 2005020324	2005021320SD	SD-160028-002	28	4	

C10	NOTE 4.3 UPDATED
C9	ADDED PART NUMBER 2005063016 ECN 655445
C8	ADDED MISSED DATUM F 11-JUNE-2020 YPENG47 ECN:639277
C7	ADDED PCB HOLE DIMENSIONAL & POSITIONAL TOLERANCE ADDED PART NUMBERS 2005062015 & 2005063015 07JAN2020 JBR ECN 630121
C6	ADDED PART NUMBER 2005064006 ECN 623652
C5	ADDED PART NUMBER 2005062013, 2005062014 ECN 621423
C4	ADDED PART NUMBER 2005064004 ECN 620443
C3	ADDED PART NUMBER 2005063012 ECN 618092
C2	ADDED PART NUMBER 2005062012 ECN 610976
C1	CORRECTED BAY SERIES NUMBER IN 2005062001. UPDATED PCB TERMINATION TOLERANCE TO MATCH SINGLE BAY DRAWINGS. CLARIFIED PCB HEIGHT TO DATUM A. ECN 602205.
C	INTERFACE GEOMETRY CHANGE TO LOCK TAB. ADDED PART NUMBERS. SAP ECN 10906786.
B6	ADDED PART NUMBER 2005062011. CORRECTED PART NUMBER 2005063003. SAP ECN 10901610
B5	ADDED TWO NEW PART NUMBERS AND CHANGED KEYS FOR 2005062009 SAP ECN 10878438
B4	ADDED PART NUMBER
B3	REVISED PART NUMBER SAP ECN 10868615
B2	ADDED PART NUMBER SAP ECN 10867945
B1	CORRECTED PART NUMBERS. ADDED PART NUMBER. CHANGED TOL ON DIM 4 TO +/-0.7. CORRECTED VIEW ROTATION SHEET 3. RELEASE TO SAP ECN 10861460.
B	MODULE OPENING CHANGE. UPDATED NOTES. ADDED NEW PART NUMBERS
A5	ADDED PART NUMBER
A4	ADDED PART NUMBER
A3	RELEASE TO GENERAL MARKET
A2	CHANGED PART NUMBER MARKING, MODIFY DIMENSIONS
A1	ADDED PN 2005066001
A	INITIAL RELEASE
REVISION	DESCRIPTION

FUNCTIONAL SYMBOLS	THIS DRAWING CONTAINS INFORMATION THAT IS PROPRIETARY TO MOLEX ELECTRONIC TECHNOLOGIES, LLC AND SHOULD NOT BE USED WITHOUT WRITTEN PERMISSION		CURRENT REV DESC: SEE REVISION TABLE	
	FA = 0	mm	SCALE 1:1	
DIVISIONAL SYMBOLS	GENERAL TOLERANCES (UNLESS SPECIFIED)		EC NO: 680371	
	FC = 0	ANGULAR TOL ± °	DRWN: PKH	2021/09/28
DIVISIONAL SYMBOLS	FP = 0	4 PLACES ± 0.0	CHK'D: YPENG47	2021/10/07
		3 PLACES ± 0.0	APPR: JCONDON	2021/10/07
		2 PLACES ± 0.13	INITIAL REVISION:	
		1 PLACE ± 0.25	DRWN: JJOYA	2016/05/31
	0 PLACES ± 0.0	APPR: KDEKOSKI	2016/06/17	
DRAFT WHERE APPLICABLE MUST REMAIN WITHIN DIMENSIONS		THIRD ANGLE PROJECTION	DRAWING D-SIZE	SERIES 200506
DOCUMENT STATUS	P1	RELEASE DATE	2021/10/07	15:12:41
DOCUMENT NUMBER		DOC TYPE	DOC PART	REVISION
2005060000		PSD	000	C10
MATERIAL NUMBER		CUSTOMER	SHEET NUMBER	
SEE CHART			2 OF 4	

TYPICAL PCB TERMINATIONS  
 SIZE AND TRUE POSITION TOLERANCES  
 SEE INDIVIDUAL SINGLE BAY DRAWINGS  
 FOR LOCATIONS (CHART ON SHEET 1)  
 PARTS TO BE CHECKED WITH FUNCTIONAL GAGE  
 SEE NOTE 3.8

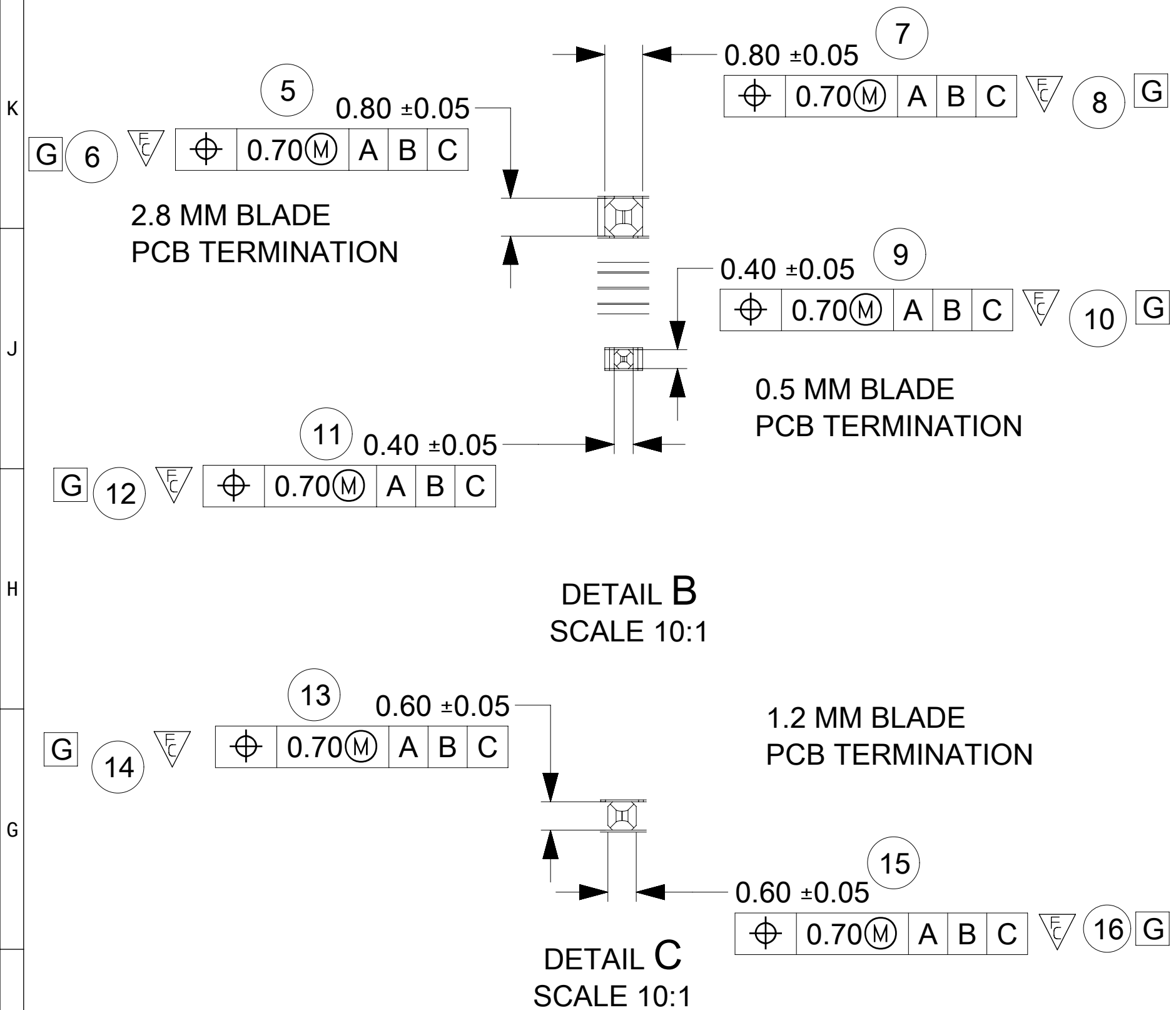

RECOMMENDED PCB LAYOUT PER BAY  
 FOR REFERENCE ONLY

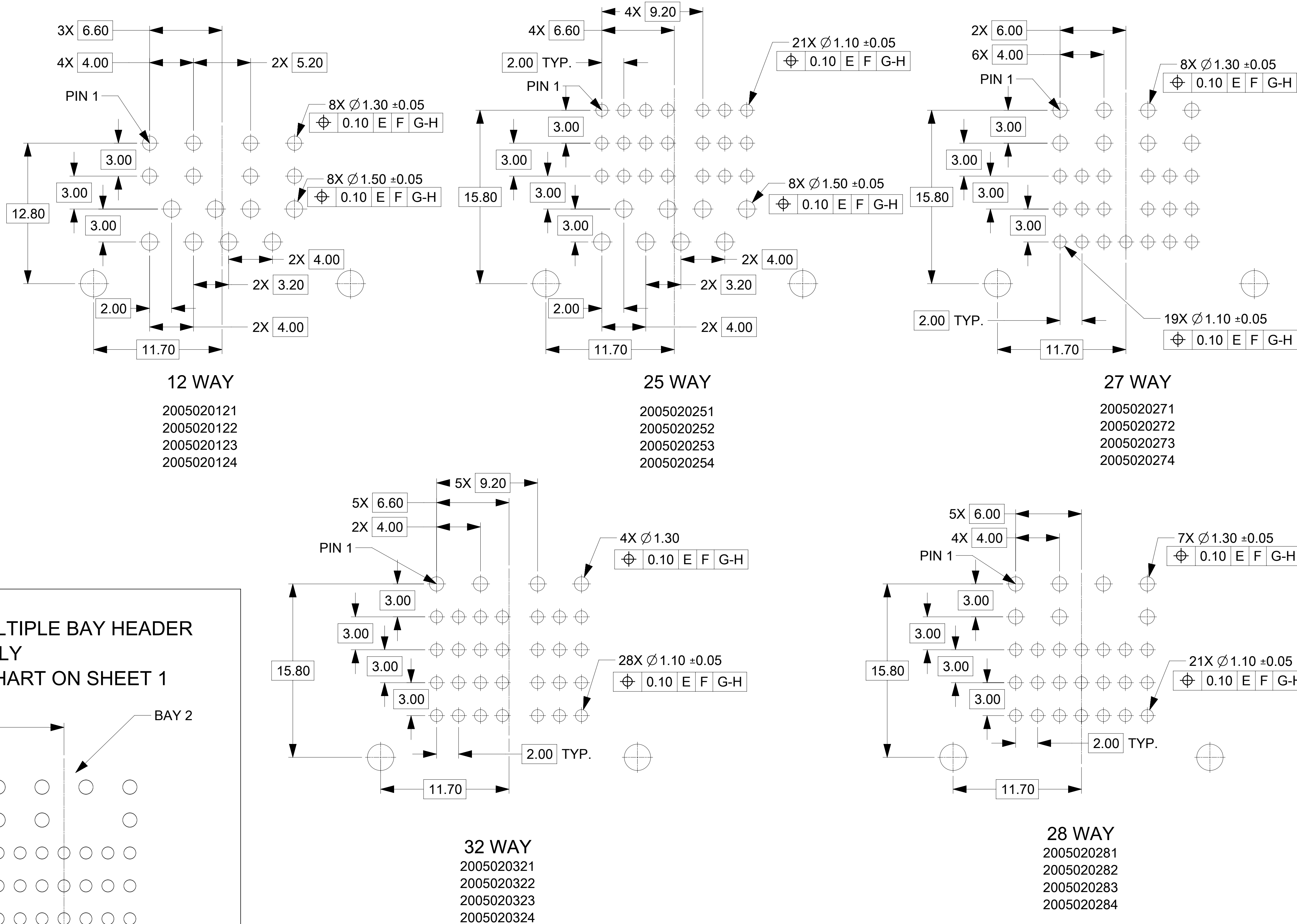

RECOMMENDED PCB LAYOUT FOR MULTIPLE BAY HEADER  
 FOR REFERENCE ONLY  
 INSERT NECESSARY BAYS USING CHART ON SHEET 1

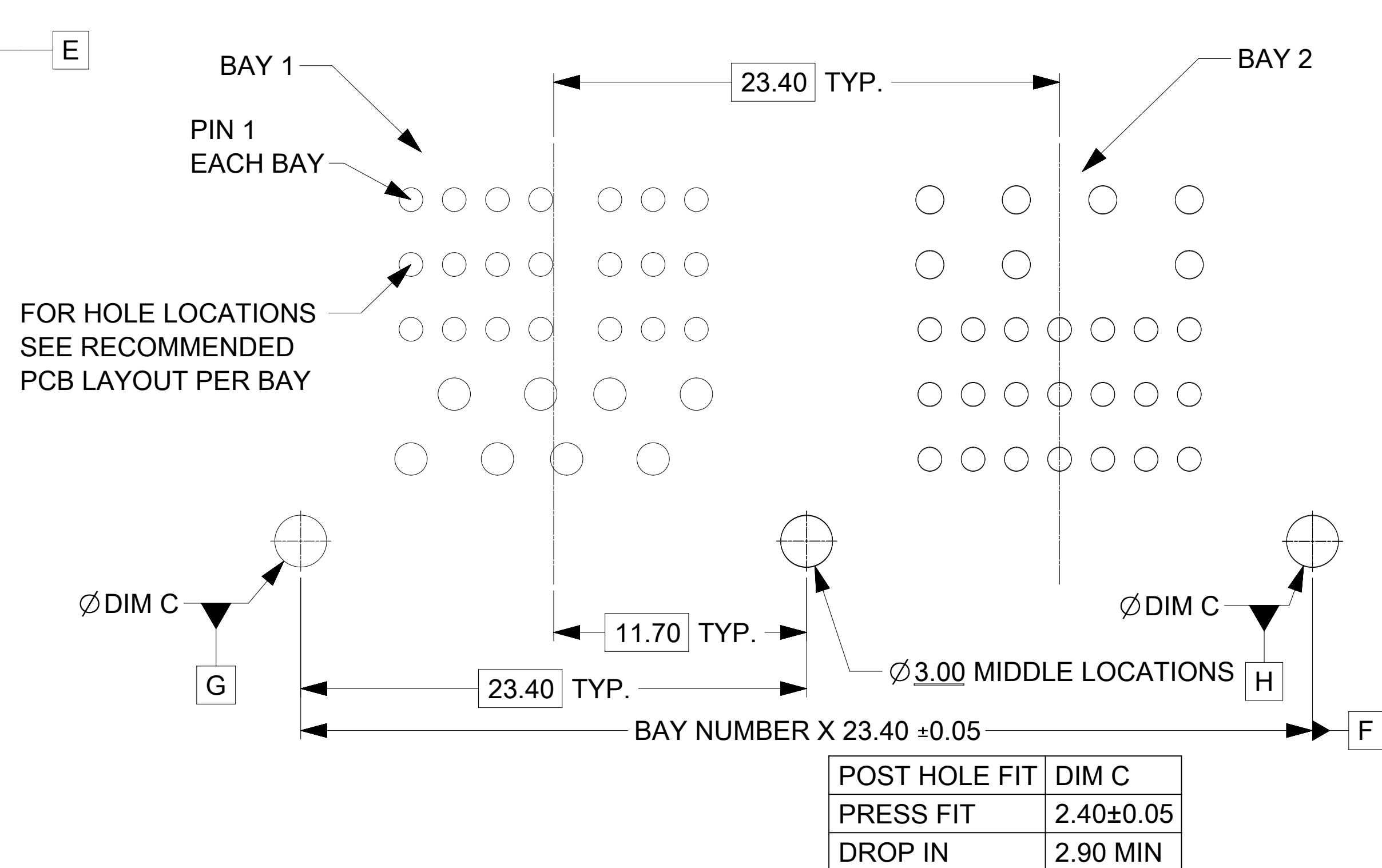

FUNCTIONAL SYMBOLS	THIS DRAWING CONTAINS INFORMATION THAT IS PROPRIETARY TO MOLEX ELECTRONIC TECHNOLOGIES, LLC AND SHOULD NOT BE USED WITHOUT WRITTEN PERMISSION	
$F_A = 0$	DIMENSION UNITS: mm	SCALE: 5:1
$F_C = 6$	GENERAL TOLERANCES (UNLESS SPECIFIED)	
$F_P = 0$	ANGULAR TOL ± °	
DIVISIONAL SYMBOLS	4 PLACES	± 0.0
	3 PLACES	± 0.0
	2 PLACES	± 0.13
	1 PLACE	± 0.25
	0 PLACES	± 0.0
DRAFT WHERE APPLICABLE MUST REMAIN WITHIN DIMENSIONS	THIRD ANGLE PROJECTION	DRAWING: D-SIZE
		SERIES: 200506
		MATERIAL NUMBER: SEE CHART
		SHEET NUMBER: 3 OF 4

EC NO: 680371	2021/09/28	<b>molex</b>
DRWN: PKH	2021/10/07	
CHK'D: YPENG47	2021/10/07	
APPR: JCONDON	2021/10/07	PRODUCT CUSTOMER DRAWING
INITIAL REVISION:		DOCUMENT NUMBER
DRWN: JJOYA	2016/05/31	2005060000
APPR: KDEKOSKI	2016/06/17	DOC TYPE: PSD
		DOC PART: 000
		REVISION: C10

RECOMMENDED MODULE OPENING  
TO PASS ISO 20653 IP-4

BAY QTY	DIM D
2	50.1
3	73.5
4	96.9
5	120.3
6	143.7
7	167.1

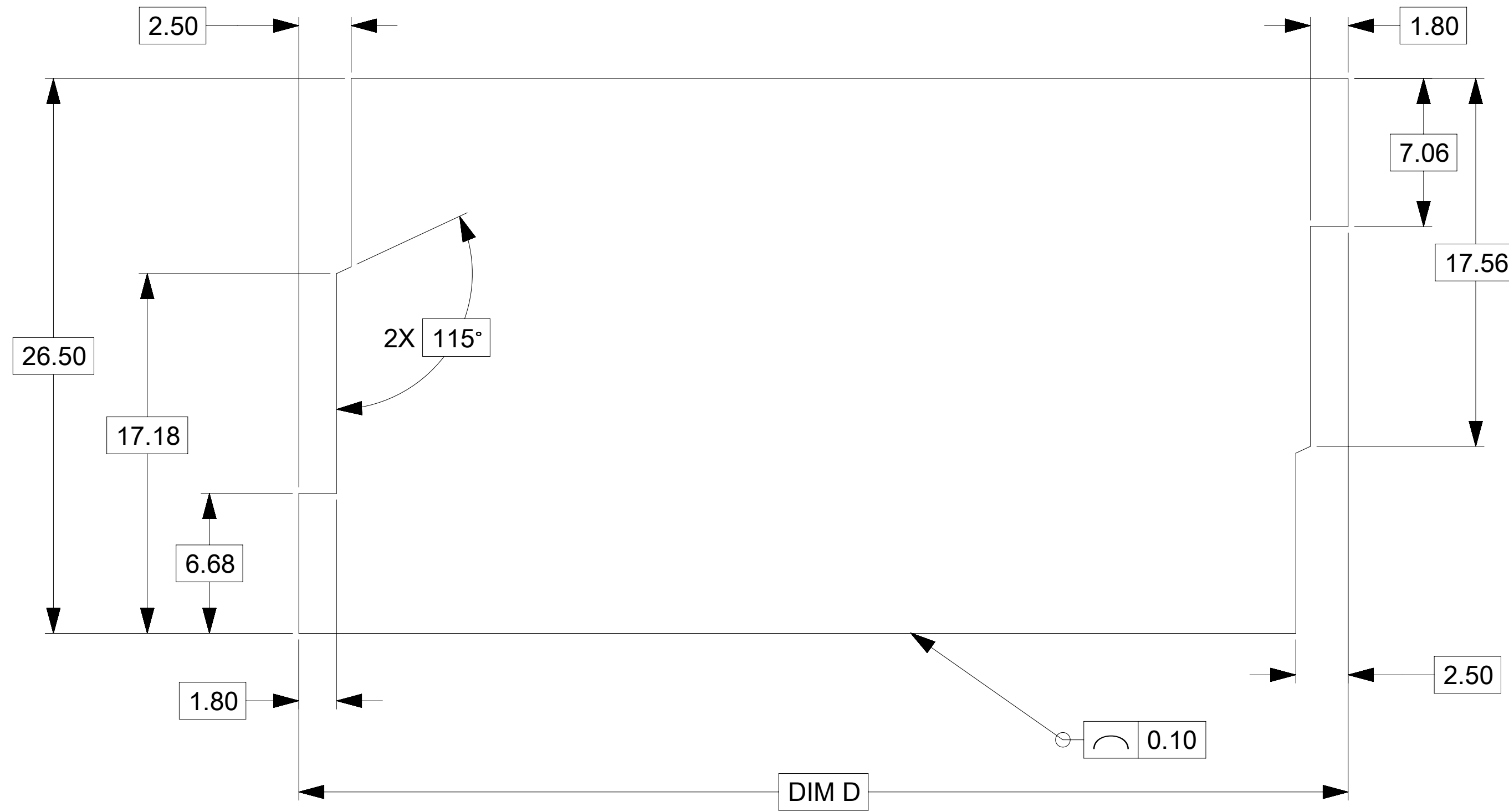

(4.90)  
SPACE FOR  
MODULE  
COVER

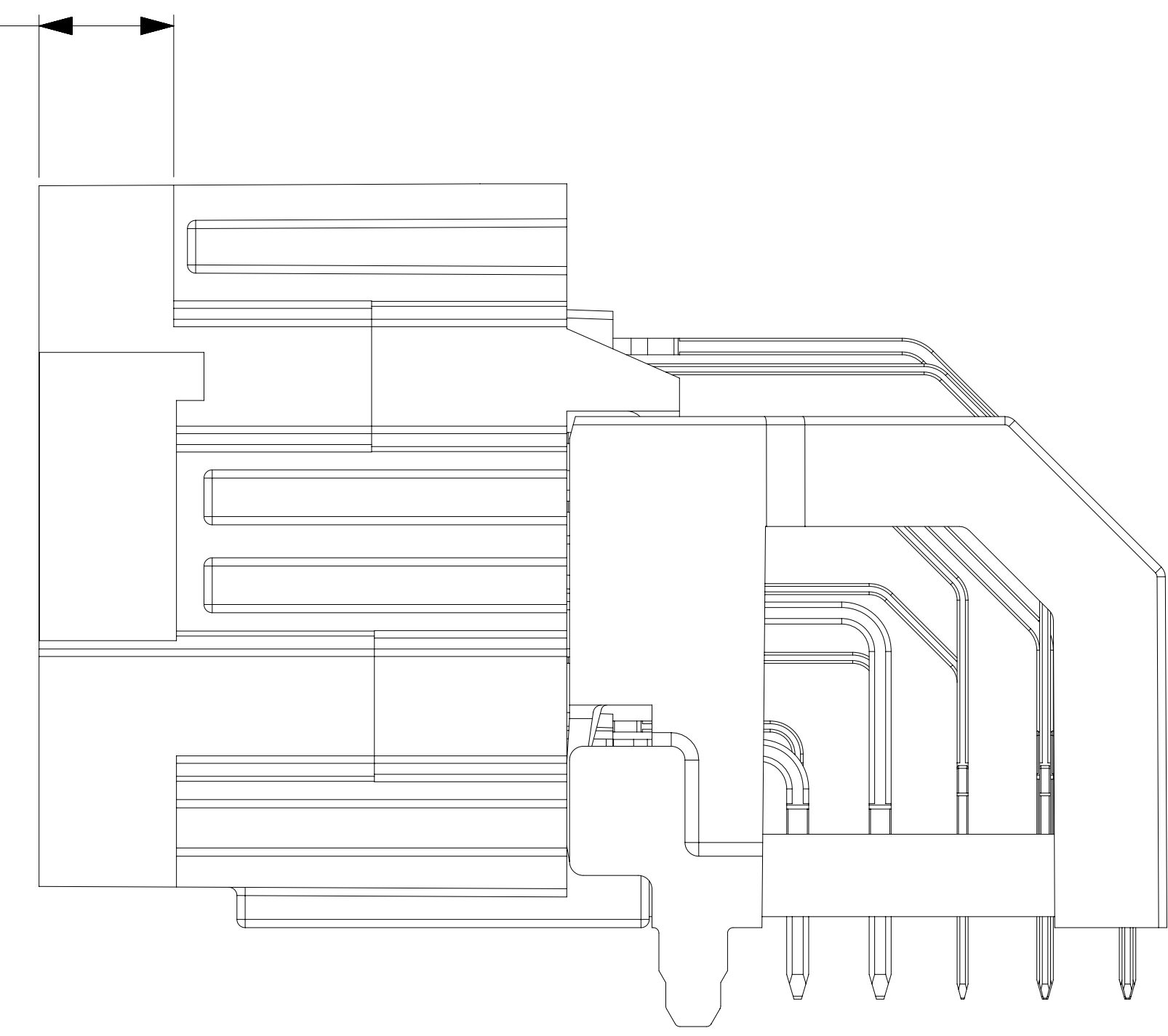

FOR PACKAGE SPACE FOR CONNECTOR  
UNMATED AND MATED WITH COVER  
SEE INTERFACE DRAWINGS (CHART ON SHEET 1)

HEADER OUTLINE AND  
PCB - HEADER CONTACT AREAS  
FOR REFERENCE ONLY

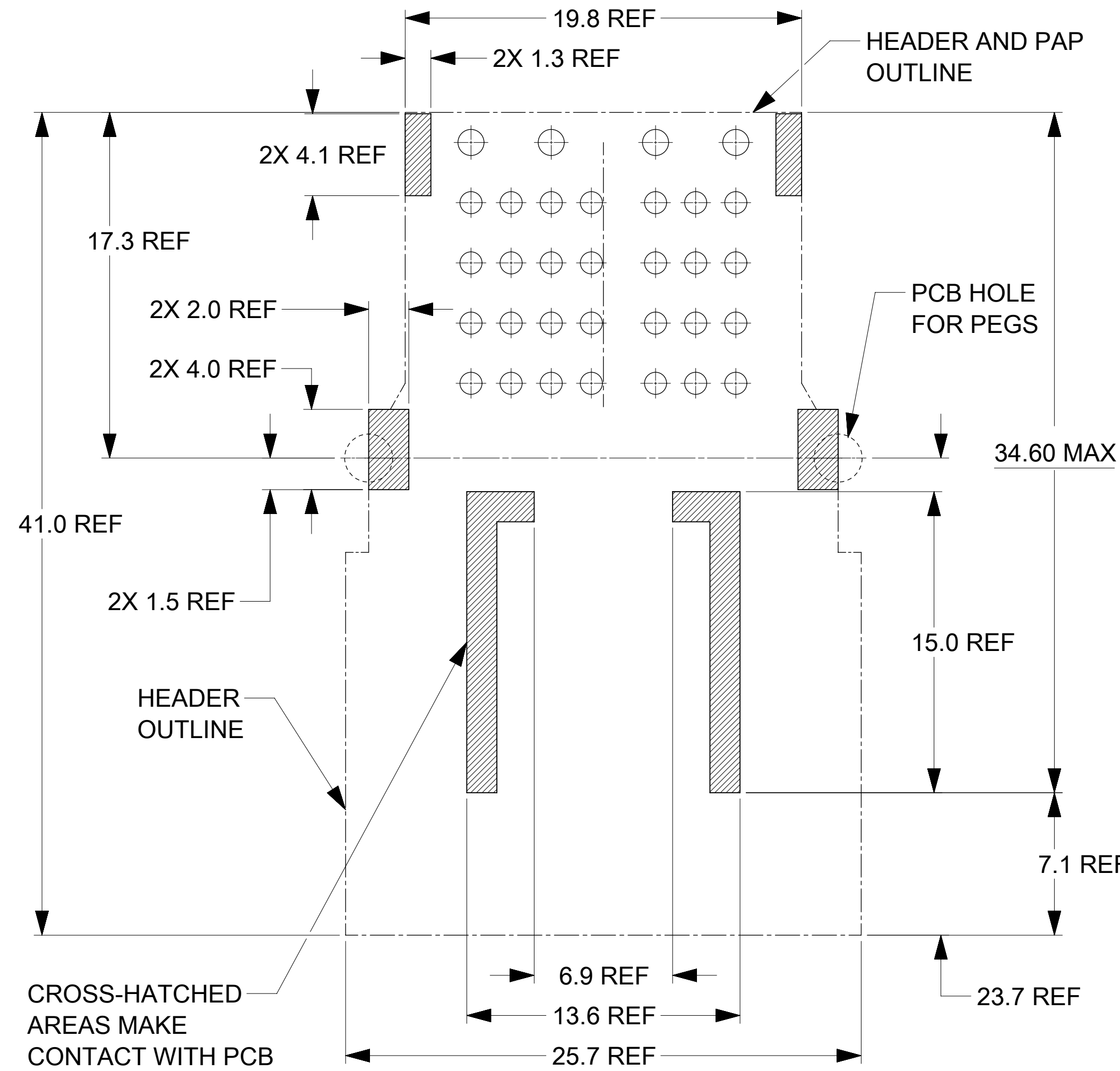

FUNCTIONAL SYMBOLS	THIS DRAWING CONTAINS INFORMATION THAT IS PROPRIETARY TO MOLEX ELECTRONIC TECHNOLOGIES, LLC AND SHOULD NOT BE USED WITHOUT WRITTEN PERMISSION		CURRENT REV DESC: SEE REVISION TABLE	
$F_A = 0$	DIMENSION UNITS	SCALE		
$F_C = 0$	mm	1:1		
$F_P = 0$	GENERAL TOLERANCES (UNLESS SPECIFIED)			
	ANGULAR TOL	± °		
	4 PLACES	± 0.0		
	3 PLACES	± 0.0		
	2 PLACES	± 0.13		
	1 PLACE	± 0.25		
	0 PLACES	± 0.0		
DIVISIONAL SYMBOLS	DRAFT WHERE APPLICABLE MUST REMAIN WITHIN DIMENSIONS			
	THIRD ANGLE PROJECTION	DRAWING	SERIES	MATERIAL NUMBER
		D-SIZE	200506	SEE CHART
	EC NO: 680371	DRWN: PKH	2021/09/28	
	CHK'D: YPENG47	APPR: JCONDON	2021/10/07	
	INITIAL REVISION:	DRWN: JJOYA	2016/05/31	
	APPR: KDEKOSKI	APPR: KDEKOSKI	2016/06/17	
		DOCUMENT NUMBER		DOC TYPE
		2005060000		PSD
		DOC PART		REVISION
		000		C10
		CUSTOMER		SHEET NUMBER
				4 OF 4