

| MATERIAL NUMBER | ENGINEERING NUMBER | WIRE RANGE | "L" MAX | "A" MIN | "B" MAX | MATERIAL | MATERIAL THICKNESS | TEMPERATURE RATING |
|-----------------|--------------------|---------------------------------|--------------|--------------|--------------|----------|--------------------|--------------------|
| 192030165 | A-T-302 | 22-18 (0.3-1.0mm ²) | .330 / (8.4) | .060 / (1.5) | .130 / (3.3) | COPPER | .032 / (0.8) | 650F (342C) |
| 192030172 | B-T-304 | 16-14 (1.2-2.0mm ²) | .330 / (8.4) | .091 / (2.3) | .160 / (4.1) | COPPER | .032 / (0.8) | 650F (342C) |
| 192030169 | C-T-303 | 12-10 (3.0-6.0mm ²) | .330 / (8.4) | .130 / (3.3) | .225 / (5.7) | COPPER | .040 / (1.0) | 650F (342C) |

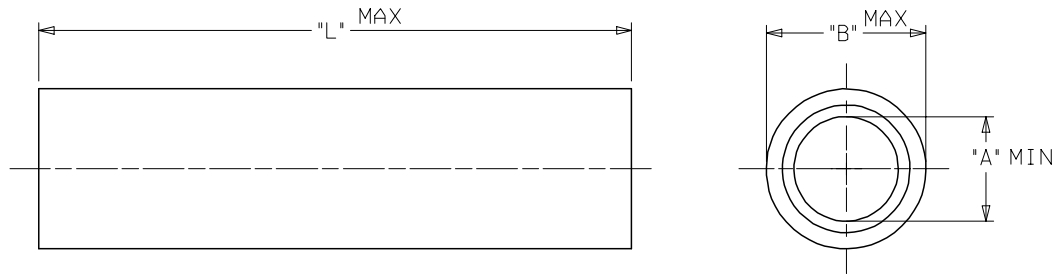

NOTES:
 1. PLATING: ELECTRO-NICKEL.
 2. ALL DIMENSIONS IN INCHES/(MM).
 3. RoHS COMPLIANT

| | | | | | | | | |
|--|-------------------------------|---------------------------------------|-------------|---|--------------------|--------------|---|--|
| RELEASE FOR PROD EC NO: ETC2007-0146 DRW: JLOMASTRO 2006/10/11 CHKD: JMACNEIL 2006/10/11 APPR: JMACNEIL 2006/10/12 | QUALITY SYMBOLS ▽=0 ▽=0 | GENERAL TOLERANCES (UNLESS SPECIFIED) | | DIMENSION STYLE | SCALE | DESIGN UNITS | THIRD ANGLE PROJECTION | |
| | | | mm | INCH | IN/MM | INCH | | |
| | | 4 PLACES | ± --- | ± --- | DRAWN BY | DATE | TITLE | |
| | | 3 PLACES | ± --- | ± .010 | JLOMASTRO | 10/02/06 | PARALLEL SPLICE VERSAKRIMP TEMP TERMS | |
| 2 PLACES | ± 0.25 | ± .01 | CHECKED BY | DATE | | | | |
| 1 PLACE | ± 0.3 | ± --- | JMACNEIL | 10/02/06 | | | | |
| ANGULAR ±1/2° | | | APPROVED BY | DATE | MOLEX INCORPORATED | | | |
| | | | RDEROSS | 10/04/06 | | | | |
| DRAFT WHERE APPLICABLE MUST REMAIN WITHIN DIMENSIONS | | MATERIAL NO. | | DOCUMENT NO. | | SHEET NO. | | |
| | | SEE CHART | | SD-19203-042 | | 1 OF 1 | | |
| | | SIZE B | | THIS DRAWING CONTAINS INFORMATION THAT IS PROPRIETARY TO MOLEX INCORPORATED AND SHOULD NOT BE USED WITHOUT WRITTEN PERMISSION | | | | |