



**ANATECH ELECTRONICS INC**  
RF & Microwave Filters & Products

# 1850-1910 MHz / 1930-1990 MHz Ceramic Duplexer

**Part Number: AM1880-1960D1004**



<u>Characteristics</u>	<u>Band 1</u>	<u>Band 2</u>
<b>Passband:</b>	1850-1910 MHz	1930-1990 MHz
<b>Bandwidth:</b>	60 MHz	60 MHz
<b>Passband Return Loss:</b>	10 dB	10 dB
<b>Passband Insertion Loss:</b>	3.4 dB	3.2 dB
<b>Passband Ripple:</b>	2.30 dB	2.30 dB
<b>Input / Output Impedance:</b>	50 Ohms	50 Ohms
<b>Isolation:</b>	50 dB	50 dB
<b>Power Handling:</b>	5 W max	5 W max

<u>Mechanical</u>	
<b>Mounting Method:</b>	SMT
<b>Dimensions:</b>	61.85 x 11.2 x 8 mm

<u>Environmental</u>	
<b>Operating Temperature:</b>	-40 to +70 deg.C
<b>Storage Temperature:</b>	-50 to +90 deg.C

**This product is RoHS compliant.**

## Outline Drawing:

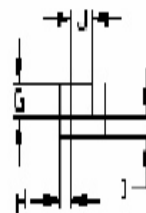
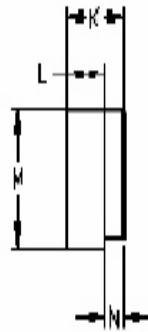
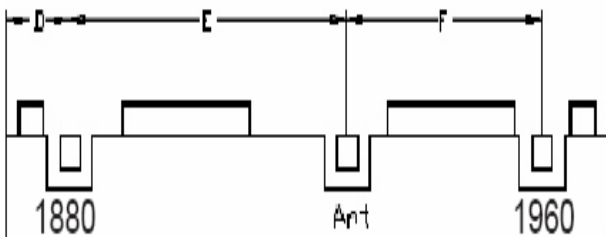
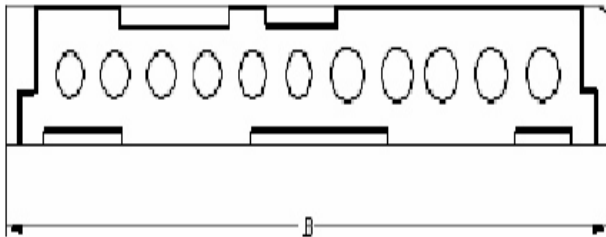

Dim	Nominal (mm)	Tolerance (mm) +/- or max
A		
B	61.85	max
C		
D	6.43	0.25
E	27.82	0.13
F	19.49	0.13
G	2.03	0.13
H	1.27	0.13
I	1.27	0.13
J	2.03	0.13
K	11.2	max
L	9.0	Max
M	8.0	max
N	2.2	0.13



**ANATECH ELECTRONICS INC**  
RF & Microwave Filters & Products

**1850-1910 MHz / 1930-1990 MHz  
Ceramic Duplexer  
Part Number: AM1880-1960D1004**



**Response Plot:**

