

Product Change Notification (PCN)

PCN Number	501709	Date Issued	January 12, 2017
Reason for Change	Change to Product		
Change Type Description	This letter is to inform you that changes are being made to the part(s) identified in this Notice. The change will affect the fit, form, function or appearance of the parts. Or, it may result in a change to the specification. The pictures below show an example of the possible differences.		
Reason for Short Notice	Force Majeure		
Assessment of Change	Product will be fully qualified before it is shipped. Qualification reports are available upon request.		
Internal Molex Qualification Date	January 25, 2017		
Sample Availability Date (Changed Part)	January 25, 2017		
Planned Implementation Date	January 25, 2017		
Method of Identifying Change	Product made after planned implementation date can contain the change		

RELEASED

Before Change

- Molex is changing the tin plating on the 2.8mm male and female terminal. Examples shown below.

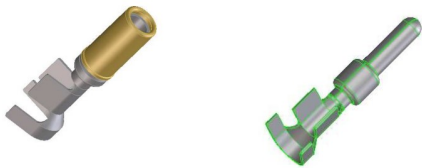

1 Molex Confidential Information
© 2016 Molex - All Rights Reserved. Unauthorized Reproduction/Distribution is Prohibited.



After Change

Overview

- Molex is changing the tin plating on the 2.8mm male and female terminal due to a change at the plating supplier. Molex's supplier is no longer able to make the current plating. The new plating is an improved version of the existing plating.
- Product Impact
 - There is no negative impact to fit, form or function of the product.
- Part Number Impact
 - 980140100, 980140200, 980140300, 980120102, 980120202, 980120302, 980121102, 9801202 & 980121302
- PPAP and samples available upon request

2 Molex Confidential Information
© 2016 Molex - All Rights Reserved. Unauthorized Reproduction/Distribution is Prohibited.





Product Change Notification (PCN)

You may address any technical inquiries regarding this PCN by sending E-mail to pcn_coordinator@molex.com or your Local Sales Engineer.

Note: While responding, please retain "**PCN Notification:501709**" in the e-mail Subject line for faster response.

RELEASED

Molex, LLC
2222 Wellington Court
Lisle, IL 60532
TEL: 630-969-4747
www.molex.com