

TYS4020101M-10

PHYSICAL DIMENSIONS:

A	4.00 ± 0.20
B	4.00 ± 0.20
C	2.00 MAX.
D	1.20 ± 0.30
E	1.60 ± 0.30

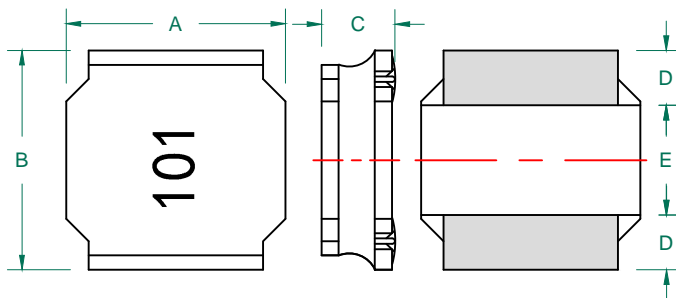

RECOMMENDED SOLDERING CONDITIONS

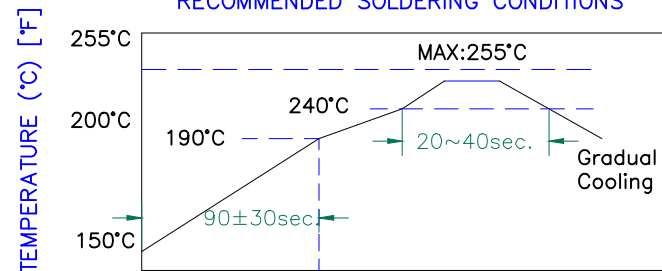

LAND PATTERNS FOR REFLOW SOLDERING

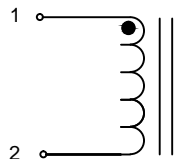
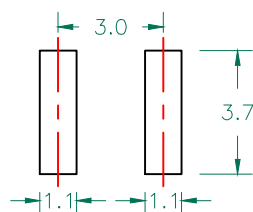

RoHS

ELECTRICAL SPECIFICATION

	Min	Nom	Max
INDUCTANCE (uH) L @ 100 KHz/1V ±20%	80	100	120
DCR (Ω)		1.550	2.015

CHARACTERISTICS OF TEMPERATURE RISE

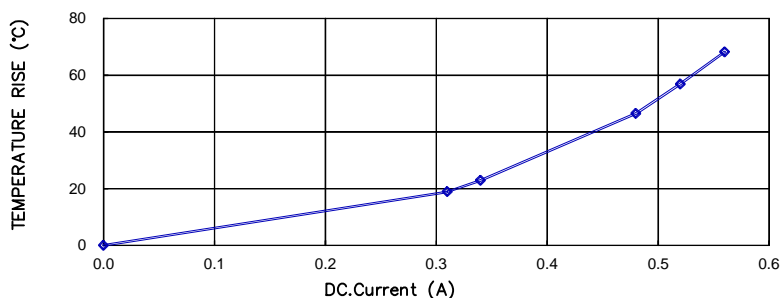

CURRENT VS INDUCTANCE DROP IN RATES

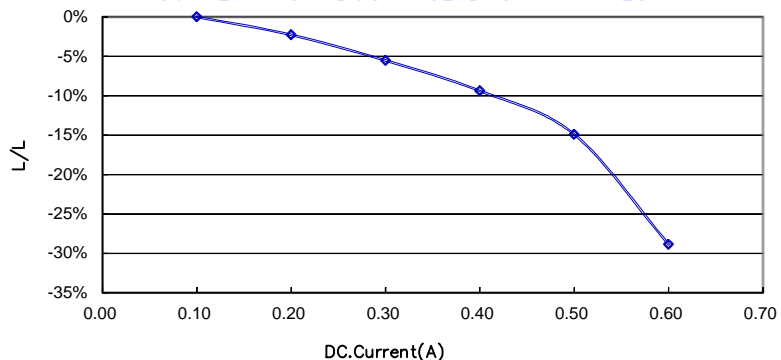

Saturation Current(A)	0.48
SRF (MHz)	6.3
Temperature Rise Current (A)	0.31

NOTES: UNLESS OTHERWISE SPECIFIED

- OPERATING TEMPERATURE RANGE: -40°C TO +125°C (INCLUDING SELF-HEATING) .
- STORAGE TEMPERATURE RANGE (PACKAGING CONDITIONS): -10°C TO +40°C AND RH 70% (MAX.)
- UNLESS OTHERWISE SPECIFIED, THE STANDARD ATMOSPHERIC CONDITIONS FOR MEASUREMENT/TEST AS:
 - AMBIENT TEMPERATURE: 20±15°C.
 - RELATIVE HUMIDITY: 65%±20%.
- DEFINITION OF SATURATION CURRENT (ISAT): DC CURRENT AT WHICH THE INDUCTANCE DROPS ≤30% FROM ITS VALUE WITHOUT CURRENT.
- DEFINITION OF TEMPERATURE RISE CURRENT (IRMS): DC CURRENT THAT CAUSES THE TEMPERATURE RISE (ΔT ≤40°C) FROM 20°C AMBIENT.

DIMENSIONS ARE IN mm .				This print is the property of Laird Tech. and is loaned in confidence subject to return upon request and with the understanding that no copies shall be made without the written consent of Laird Tech. All rights to design or invention are reserved.			
REV	DESCRIPTION	DATE	INT	PROJECT/PART NUMBER:	REV		
C	CHANGE DIMENSIONS: D/E	01/11/18	QUI	TYS4020101M-10	C	POWER INDUCTOR	QUI
B	CHANGE LOGO	08/06/15	QUI	DATE: 09/06/12	SCALE: NTS		SHEET: 1 of 1
A	ORIGINAL DRAFT	09/06/12	QUI	CAD #	TOOL # -		
REV	DESCRIPTION	DATE	INT	TYS4020101M-10-C			