

PART NUMBER	REV	FIRST USED
567273-3	H	565435-5

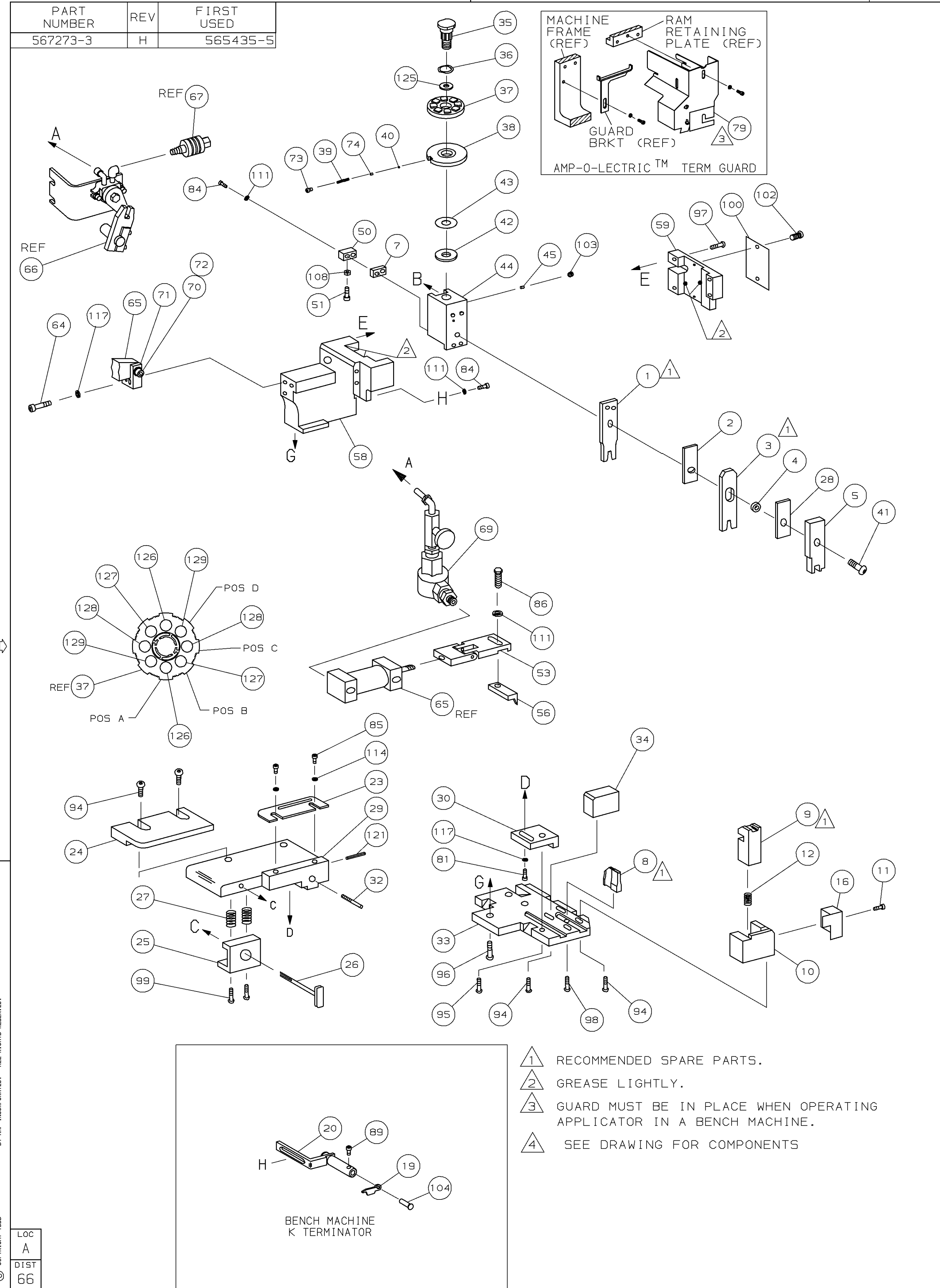

TERMINAL NAME: PIN & SOCKET

PIN	SOCKET	CRIMPING DATA			
PAD LTR		CRIMP HEIGHT	WIRE SIZE		
770385-1	770383-1	A .073 ± .002 [1.85 ± 0.05mm]	14		
		B .066 ± .002 [1.68 ± 0.05mm]	2 (18)		
		C .062 ± .002 [1.57 ± 0.05mm]	16		
		D .055 ± .002 [1.4 ± 0.05mm]	18		
CRIMP	SIZE	TYPE	RANGE		
WIRE	.090 [2.29mm]	F	20-14		
INSUL	.180 [4.57mm]	F	.140 MAX		
WIRE STRIP LENGTH	TERM APPL SPEC	FEED	APPL INSTRUCTION	SET UP GAGE	LAYOUT
-	-	.900	408-8040	458637-1	1299

QTY	REQD PER ASSY	PARTS LIST	DESCRIPTION	ITEM NO	
2	-	C	5-354778-6	PIN, WIRE DISC (.2775)D	129
2	-	C	4-354778-0	PIN, WIRE DISC (.2695)C	128
2	-	C	3-354778-3	PIN, WIRE DISC (.2660)B	127
2	-	C	1-354778-6	PIN, WIRE DISC (.2575)A	126
1	-	A	986950-1	WASHER, FLAT PRECISION	125
				124	
				123	
				122	
1	-	A	4-21028-0	PIN, SLT SPR (#.093x.75) ST GDE PL	121
				120	
				119	
3	-	A	21024-5	WASHER, LOCK (#10) ADJ BLOCK	117
				116	
				115	
2	-	A	21024-2	WASHER, LOCK (#4) FRONT STP GUIDE	114
				113	
				112	
4	-	A	21024-4	WASHER, LOCK (#8) STRIPPER	111
				110	
				109	
1	-	A	21018-5	NUT, HEX (NO. 6) HOLDDOWN	108
				107	
				106	
				105	
1	-	A	992031-1	PIN, CLEVIS	104
1	-	A	21009-2	SCR, SKT SET (1/4-20x.25 LW) RAM	103
2	-	A	21017-2	SCR, DRIVE (#2x.19) ID PLATE	102
				101	
1	-	B	461264-1	PLATE, IDENTIFICATION	100
2	-	A	3-21002-0	SCR, BHC (10-32x.88) DRAG	99
1	-	A	22733-8	SCR, BHC (8-32x.38 LW) ANVIL	98
4	-	A	2-21002-9	SCR, BHC (10-32x.75) CAP	97
3	-	A	2-22733-8	SCR, BHC (1/4-20x.62) HSG	96
1	-	A	2-21002-7	SCR, BHC (10-32x.50) SG ADJ BLK	95
6	-	A	2-21002-2	SCR, BHC (8-32x.50) TERM H DWN	94
				93	
				92	
				91	
				90	
1	-	A	7-21000-9	SCR, SHC (4-40x.19) STRIPPER	89
				88	
				87	
1	-	A	2-22603-1	SCR, HEX HD (8-32x.38) FEED FINGER	86
2	-	A	1-21000-3	SCR, SHC (4-40x.25) F ST GUIDE	85
3	-	A	2-21000-7	SCR, SHC (8-32x.50) STRIPPER	84
				83	
				82	
1	-	A	3-21000-4	SCR, SHC (10-32x.38) SG ADJ BL	81
				80	
1	-	B	462992-7	GUARD ASSY	79
				78	
				77	
				76	
				75	
1	-	A	690603-1	SPRING, ASSIST	74
1	-	A	23030-1	SCR, SHC (6-32x.25 SL) INS DISC	73
1	-	A	4-21002-8	SCR, BHC (3/8x1.00) FEED MT	72
1	-	B	459610-3	MOUNT, FEED BRACKET	71
-3	U/M	DWG SIZE	PART NO	DESCRIPTION	ITEM NO

QTY	REQD PER ASSY	PARTS LIST	DESCRIPTION	ITEM NO	
1	-	C	454220-1	CAP, RAM	59
1	-	D	454485-1	HOUSING	58
				57	
1	-	B	2-694433-1	PAWL, FEED	56
				55	
				54	
1	-	B	461062-1	FEED FINGER ASSY	53
				52	
1	-	A	811242-2	BUMPER, HOLDDOWN	51
1	-	A	690753-1	SPACER, TONKER	50
				49	
1	-	A	22374-7	VALVE, QUICK EXHAUST	48
1	-	A	22304-1	NIPPLE, HEX 1/8 NPT	47
				46	
1	-	A	690191-1	PLUG, NYLON	45
1	-	C	455673-1	RAM	44
1	-	A	690125-1	WASHER, LAMINATED	43
1	-	A	690124-1	WASHER, RAM	42
1	-	A	690686-2	BOLT, CRIMPER (5/16x1.00)	41
1	-	A	23241-6	BALL, STEEL	40
1	-	A	690170-1	SPRING, COMPRESSION	39
1	-	C	690142-1	DISC, INSULATION	38
1	-	D	354777-1	WIRE DISC, PLASTIC	37
1	-	A	22480-5	WASHER, SPRING	36
1	-	B	690212-1	POST, RAM	35
1	-	B	2-690786-6	SUPPORT, TERMINAL	34
1	-	D	455675-1	PLATE, BASE	33
1	-	A	690432-3	SCREW, ADJUSTMENT	32
				31	
1	-	B	455689-1	BLOCK, STRIP GUIDE ADJ	30
1	-	C	455671-1	PLATE, STRIP GUIDE	29
1	-	C	455888-8	SPACER, FRONT SHEAR DEP	28
2	-	A	1-22284-0	SPRING, DRAG	27
1	-	B	690546-1	LEVER, DRAG RELEASE	26
1	-	B	240792-1	DRAG, TERMINAL	25
1	-	D	2-90765-2	GUIDE, STRIP (REAR)	24
1	-	A	690438-1	GUIDE, STRIP (FRONT)	23
				22	
				21	
1	-	A	679218-1	STRIPPER WIRE STOP ASSY	20
1	-	B	458949-1	STRIPPER	19
				18	
				17	
1	-	B	691667-3	GUARD, CHIP (FRONT)	16
				15	
				14	
				13	
1	-	A	5-22280-0	SPRING, SHEAR	12
1	-	B	690461-1	STOP, SHEAR	11
1	-	C	690459-1	HOLDER, SHEAR (FRONT)	10
1	-	C	843667-1	SHEAR, FLOAT (FRONT)	9
1	-	C	6-803653-5	ANVIL	8
1	-	C	4-240641-8	SPACER, DEPRESSOR (REAR)	7
				6	
1	-	C	2-455889-8	DEPRESSOR, SHEAR (FRONT)	5
1	-	B	238011-1	SPACER, BLOCK CRIMPER	4
1	-	C	1-683453-9	CRIMPER, INSULATION	3
1	-	C	2-455888-1	SPACER, CRIMPER	2
1	-	C	4-456406-0	CRIMPER, WIRE	1

THIS DRAWING IS A CONTROLLED DOCUMENT.

RELEASED FOR PUBLICATION
 JAN 4, 1999
 BY AMP INCORPORATED. ALL RIGHTS RESERVED.
 THIS DRAWING IS UNPUBLISHED.
 COPYRIGHT 1989
 LOC A
 DIST 66

REVISION OF EACH ASSY NO (WHEN BLANK, USE DWG REVISION)

QTY	REQD PER ASSY	PARTS LIST	DESCRIPTION	ITEM NO	
-3	U/M	DWG SIZE	PART NO	DESCRIPTION	ITEM NO

DIMENSIONS IN INCHES. DO NOT SCALE PRINT. TOLERANCES UNLESS OTHERWISE SPECIFIED.
 2 PLC DEC ± .25
 3 PLC DEC ± .125
 4 PLC DEC ± .0625
 ANGLES ± -
 SURF TEXTURE: ✓
 REMOVE BURRS, BREAK SHARP EDGES R.015 MAX

MATL - HT TR - FIN -

DR 7/18/95 APP 7-30-95
 L. COLLINS T. BEDDICK
 CHK 7-30-95 REL 9/26/95
 C. ERISMAN B. MORGAN

AMP AMP Incorporated
 Harrisburg, PA 17105-3608

NAME: SIDE FEED HDM APPLICATOR MACHINE REF: MINI APPL
 SCALE: - DWG NO: 567273-3 SHEET: 1 OF 1 REV: H

CASE CODE: 00779 CUSTOMER AND ASSEMBLY DRAWING RESTRICTED TO