

REV.	EN. NO.	DESCRIPTION	SIGN	DATE
C1	N/A	INITIAL DRAWING	Liu	2019/08/13

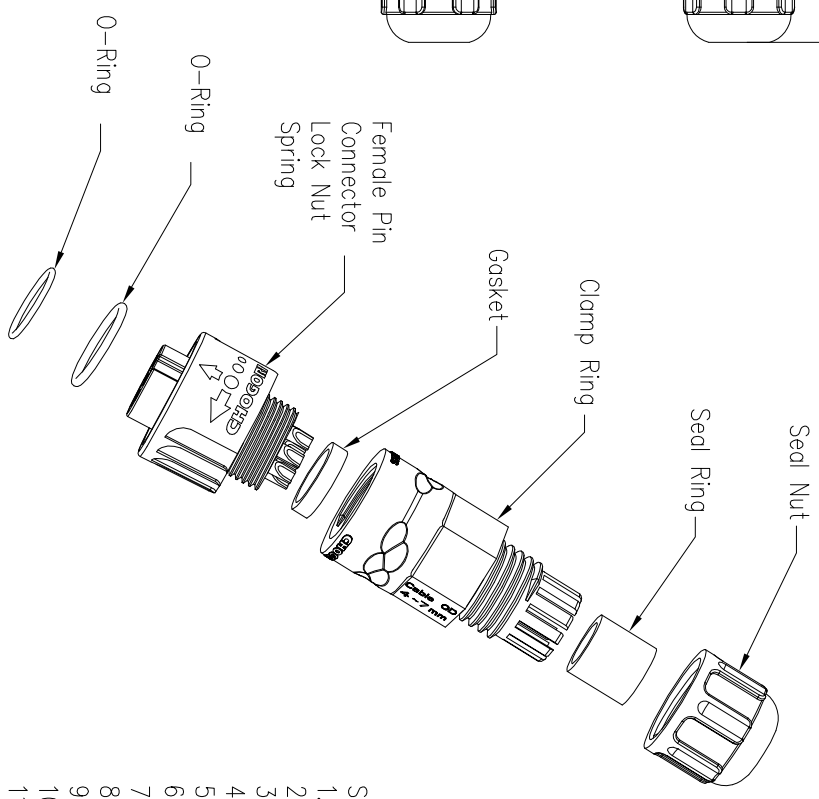
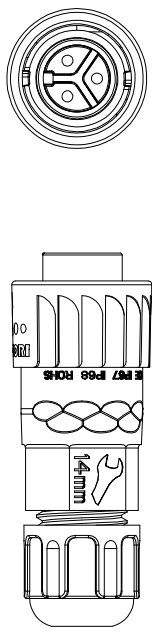
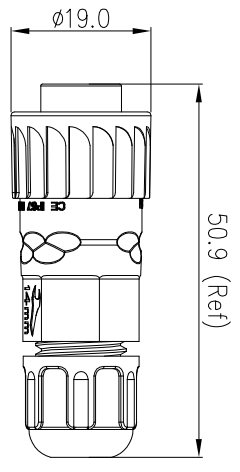

Specification:

- 1.Operation Temperature: -45°C~105°C.
- 2.Insulation Resistance: 100MΩ at DC500V.
- 3.Contact Resistance: <10mΩ
- 4.Withstand Voltage: 2000V AC
- 5.Operating Current: 10A
- 6.Operating Voltage: AC 300V
7. Waterproof Rate: IP67 (Mated)
8. Seal Nut: Nylon, Black
9. Seal Ring: Silicon, Black
10. Clamp Ring: Nylon, Black
11. Gasket: Silicon, Red
12. Female Pin: Copper Alloy, Gold Plated
13. Connector: Nylon+GF, Black
14. Lock Nut: Nylon, Orange
15. Spring: SUS
16. O-Ring: Silicon, Red
17. RoHS Compliant.
18. UL Compliant.
19. Cable Range OD: φ3.5mm~φ6.8mm
20. Mating Cap: 804-00009-00

22XXXX231-01	Pin Number
2 Pin	3 Pin
P/N: 22002231-01	P/N: 22003231-01
Pin Assignments Front View	

UNIT: mm	DESCRIPTION
	Standard Series Push Lock Male Plug With Female Pin
TOLERANCE	SCALE
.X ±0.25	1:1
.XX ±0.15	SHEET 1 OF 1
.XXX ±0.05	
ANGLES ±1°	

REV	SIZE	SHEET	OF
C1	A4	1	1
* : Inspection Item			

PART NO	22XXXX231-01
DWG NO	
CUSTOMER	

DRAWN BY	Liu	DATE	2019/08/13
CHECKED BY	Mo	DATE	2019/08/13
APPROVED BY	Panison	DATE	2019/08/13

CHOGORI