

PRINT TEXT(COLOR:WHITE)

53.50

7.60

Molex  
GPS&WIFI 2.4/5GHZ  
Combo Balance PCB ANT  
146220

0.80 ±0.10

3.1 Max  
WITH SOLDER PASTE

∅3.00 (2X)

16.60

7.0

SOLDERING PADS

PCB

∅1.13 ±0.05

CABLE

VERTICAL DIRECTION SEE NOTE 2

3D VIEW

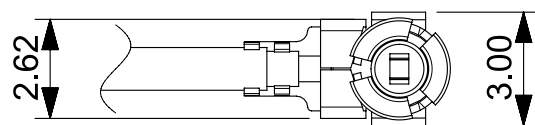
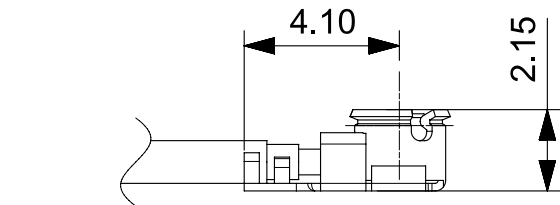

CONNECTOR

ITEW	MATERIAL NO.	CABLE LENGTH "L"
1	1462200050	43mm
2	1462200100	93mm
3	1462200150	143mm
4	1462200200	193mm
5	1462200250	243mm
6	1462200300	293mm

NOTE:

- MATERIAL:  
PCB 53.5mm\*16.6mm THICKNESS 0.8mm  
PATTERN Cu: 18~20um  
CONNECTOR:OD1.13,2.5H UFL CONNECTOR(GOLD PLATED)
- CAN NOT LIFT UP CABLE IN VERTICAL DIRECTION
- Ni&Au PLATING IN THE SOLDER PAD AREA:Ni:2~6um,Au:Min 0.025um THICKNESS
- APPLICATION SPEC REFER TO AS OF 1462200100
- PRODUCT SPEC REFER TO PS OF 1462200100
- PACKAGING SPEC REFER TO PK OF 1462200100

QUALITY SYMBOLS		THIS DRAWING CONTAINS INFORMATION THAT IS PROPRIETARY TO MOLEX ELECTRONIC TECHNOLOGIES, LLC AND SHOULD NOT BE USED WITHOUT WRITTEN PERMISSION										
▽A	= 0	EC NO: 122478 DRWN: KCheng CHK'D: Colin Xu APPR: Stary Song	GENERAL TOLERANCES (UNLESS SPECIFIED)		DIMENSION UNITS	SCALE						
▽E	= 0		ANGULAR TOL ± 0.5 °		mm	3.5:1						
▽F	= 0		4 PLACES ±	DRWN BY	DATE	KCheng 2017/09/26						
▽	= 0		3 PLACES ± 0.05	CHK'D BY	DATE	Colin Xu 2017/09/26		SD FOR GPS/WIFI (2.4/5GHz) COMBO BALANCE PCB ANTENNA				
▽C	= 0		2 PLACES ± 0.15	APPR BY	DATE	Stary Song 2017/09/26		PRODUCT DESIGN DRAWING				
▽	= 0		1 PLACE ± 0.2	DRAFT WHERE APPLICABLE MUST REMAIN WITHIN DIMENSIONS		DRAWING SIZE	THIRD ANGLE PROJECTION	SERIES	MATERIAL NUMBER	CUSTOMER		
▽	= 0		0 PLACES ± 0.5	A3				146220	SEE TABLE	GENERAL MARKET		
▽	= 0			C				DOCUMENT NUMBER		DOC TYPE	DOC PART	SHEET NUMBER
								SD-146220-050		PSD	SD	1 OF 1

RELEASE STATUS	RELEASE DATE
----------------	--------------