

ERO610T682MYGO

Aliases (C828YG682M440X, ERO610RK4680MYGO)

Obsolete

ERO610 SFTY X1-440 Y2-250, Ceramic, 6800 pF, 20%, 440 VAC (X1), 250 VAC (Y2), Y5U, Lead Spacing = 12.5mm

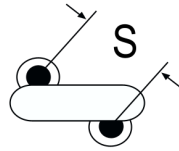
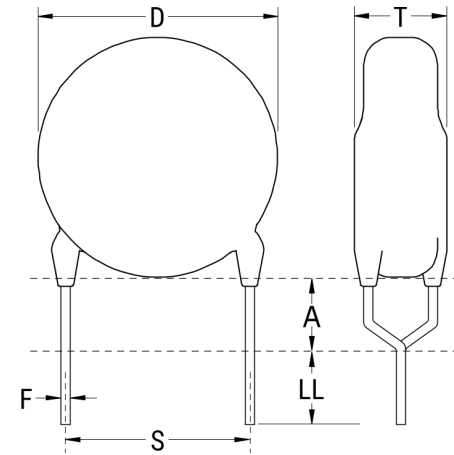

The measurement position of Lead Spacing (S) and Width (V) is critical in straight lead capacitors.

Click [here](#) for the 3D model.

Dimensions

D	17mm MAX
T	4.5mm MAX
S	12.5mm NOM
LL	2.8mm +1.5mm
F	0.6mm +/-0.05mm
A	6mm MAX
V	1.6mm +/-0.5mm

Packaging Specifications

Packaging	Bulk, Bag
-----------	-----------

General Information

Series	ERO610 SFTY X1-440 Y2-250
Style	Radial Disc
Description	Ceramic Single Layer Safety Disc Capacitors
RoHS	Yes
Termination	Tin
Qualifications	UL, CSA, CAN, ENEC, VDE
AEC-Q200	No

Specifications

Capacitance	6800 pF
Capacitance Tolerance	20%
Voltage AC	440 VAC (X1), 250 VAC (Y2)
Temperature Range	-40/+125°C
Temperature Coefficient	Y5U
Dissipation Factor	2.5%
Insulation Resistance	6 GOhms
Safety Class	X1/Y2