

Extractor Tool

**Application Tooling
Specification Sheet**

**Order No. 11-03-0043
Engineering No. HT60923A**

FEATURES

- This tool is designed to extract many different terminals from various plug and receptacle housings. See chart below.

SCOPE

Products:

Terminal Series No.	Description	Housings Series No.	Terminal Order No.							
43030	Micro-Fit 3.0™ Crimp Terminal 20-24 AWG	43025 43645 44133	43030-0001	43030-0002	43030-0003	43030-0004	43030-0005	43030-0006		
			43030-0007	43030-0008	43030-0009	43030-0010	43030-0011	43030-0012		
			43030-0051	43030-0052	43030-0053	43030-0056	43030-0057	43030-0058		
			43030-0059	43030-0080	43030-0081	43030-1001				
43031		43020 43640 44300	43031-0001	43031-0002	43031-0003	43031-0004	43031-0005	43031-0006		
			43031-0007	43031-0008	43031-0009	43031-0010	43031-0011	43031-0012		
			43031-0016	43031-0017	43031-0018	43031-0019	43031-0051	430310052		
			430310053	43031-0057	43031-0059	43031-0102	43031-0103	43031-0106		
44372		Micro-Fit 3.0™ High Force 20-24 AWG	43025 43645 44133	44372-0002						
45773		Micro-Fit 3.0™ Lubed Female 20-30 AWG	43025 43695 44133	45773-0001	45773-0002	45773-0003	45773-0004	45773-0005	45773-0006	
	45773-0053									
45807	Micro-Fit Plus 3.0™ 18 AWG	43025 43645 44133 46623	45807-0003	45807-0038						
46235	Micro-Fit 3.0™ Crimp Terminal 20-24 AWG	43025 43645 44133	46235-0001	46235-0002	46235-0003	46235-0004	46235-5001	46235-5002		
			46235-5004	46235-5003						
50011	2.0mm (.079") Low Profile Receptacle Terminal 24-34 AWG	51004 51049	50011-8000	50011-8100	39-00-0422					
50031		51004 51049	50031-8000	50031-8100						
50058	1.25mm (.049") Pitch PicoBlade™ 26-32 AWG	51021	50058-8000	50058-8099	50058-8100	50058-8200	50058-8300	50058-8400		
			50058-8500							
50061	1.25mm (.049") Pitch Board-In Crimp Terminal 28-32 AWG	51022	50061-8000	50061-8018	50061-8028	50061-8099	50061-8100	50061-8118		
			50061-8128							
50079	1.25mm (.049") Pitch PicoBlade™ Crimp Terminal 26-28 AWG	51021	50079-8000	50079-8053	50079-8099	50079-8100	50079-8153			
39-00-0413			39-00-0414							
50080			50080-8000	50080-8100						
50125		51047	50125-8000	50125-8100						

Terminal Series No.	Description	Housings Series No.	Terminal Order No.					
50133	1.25mm (.049") Pitch PicoBlade™ 28-32 AWG	51047	50133-8000	50133-8100				
50200	2.0mm (.079") Low Profile 22-32 AWG	51004 51049	50200-8000	50200-8100				
50212	Micro-Latch™ 2.00mm (.079") Pitch 24-30 AWG	5109 51065 51090	50212-8000	50212-8100	50212-8200	50212-8300	39-00-0424	
50372	2.00mm (.079") Pitch 22-26 AWG	5109 51065 51090	50372-8000	50372-8100				
50420	4.00mm (.157") Pitch OBD-II Wire-to-Wire	51115 51116	50420-8000	50420-8100	50420-8200			
560085	DuraClik™ Crimp Terminal, Female, 22-26 AWG	502351	560085-0101					

Note: All individual terminals may be extracted from the housing using this tool.

OPERATION:

For 43030, 43031, 44372, 45807 and 46235 Terminal Series:

1. Insert the tip of the tool on either side of the terminal until it stops. See Figure 1. Rotate tool clockwise and then counterclockwise approximately 25° to 30° in each direction, once or twice.
2. Repeat steps 1 and 2 on the opposite side of terminal.
3. Pull on the wire, and remove the terminal from the housing. See Figure 2.

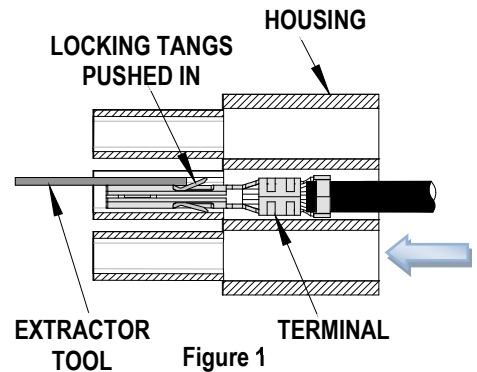

Note: When a terminal is removed in this manner, the locking tangs are damaged, and the terminal is not reusable.

For 50011, 50031, 50058, 50061, 50079, 50080, 50125, 50133, 50200, 50212 and 50372, and 560085 Terminal Series:

1. Hold the housing with the locking tang facing up. Bend the wire down, and insert the tip of the tool into the housing under the locking tang. See Figure 3.

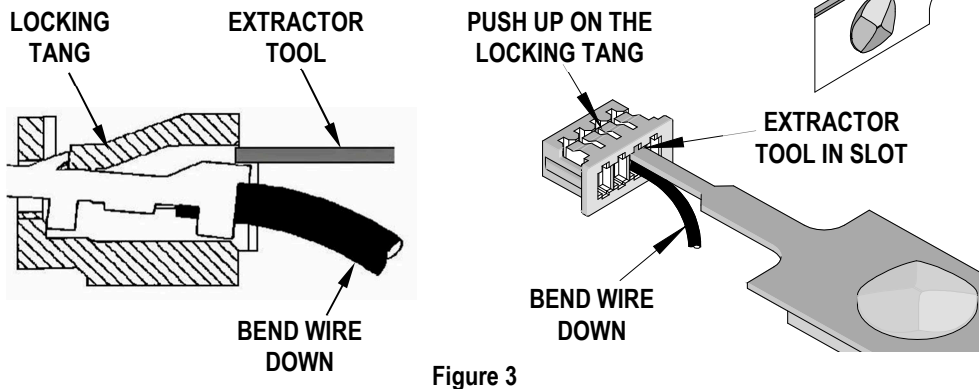
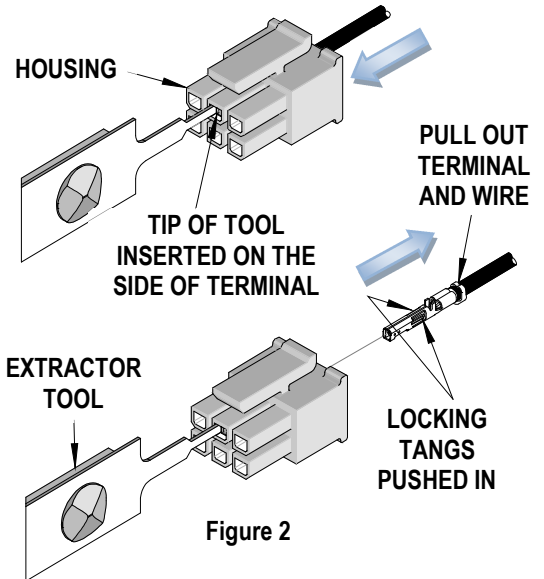

2. Hold the wire against the extractor tool, and pull out the wire and the extractor tool at the same time. See Figure 4.

Note: When reusing the housing, remember to bend back the locking tang when inserting another terminal.

For 50420 Terminal Series:

1. Push the terminal forward in the direction of the arrow before using the extractor tool.
2. Insert the tip of the extractor tool on an angle above the terminal into the slot on the top of the connector housing.
3. While rotating the extraction tool down, bend the terminal locking tang down, and push the terminal back through the connector slot. Make sure that the terminated wire is pulled out at the same time. See Figure 5.

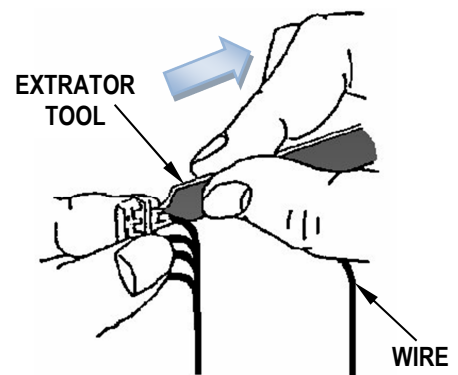

Figure 4

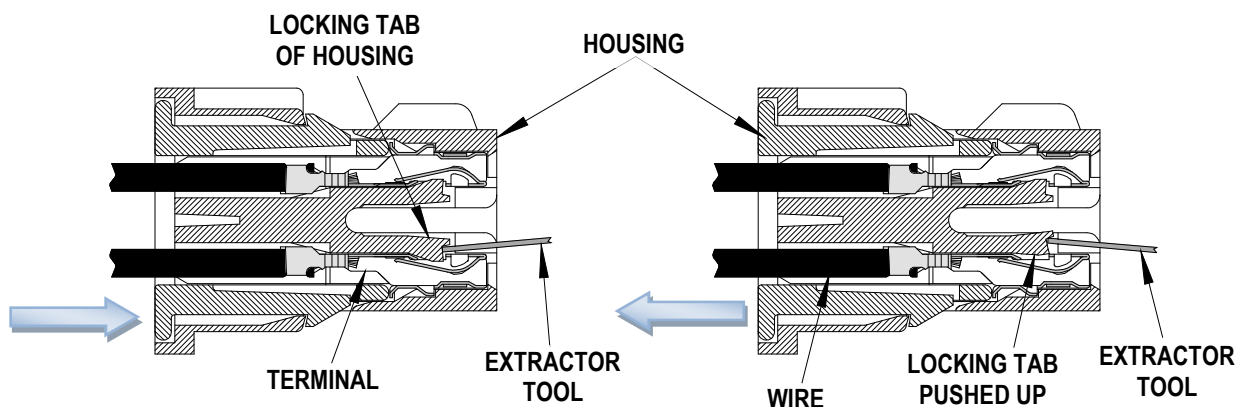

Figure 5

CAUTION: This extractor tool should be used to extract the terminal only. Using it for unintended purposes may cause injury or damage to parts. Be careful not to deform the end of the terminal.

CAUTION: Molex specifications are valid only when used with Molex terminals, applicators and tooling.

Molex does not offer repair parts for extractor tools due to the inexpensive nature of these tools.

Application Tooling Support

Phone: +1-402-458-TOOL (8665)
E-Mail: applicationtooling@molex.com
Website: www.molex.com/applicationtooling