

THIS DRAWING IS A CONTROLLED DOCUMENT.

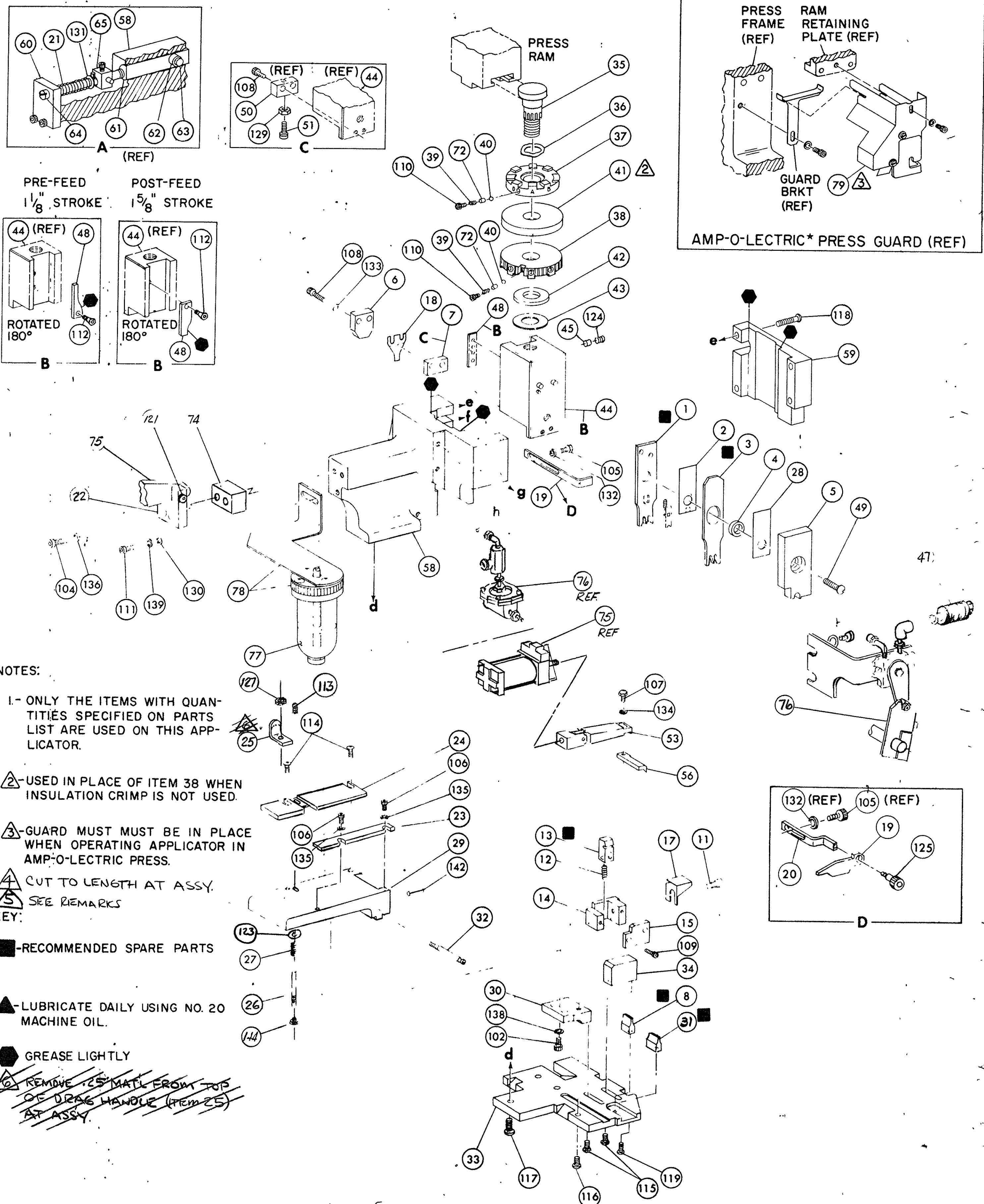

- NOTES:**
- 1- ONLY THE ITEMS WITH QUANTITIES SPECIFIED ON PARTS LIST ARE USED ON THIS APPLICATOR.
  - 2- USED IN PLACE OF ITEM 38 WHEN INSULATION CRIMP IS NOT USED.
  - 3- GUARD MUST BE IN PLACE WHEN OPERATING APPLICATOR IN AMP-O-LECTRIC PRESS.
  - 4- CUT TO LENGTH AT ASSY.
  - 5- SEE REMARKS KEY.
  - 6- RECOMMENDED SPARE PARTS
  - 7- LUBRICATE DAILY USING NO. 20 MACHINE OIL.
  - 8- GREASE LIGHTLY
  - 9- REMOVE 1/2" MATL FROM TOP OF DRAG HANDLE (ITEM 25) AT ASSY.

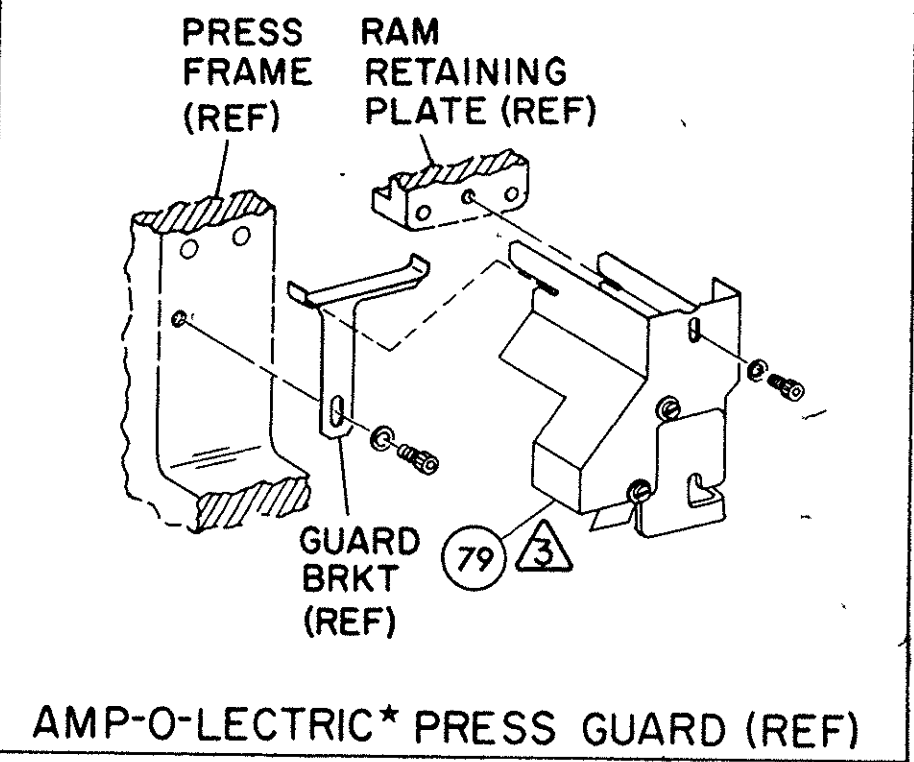

QTY	PART NO	DESCRIPTION	ITEM NO
1	21045-3	RING, RETAINING 'C' (.187 DIA) FEED FINGER PIN	145
1	21021-3	NUT, HEX SELF LOCK (8-32) DRAG STD	144
1	5-21028-1	PIN, SLOT SPR (.125 DIA X .50) ADJ ROD	143
1	4-21028-0	PIN, SLOT SPR (.093 DIA X .75) STR G PLATE	142
1	1-21030-1	PIN, DOWEL (.187 DIA X .50) LEVER	141
1	1-21030-6	PIN, DOWEL (.187 DIA X 1.25) HOUSING	140
1	21024-5	WASHER, LOCK (NO 10) LUB ASSY	139
1	21024-5	WASHER, LOCK (NO 10) STRIP GUIDE ADJ BLOCK	138
1	21024-5	WASHER, LOCK (NO 10) ADJ PLATE	137
1	21024-5	WASHER, LOCK (NO 10) FEED GUIDE ROD	136
2	21024-2	WASHER, LOCK (NO 4) FRONT STRIP GUIDE	135
1	21024-4	WASHER, LOCK (NO 8) FEED FINGER	134
2	21024-4	WASHER, LOCK (NO 8) DEPRESSOR	133
1	21024-4	WASHER, LOCK (NO 8) STRIPPER	132
1	21899-4	WASHER, FLAT (5/16 DIA) SCREW ADJ	131
1	21899-2	WASHER, FLAT (NO 10) LUB ASSY	130
1	21018-5	NUT, HEX MACH (6-32) HOLDDOWN	129
1	21018-5	NUT, HEX MACH (6-32) FEED ADJ	128
1	21068-6	NUT, HEX MACH (8-32) DRAG	127
1	22353-8	SCR, SHLD (.187 DIA X .250 LG) DRAG LEVER	126
1	456567-1	SCR, SHLD (.188 DIA X .125 LG) STRIPPER	125
1	21009-2	SCR, SKT SET (1/4-20 X .25) (LOC-WEL) RAM	124
1	1-21899-3	WASHER, FLAT (#8) DRAG	123
1	6-23715-5	SCR, PAN HD MACH (6-32 X 1.50) FEED ADJ	122
1	4-21002-8	SCR, BUT HD SKT CAP (3/8-16 X 1.00) AIR FEED	121
1	2-21002-9	SCR, BUT HD SKT CAP (10-32 X .75) DRAG	120
2	2-2733-8	SCR, BUT HD SKT CAP (8-32 X .38) (LOC-WEL) ANVIL	119
4	2-21002-9	SCR, BUT HD SKT CAP (10-32 X .75) CAP	118
3	17177-1	SCR, BUT HD SKT CAP (1/4-20 X .75) HOUSING	117
1	2-21002-7	SCR, BUT HD SKT CAP (10-32 X .50) SG ADJ BLOCK	116
2	2-21002-2	SCR, BUT HD SKT CAP (8-32 X .50) SHEAR	115
2	1-21002-7	SCR, BUT HD SKT CAP (6-32 X .38) R STRIP GUIDE	114
1	3-21008-0	SCR, SOC SET (6-32 X .31)	113
1	2-21003-0	SCR, FLAT HD SKT CAP (6-32 X .50) CAM	112
1	3-21000-4	SCR, SKT HD CAP (10-32 X .38) LUBRICATOR ASSY	111
1	23030-1	SCR, SKT HD CAP (6-32 X .25) (LOC-WEL) CP DISC	110
2	2-21000-6	SCR, SKT HD CAP (6-32 X .38) REAR SHEAR PLATE	109
1	2-22603-1	SCR, HEX HD MACH (8-32 X .38) FEED FINGER	107
2	1-21000-9	SCR, SKT HD CAP (6-32 X .50) F STRIP GUIDE	106
1	2-21000-7	SCR, SKT HD CAP (8-32 X .50) STRIPPER	105
2	2-21000-7	SCR, SKT HD CAP (10-32 X 1.00) FEED ROD GUIDE	104
1	3-21000-6	SCR, SKT HD CAP (10-32 X .62) FEED ADJ BLOCK	103
1	3-21000-4	SCR, SKT HD CAP (10-32 X .38) SG ADJ BLOCK	102
1	3-21000-4	SCR, SKT HD CAP (10-32 X .38) PIVOT BLOCK	101
1	455755-2	GUARD ASSY	79
1	1-465184-0	LUBRICATOR ASSY	78
1	692655-1	OIL, LUBRICATING	77
1	461065-1	VALVE ASSY - 692655-5	76
1	461690-1	AIR FEED ASSY	75
1	461690-1	SPACER AIR FEED	74
1	690603-1	PLATE, STRIP GUIDE COVER	73
1	690603-1	SPRING, ASSIST	72
1	690603-1	SPACER	71
1	690603-1	NUT, HEX	70
1	690603-1	PLATE, ADJUSTMENT	69
1	690603-1	SHAFT, PIVOT	68
1	690603-1	BUSHING	67
1	690603-1	LEVER, INTERMEDIATE	66
1	690603-1	BLOCK, PIVOT	65
1	690603-1	SCREW, ADJUSTMENT FEED ROD	64
1	690603-1	PIN, CAM ROLLER	63
1	690603-1	ROLLER, CAM	62
1	690603-1	ROD, FEED	61
1	690603-1	GUIDE, FEED ROD	60

QTY	PART NO	DESCRIPTION	ITEM NO
1	454220-1	CAP, HOUSING	59
1	454485-1	HOUSING	58
1	468288-1	TERMINAL GUIDE ASSY	57
1	694433-9	PAWL, FEED	56
1	461062-1	PIN, FEED FINGER	55
1	461062-1	SPRING, FEED FINGER	54
1	461062-1	FEEL FINGER ASSY	53
1	461062-1	LEVER, TERMINAL FEED ARM	52
1	461062-1	BUMPER, HOLDDOWN	51
1	461062-1	SPACER, TONKER	50
1	461062-1	BOLT, CRIMPER	49
1	7-21002-6	CAM FEED STROKE	48
1	24042-2	VALVE, SHUT-OFF	47
1	459456-1	APPLICATOR, BASIC (SUB ASSY)	46
1	690191-1	PLUG, NYLON	45
1	455673-1	RAM	44
1	690125-1	WASHER, LAMINATED	43
1	690124-1	WASHER, RAM	42
1	690223-1	DISC, SPACER	41
1	23241-6	BALL, STEEL	40
1	690170-1	SPRING, COMPRESSION	39
1	3-690141-8	DISC, INSULATION	38
1	22480-5	DISC, WIRE	37
1	690212-1	WASHER, SPRING	36
1	690212-1	POST, RAM	35
1	468041-1	SUPPORT, TERMINAL	34
1	690432-3	PLATE, BASE	33
1	468043-4	SCREW, ADJUSTMENT	32
1	468043-4	ANVIL, RIGHT	31
1	455689-1	BLOCK, STRIP GUIDE ADJ	30
1	460042-5	PLATE, STRIP GUIDE	29
1	2-22281-3	SPACER, FRONT SHEAR DEPRESSOR	28
1	22354-8	SPRING, DRAG	27
1	1-387650-6	STD, DRAG	26
1	460462-6	DRAG, STOCK	25
1	460461-4	GUIDE STRIP (REAR)	24
1	459610-1	GUIDE, STRIP (FRONT)	23
1	4-22284-9	MOUNT, FEED BRACKET	22
1	4-22284-9	SPRING, FEED RETURN	21
1	4-22284-9	ARM, STRIPPER	20
1	468715-1	STRIPPER	19
1	468715-1	HOLDER, TERMINAL	18
1	691668-1	GUARD, CHIP (REAR)	17
1	691668-1	GUARD, CHIP (FRONT)	16
1	691668-1	PLATE, SHEAR (REAR)	15
1	690462-5	HOLDER, SHEAR (REAR)	14
1	469542-2	SHEAR, FLOAT (REAR)	13
1	5-22280-0	SPRING, SHEAR	12
1	1-21000-9	STOP, SHEAR 6-32 X .30 SOC HD CAP	11
1	1-21000-9	HOLDER, SHEAR (FRONT)	10
1	1-21000-9	SHEAR, FLOAT (FRONT)	9
1	468042-4	ANVIL, LEFT	8
1	468042-4	SPACER, DEPRESSOR (REAR)	7
1	690468-1	DEPRESSOR, SHEAR (REAR)	6
1	690468-1	DEPRESSOR, SHEAR (FRONT)	5
1	690468-1	SPACER, TUBULAR, INS CRIMPER	4
1	690468-1	CRIMPER, INSULATION	3
1	690468-1	SPACER, CRIMPER	2
1	690468-1	CRIMPER, WIRE	1

REMARKS	NO	REV
APPL USED ON MACHINE PART NO	MACH SERIAL NO	TO APPLY TERMINAL
CUSTOMER NAME	APPL SERIAL NO	DISTRIBUTION
ADDRESS	PURCHASE ORDER	ORIGINAL
CITY	ENG APP	CUSTOMER COPY
		FIELD ENG COPY

CRIMPING DATA				APPLICATOR WILL APPLY	
PAD LTR	CRIMP HEIGHT	WIRE SIZE	WIRE STRIP LENGTH	63202	
A	.061	14		1217571-1	
B	.055	(2) 18			
C	.051	16			
D	.044	18			
CRIMP	SIZE	TYPE	FEED	APPL INST	
WIRE	.110	F	.220	A1 8040	
INSUL					
WIRE RANGE	14-18	INSULATION RANGE	PRESS NO	565435-5	
REMARKS	PRE-FEED AMP-O-LECTRIC AIR FEED DUAL (OVERLAP STRIP)				
	ASSY PRINT (468288-1) MUST ACCOMPANY LOG SHEET.				
	(REF) I.D. PLATE 461264-1				

SET UP GAGE 10-1  
N 973

DI ECN 0150-0938-01  
D ECN 0150-0938-01  
C 0150-776-97  
B EC 0150 4924 93

DR 1-82 APP  
ERISMAN  
CHK 5-82  
REL 5-82

LOG A D NO 567100-2

AMP INCORPORATED  
Harrisburg, Pa

MINIATURE QUICK CHANGE APPLICATOR  
SIDE FEED (.110 SERIES FASTON RECEPT)

REVISION RECORD