

MATERIAL:

BACKSHELL: NICKEL PLATED DIE-CAST ZINC ALLOY
 HARDWARE: NICKEL PLATED STEEL

BACKSHELL KIT INCLUDES:

- (2x) BACKSHELL HALVES
- (2x) HOUSING SCREWS
- (2x) HOUSING NUTS
- (2x) STRAIN RELIEF CLAMPS
- (2x) STRAIN RELIEF SCREWS

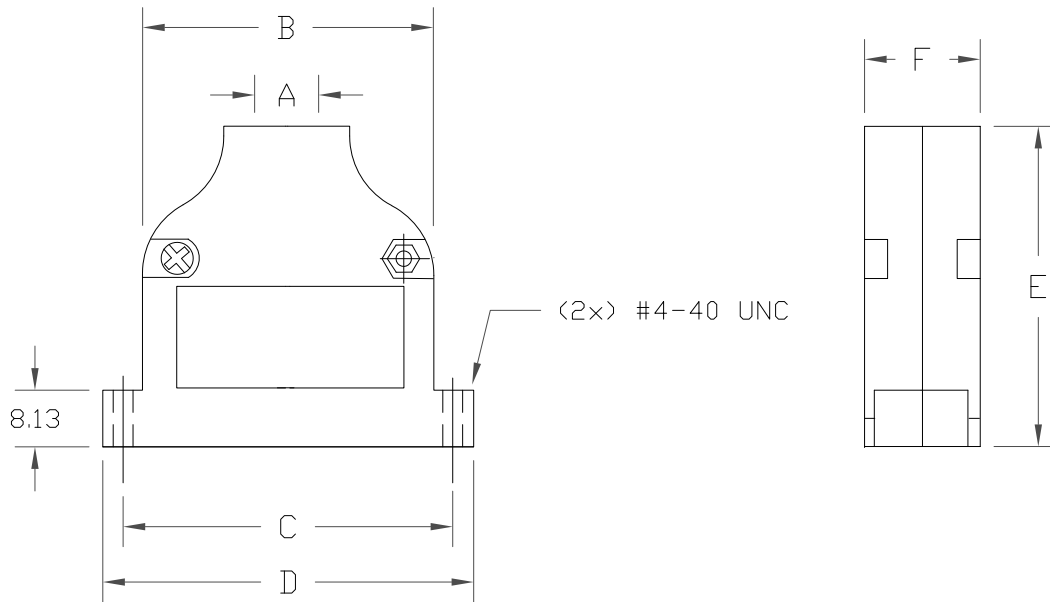

DIMENSIONS(mm) [All tolerances ±0.5m]						
SIZE	A	B	C	D	E	F
9	11.00	20.07	24.99	31.80	46.00	16.00
15	11.00	28.83	33.32	40.00	46.00	16.90
25	11.00	41.66	47.04	53.50	46.00	16.10

994-YYY-030R121

SERIES _____
 POSITIONS _____
 009
 015
 025

RoHS COMPLIANT

UNITS = mm

DO NOT SCALE FROM DRAWING



THESE DRAWINGS AND SPECIFICATIONS ARE THE PROPERTY OF NorComp AND SHALL NOT BE REPRODUCED, COPIED OR USED AS THE BASIS FOR THE MANUFACTURE OR SALE OF APPARATUS WITHOUT WRITTEN PERMISSION.

DRAWN:
P. JENKINS

DATE:
 09/15/2005

NorComp

SCALE:
 NTS

SHEET OF
 1 1

REV
 4

DWG NO.

994-0YY-030R121