

FEMALE FACE VIEW	
3-POLE	4-POLE
1 BROWN 3 BLUE 4 BLACK	1 BROWN 2 WHITE 3 BLUE 4 BLACK

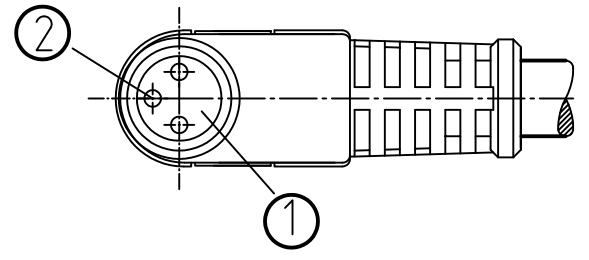

POLE	MATERIAL NUMBER	ENGINEERING NUMBER	FINISHED LENGTH IN/MM
3	1200885008	503001E03M020	6.56' +3.50" -0 [2.0M +88.9 -0]
3	1200290015	503001E03M050	16.40' +6.50" -0 [5.0M +165.1 -0]
4	1200888034	504001E03M100	32.81' +12.50" -0 [10.0M +317.5 -0]

CONNECTOR SPECIFICATION:	
VOLTAGE RATING	3-4POL:60V/AC 75V/DC
AMPERAGE RATING	3 AMPS
PROTECTION	IP65
OPERATING TEMPERATURE	-30°C TO +80°C (STATIC)
UL CERTIFICATIONS	UL listed, File #E152210
CSA CERTIFICATIONS	CSA CERTIFIED, File LR6837

ITEM	COMPONENT	MATERIAL	FINISH
1	INSERT	POLYURETHANE (PUR)	BLACK
2	CONTACT SOCKET	COPPER ALLOY	GOLD OVER NICKEL
3	OVERMOLD	PVC	YELLOW
4	CABLE 0.25mm ² (24AWG) (COPPER STRANDING) 3/4 CONDUCT. 300V	JACKET: PVC	BLACK

DESCRIPTION EC NO.: WEU2010-0305 DRWN: REISSNER 2010/01/27 CH'KD: FP APPR: NSTAUDIG 2010/02/01 REV 1	QUALITY SYMBOLS ▽ = 0 ▽/C = 0	GENERAL TOLERANCES (UNLESS SPECIFIED) mm INCH 4 PLACES ±--- ±--- 3 PLACES ±--- ±--- 2 PLACES ±--- ±.01 1 PLACE ±0.3 ±--- ANGULAR ± --- °	DIMENSION STYLE IN/MM DRAWN BY DATE REISSNER 2010/01/27 CHECKED BY DATE FP 2010/01/27 APPROVED BY DATE NSTAUDIG 2010/02/01 MATERIAL NO. SEE TABLE	SCALE 2:1 DESIGN UNITS METRIC THIRD ANGLE PROJECTION
	DRAFT WHERE APPLICABLE MUST REMAIN WITHIN DIMENSIONS		SIZE A3	THIS DRAWING CONTAINS INFORMATION THAT IS PROPRIETARY TO MOLEX INCORPORATED AND SHOULD NOT BE USED WITHOUT WRITTEN PERMISSION
	NC 3/4P FE 90 SNAP 24AWG PVC		MOLEX INCORPORATED DOCUMENT NO. SD-120088-011 SHEET NO. 1	
	THIS DRAWING CONTAINS INFORMATION THAT IS PROPRIETARY TO MOLEX INCORPORATED AND SHOULD NOT BE USED WITHOUT WRITTEN PERMISSION			