

Subminiature Fuse, 4.05 x 10 mm, Quick-Acting F, 250 VAC, 125 VDC



UL 248-14 · 250 VAC · 125 VDC · Quick-Acting F

See below:
[Approvals and Compliances](#)

Description

- Low Breaking Capacity

References

Last order date: 30.04.2021
 We recommend for new applications [SPT 3.6x10](#)

Weblinks

[pdf data sheet](#), [html datasheet](#), [General Product Information](#), [Distributor-Stock-Check](#), [Detailed request for product](#)

Technical Data

Rated Voltage	125 - 250 VAC, 125 VDC	Soldering Methods	Wave Soldering Profile
Rated current	0.05 - 5 A	Solderability	235 °C / 2 sec acc. to IEC 60068-2-20, Test Ta, method 1
Breaking Capacity	50 A - 300 A	Resistance to Soldering Heat	260 °C / 5 sec acc. to IEC 60068-2-20, Test Tb, method 1A
Characteristic	Quick-Acting F		
Admissible Ambient Air Temp.	-40 °C to 85 °C		
Material: Tube	Ceramics		
Material: Axial Leads	Tin-Plated Copper		
Unit Weight	0.6 g		
Storage Conditions	0 °C to 60 °C, max. 70% r.h.		
Product Marking	, Rated current, Characteristic		

Approvals and Compliances

Detailed information on product approvals, code requirements, usage instructions and detailed test conditions can be looked up in [Details about Approvals](#)

SCHURTER products are designed for use in industrial environments. They have approvals from independent testing bodies according to national and international standards. Products with specific characteristics and requirements such as required in the automotive sector according to IATF 16949, medical technology according to ISO 13485 or in the aerospace industry can be offered exclusively with customer-specific, individual agreements by SCHURTER.

Approvals

The approval mark is used by the testing authorities to certify compliance with the safety requirements placed on electronic products.

Approval Reference Type: 172593

Approval Logo	Certificates	Certification Body	Description
	UL Approvals	UL	UL File Number: E42088

Product standards

Product standards that are referenced

Organization	Design	Standard	Description
	Designed according to	UL 248-14	Low voltage fuses - Part 14: Additional fuses
	Designed according to	CSA22.2 No. 248.14	Low-Voltage Fuses - Part 14: Supplemental Fuses





Application standards

Application standards where the product can be used

Organization	Design	Standard	Description
	Designed for applications acc.	IEC/UL 62368-1	IEC 62368-1 includes the basic requirements for safety of audio, video, information technology and office equipment.

Compliances

The product complies with following Guide Lines

Identification	Details	Initiator	Description
	CE declaration of conformity	SCHURTER AG	The CE marking declares that the product complies with the applicable requirements laid down in the harmonisation of Community legislation on its affixing in accordance with EU Regulation 765/2008.
	RoHS	SCHURTER AG	Directive RoHS 2011/65/EU, Amendment (EU) 2015/863
	China RoHS	SCHURTER AG	The law SJ / T 11363-2006 (China RoHS) has been in force since 1 March 2007. It is similar to the EU directive RoHS.
	REACH	SCHURTER AG	On 1 June 2007, Regulation (EC) No 1907/2006 on the Registration, Evaluation, Authorization and Restriction of Chemicals 1 (abbreviated as "REACH") entered into force.

Dimension [mm]

10 mm

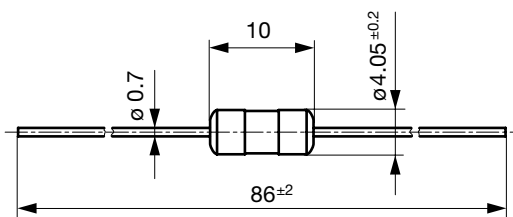

Pre-Arcing Time

Rated Current I _n	1.0 x I _n min.	2.0 x I _n max.	3.0 x I _n max.
0.05 A - 5 A	4 h	60 s	100 ms

Time-Current-Curves

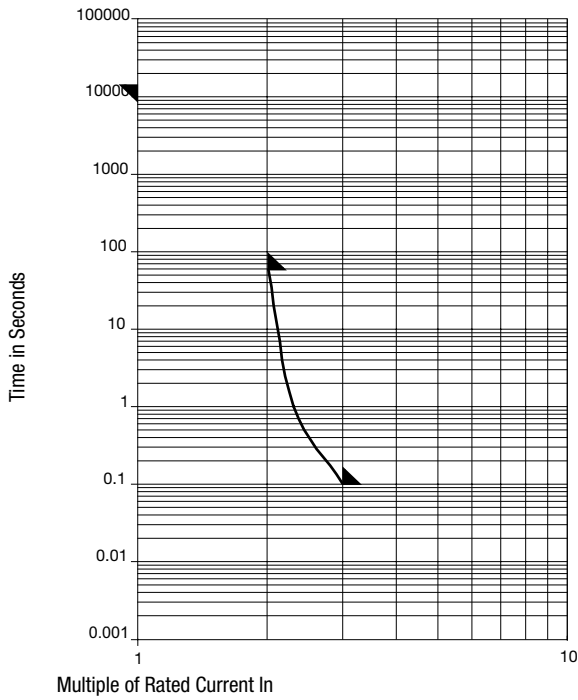

All Variants

Rated Current [A]	Rated Voltage [VAC]	Rated Voltage [VDC]	Breaking Capacity	Voltage Drop 1.0 I _n typ. [mV]	Melting I ² 10.0 I _n typ. [A ² s]	Order Number
0.05	250	125	1)	1150	0.00011	● 7010.1740.46
0.063	250	125	1)	735	0.00035	● 7010.1750.46
0.08	250	125	1)	950	0.00039	● 7010.1760.12
0.1	250	125	1)	875	0.00079	● 7010.1770.12
0.1	250	125	1)	875	0.00079	● 7010.1770.46
0.125	250	125	1)	870	0.0013	● 7010.1780.12
0.125	250	125	1)	870	0.0013	● 7010.1780.46
0.15	250	125	1)	545	0.0029	● 7010.1790.12
0.15	250	125	1)	545	0.0029	● 7010.1790.46
0.2	250	125	1)	520	0.0071	● 7010.1910.12
0.2	250	125	1)	520	0.0071	● 7010.1910.46
0.3	250	125	1)	920	0.021	● 7010.1920.12
0.3	250	125	1)	920	0.021	● 7010.1920.46
0.4	250	125	1)	725	0.057	● 7010.1930.12
0.4	250	125	1)	725	0.057	● 7010.1930.46
0.5	250	125	1)	725	0.069	● 7010.1800.46
0.6	250	125	1)	205	0.059	● 7010.1810.12
0.6	250	125	1)	205	0.059	● 7010.1810.46
0.8	250	125	1)	150	0.095	● 7010.1820.12
0.8	250	125	1)	150	0.095	● 7010.1820.46
1	250	125	1)	185	0.12	● 7010.1830.46
1.25	250	125	1)	125	0.29	● 7010.1840.12
1.25	250	125	1)	125	0.29	● 7010.1840.46
1.6	250	125	1)	135	0.48	● 7010.1850.12
1.6	250	125	1)	135	0.48	● 7010.1850.46
2	250	125	1)	110	0.95	● 7010.1860.12
2	250	125	1)	110	0.95	● 7010.1860.46
2.5	250	125	1)	145	1.2	● 7010.1870.12

Rated Current [A]	Rated Voltage [VAC]	Rated Voltage [VDC]	Breaking Capacity	Voltage Drop 1.0 I _n typ. [mV]	Melting I ² t 10.0 I _n typ. [A ² s]	Order Number
2.5	250	125	1)	145	1.2 ●	7010.1870.46
3	250	125	1)	220	1.8 ●	7010.1880.12
3	250	125	1)	220	1.8 ●	7010.1880.46
4	250	125	1)	130	3.4 ●	7010.1890.12
4	250	125	1)	130	3.4 ●	7010.1890.46
5	250	125	1)	105	7.7 ●	7010.1900.12
5	250	125	1)	105	7.7 ●	7010.1900.46

Availability for all products can be searched real-time: <https://www.schurter.com/en/Stock-Check/Stock-Check-SCHURTER>

1) 50 A @ 250 VAC/DC / 300 A @ 125 VAC/DC

Packaging Unit

.xx = .12 Plastic Bag (50 pcs.)

.xx = .46 Taped 19 cm Reel (1000 pcs.)

PHASE-OUT