

REVISION Z

DO NOT SCALE FROM THIS PRINT

|                          |                             |                        |                 |
|--------------------------|-----------------------------|------------------------|-----------------|
| DIMENSIONS ARE IN INCHES |                             | UNLESS OTHERWISE NOTED | TOLERANCES ARE: |
| ONE PLACE DECIMALS ±.1   | THREE PLACE DECIMALS ± .005 | ANGLES ± 2°            |                 |
| TWO PLACE DECIMALS ±.01  | FOUR PLACE DECIMALS ± .0020 |                        |                 |

TITLE: ZSS-ASSEMBLY

DWG NO: ZSS-1XX-XX-XXX-X-XXXX-XX-XX  
SHEET 1 OF 1

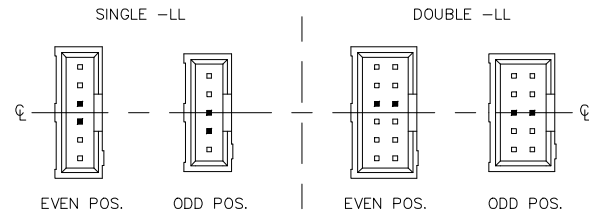
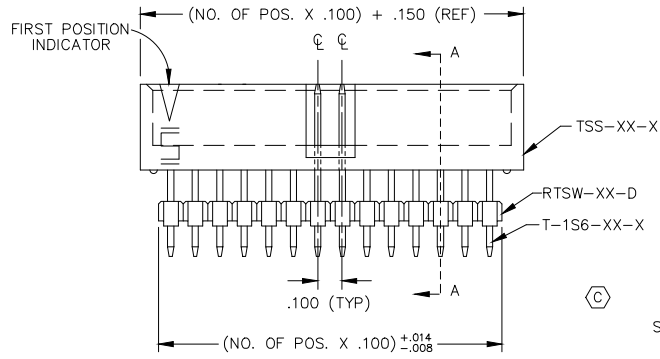
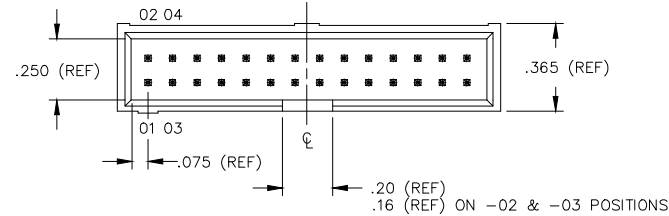
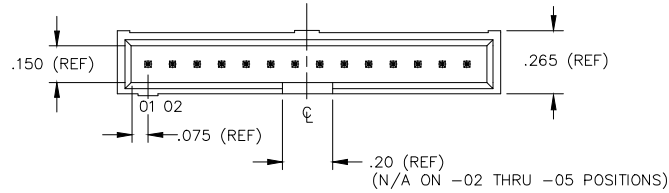

ZSS-1XX-XX-XXX-X-XXXX-XX-XX

- NO. OF POSITIONS (02 THRU 18, 20, 24, 22, 25, 28, 30, 32, 36)
- LEAD STYLE SEE TABLE 1
- PLATING OPTION
  - G: 10μ" GOLD IN CONTACT AREA, 3μ" GOLD ON TAIL
  - T: MATTE TIN CONTACT AND TAIL
  - S: 30μ" SELECTIVE GOLD IN CONTACT AREA, MATTE TIN ON TAIL
  - H: 30μ" GOLD IN CONTACT AREA, 3μ" GOLD ON TAIL
  - L: 10μ" SELECTIVE GOLD IN CONTACT AREA, MATTE TIN ON TAIL
  - F: 3μ" SELECTIVE GOLD IN CONTACT AREA, MATTE TIN ON TAIL
  - STL: 30μ" SELECTIVE GOLD IN CONTACT AREA, (90/10 +/-5%) TAIL (ONLY AVAILABLE IN -06 LEAD STYLE)
- POLARIZED OPTION SPECIFY POSITION TO BE REMOVED (XX)
- OPTION
  - LL: LOCKING LEAD (SEE SECT. 'A-A' & FIG. 1)
- STACKING HEIGHT
  - .450 MIN. STACKING HEIGHT (.535 MIN. BOARD SPACING WHEN MATED WITH SAMTEC SSW)
- ROW OPTION
  - D DOUBLE
  - S SINGLE

TABLE 1

| LEAD STYLE | TERMINAL      | MAX. STACKING HEIGHT | "A"   |
|------------|---------------|----------------------|-------|
| -01        | T-1S6-15-XX-2 | .540                 | .630  |
| -02        | T-1S6-09-XX-2 | .640                 | .730  |
| -03        | T-1S6-10-XX-2 | .740                 | .830  |
| -04        | T-1S6-11-XX-2 | .840                 | .930  |
| -05        | T-1S6-12-XX-2 | .940                 | 1.030 |
| -06        | T-1S6-20-XX-2 | 1.040                | 1.130 |
| -07        | T-1S6-13-XX-2 | 1.140                | 1.230 |
| -08        | T-1S6-19-XX-2 | 1.240                | 1.330 |
| -09        | T-1S6-14-XX-2 | 1.340                | 1.430 |

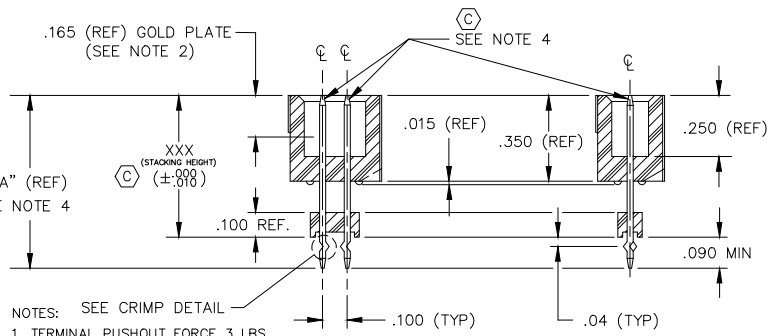
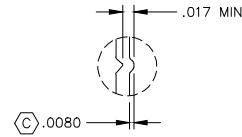

- NOTES: SEE CRIMP DETAIL
- TERMINAL PUSHOUT FORCE 3 LBS.
  - ASSEMBLE GOLD PLATE END AS SHOWN.
  - ( ) REPRESENTS CRITICAL DIMENSION FOR STATISTICAL PROCESS CONTROL.
  - TERMINALS TO BE FLUSH TO .010 BELOW TOP OF SHROUD.
  - INSULATOR MATERIALS: PBT, UL 94 V0
  - FOR ADDED MECHANICAL STABILITY, SAMTEC RECOMMENDS MECHANICAL BOARD SPACERS BE USED IN APPLICATIONS WITH GOLD OR SELECTIVE GOLD PLATED CONNECTORS. CONTACT IPG@SAMTEC.COM FOR MORE INFORMATION.
  - MAX ALLOWABLE CUT FLASH .020.
  - PARTS TO BE PACKAGED IN LAYER.

**PROPRIETARY NOTE**  
THIS DOCUMENT CONTAINS INFORMATION CONFIDENTIAL AND PROPRIETARY TO SAMTEC, INC. AND SHALL NOT BE REPRODUCED OR TRANSMITTED IN ANY FORM OR BY ANY MEANS, ELECTRONIC OR MECHANICAL, INCLUDING PHOTOCOPYING, RECORDING, OR BY ANY INFORMATION STORAGE AND RETRIEVAL SYSTEM, WITHOUT THE EXPRESS WRITTEN CONSENT OF SAMTEC, INC.

EXISPROD\ASSEMBLY\100 ZSS-ASM

520 PARK EAST BLVD. NEW ALBANY, INDIANA 47150  
PHONE (812) 944-6733 P.O. BOX 1147  
CODE 55322

MADE BY: TIM PLUMMER

ZSS-1XX-XX-XXX-X-XXXX-XX-XX  
SHEET 1 OF 1