

10 9 8 7 6 5 4 3 2 1

F

E

D

C

B

A

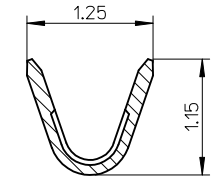
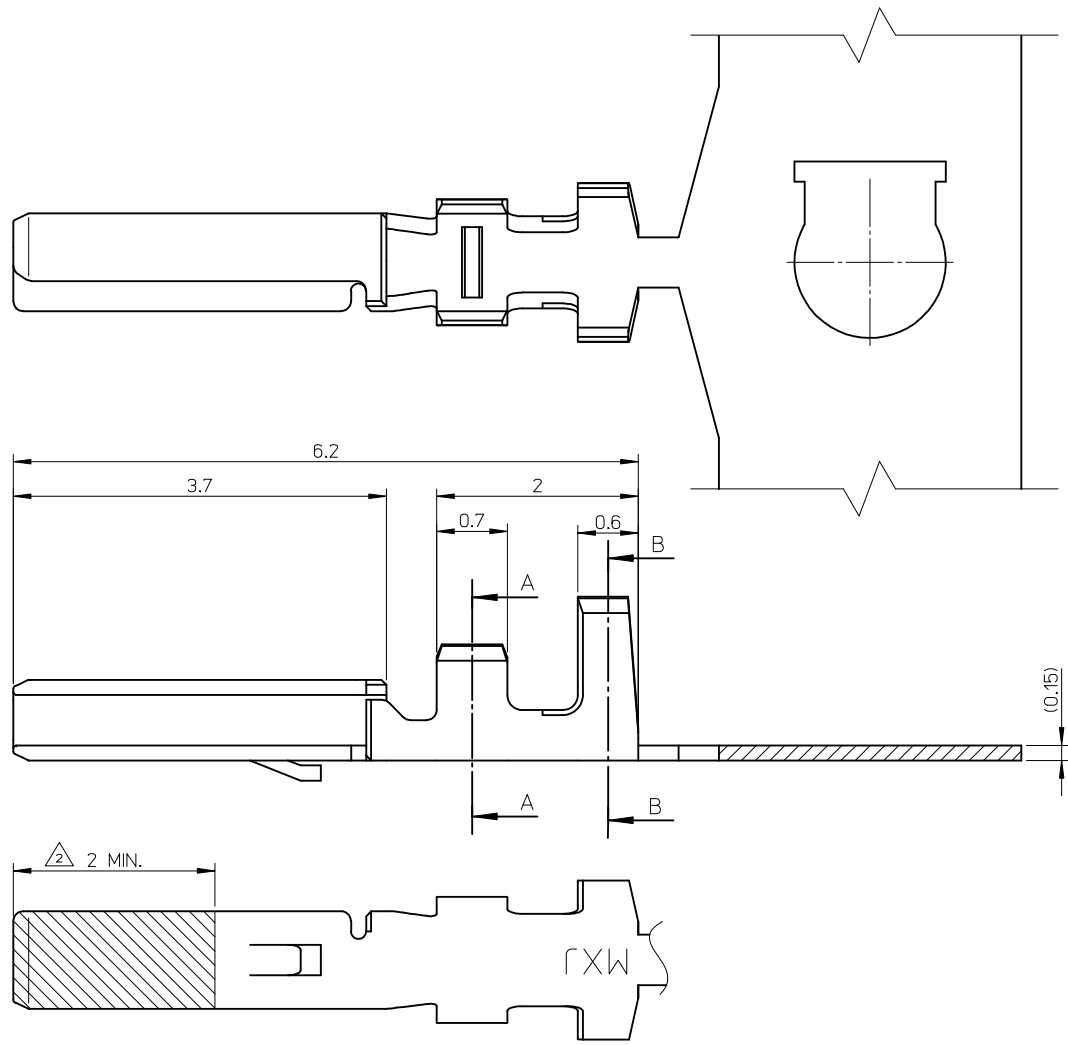

SECTION A-A

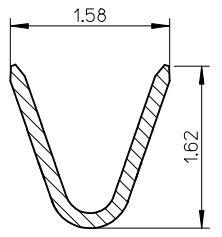

SECTION B-B

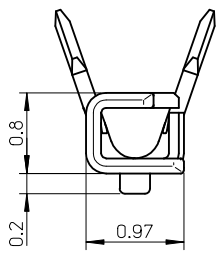

NOTES

- 適合ハウジング: 501929-*****, 503110-*****. APPLICABLE HOUSING: 501929-*****, 503110-*****.
- 図示の斜線部の範囲は、接点部のため、傷、打痕、汚れなどを付けないようにして下さい。PLEASE DON'T DAMAGE, DON'T DENT, AND DON'T MAKE IT DIRTY. BECAUSE THE RANGE IN THE SHADED PORTION SHOWN IN FIGURE IS THE CONTACT AREA.
- ELV 及び RoHS 適合品
ELV AND RoHS COMPLIANT

φ0.8-1.0mm	AWG#26-28	501930-1100	連鎖状 CHAIN
絶縁被覆外径範囲 INS. RANGE	適用電線範囲 WIRE RANGE	製品番号 MATERIAL NO.	端子形状 FORM

部品 PART	材質 MATERIAL
ターミナル TERMINAL	銅合金 COPPER ALLOY
	金めっき(接点部): 0.1 micro-meter MIN. GOLD (CONTACT AREA)
	錫めっき(圧着部): 0.5 micro-meter MIN. TIN (TAIL AREA)
	ニッケルめっき(下地): 1.0 micro-meter MIN. NICKEL (UNDER PLATING)

REVISED EC NO: J2009-0621 DRW:KSETO 2008/09/09 CHKD:SMARUYAMA 2008/09/09 APPR:S.ICHIKAWA 2008/09/09	DESCRIPTION	GENERAL TOLERANCES (UNLESS SPECIFIED)	DIMENSION STYLE
	REV	10 UNDER ±0.2	MM ONLY
		10 OVER 30 UNDER ±0.25	DRAWN BY DATE
		30 OVER ±0.3	T. MIYAZAKI 2006/03/13
	ANGULAR ±3 °	CHECKED BY DATE	TITLE
	DRAFT WHERE APPLICABLE MUST REMAIN WITHIN DIMENSIONS	S. ICHIKAWA 2006/03/13	1.25 W/B CONN. DUAL PLUG TERMINAL
		MATERIAL NO.	MOLEX INCORPORATED
		SIZE	SD-501930-001
		A3	1 OF 1

SCALE	DESIGN UNITS	THIRD ANGLE PROJECTION
20:1	METRIC	☉ □
THIS DRAWING CONTAINS INFORMATION THAT IS PROPRIETARY TO MOLEX INCORPORATED AND SHOULD NOT BE USED WITHOUT WRITTEN PERMISSION		