

order number	lens name
0703-109-000-20	Apo-Rodagon HR 0.5x 5.6/75
0703-109-000-21	Apo-Rodagon HR 0.5x 8.0/75

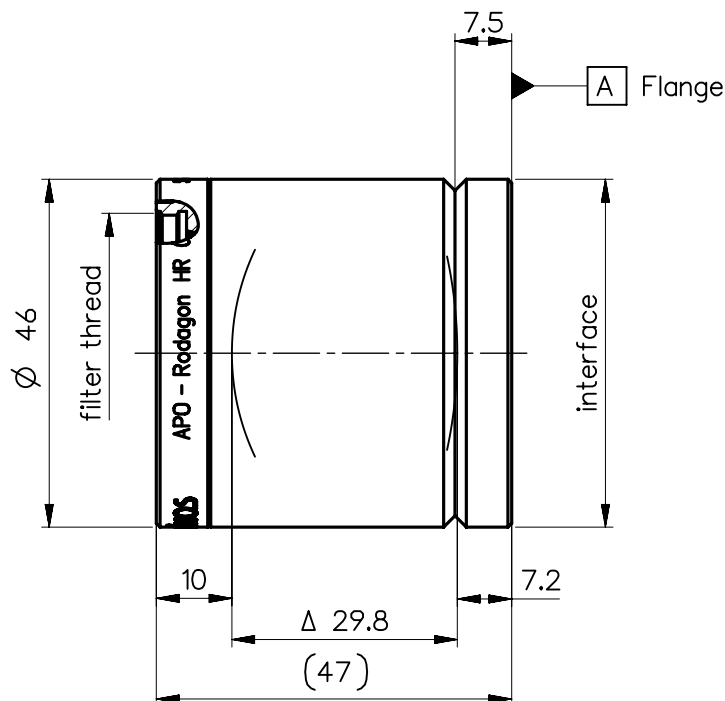

<b>Specification</b>		ON	7608-9111
image circle max. (mm)	62	working distance (mm)	172 - 273
focal length f' (mm)	76.9	interface	V-groove $\varnothing$ 46 h7
magnification $\beta'$ [range]	-0.5 [-0.35 ... -0.65]	filter thread	M37 x0.75
spectral range $\lambda$ (nm)	400 - 750	weight (g)	195

		design includes CCD cover glass: no		
SF (mm)	-64.1	f-stop	$\varnothing$ EnP	$\varnothing$ Exp
S'F' (mm) *	61.8	5.6	13.7	13.7
HH' (mm) *	1.8	8.0	9.6	9.7
SH (mm)	12.8			
S'H' (mm) *	-15.1			
SEnP (mm)	12.2			
S'Exp (mm) *	-15.8			

<b>NX</b> PROTECTIVE NOTE "DIN ISO 16016" TO BE OBSERVED	EU-D	AL-T1A	US-D	US-ML	not export controlled	
	REV	ECC	DATE	APPROVED	PDM Status	
	a	Neuausg			Freigabe	-
	b	14-0184	13.11.14	Schiffe	SCALE	1:1
c	18-0468	09.07.18	Denk	MATERIAL		
				BASIC TOLERANCING PRINCIPLE	TITLE	
				ISO 8015	<b>APO-Rodagon HR 0.5x</b>	
				FIRST ISSUE	06.05.10	
				NAME	Labarte	
				CHKD	06.05.10 Schaeffler	
<b>DIN A 4</b>	ALL DIMENSIONS ARE IN MM AND INCLUDE SURFACE TREATMENT					
				DRAWING NO.	0703-109-100-00-0001c	
				REPLACES		
				SHEET	1	
				OF	1	

# Apo-Rodagon

MTF at ratio 0.5x f/ 5.6

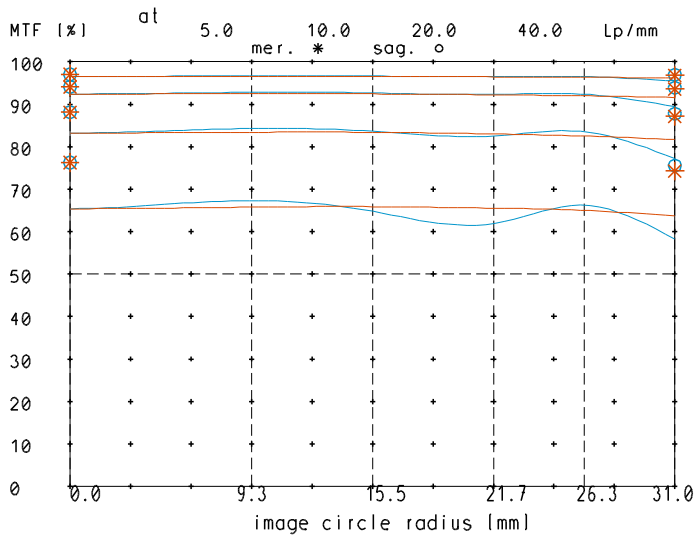

relative light fall-off at ratio 0.5x

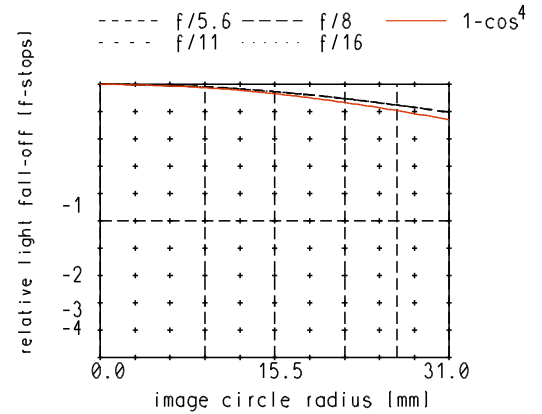

MTF at ratio 0.5x f/ 8

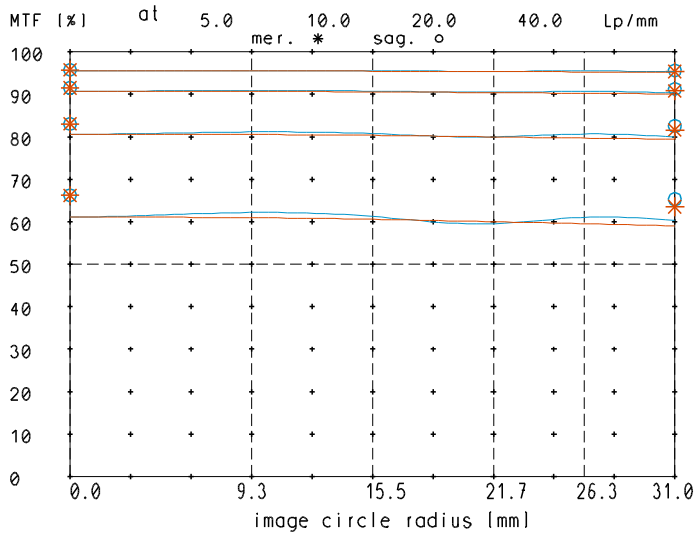

Distortion at ratio 0.35x to 0.65x

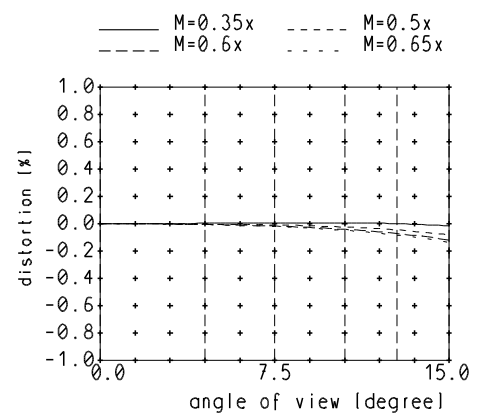

Longitudinal color aberration at ratio 0.5x

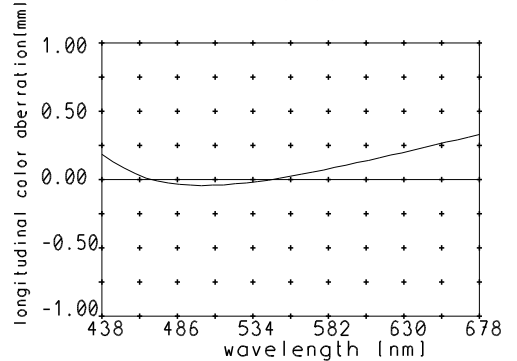

— sagittal, o Diffraction limited value  
 — meridional \* Diffraction limited value

Named frequencies (line pairs/mm) in modular transfer function (MTF) as well as diagrams of relative light fall-off, distortion and longitudinal color aberration refer to film plane.